

PORTABLE KEROSENE-HEATER “OWNER’S MANUAL”

Dyna-Glo®

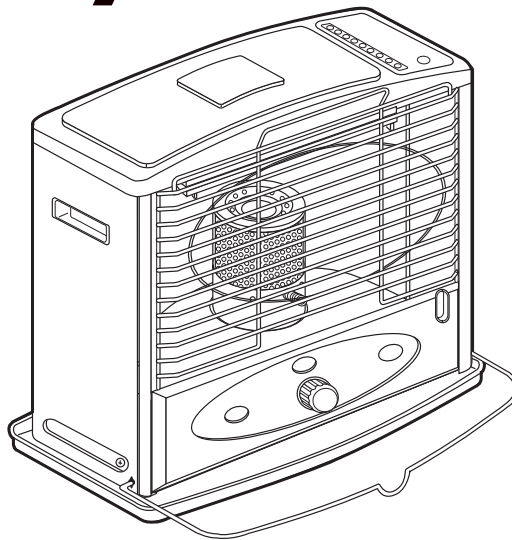

MODEL : RMC- 55R7 / RMC- 55R7B

Before the first use of this heater, please read this OWNER'S MANUAL very carefully. This OWNER'S MANUAL has been designed to instruct you as to the proper manner in which to assemble the heater maintain the heater, store the heater, and most importantly, how to operate the heater in a safe and efficient manner. Please keep this manual for future reference.

**GHP Group, Inc.,
Morton Grove, IL 60053-3207, USA
TELEPHONE : 1-877-447-4768**

4221-0005-11
05/08 Rev. 04

CAUTIONS

- SAFETY GUIDE -

⚠ WARNING!! RISK OF EXPLOSION / RISK OF FIRE

- ▮ **NEVER** use any fuel other than water-clear 1-K kerosene or red dyed 1-K kerosene.
- ▮ **NEVER** use fuel such as gasoline, benzene, paint thinners or other oil compounds in this heater.
- ▮ **NEVER** refill heater fuel tank when heater is operating or still hot.
- ▮ **NEVER** use heater in areas where flammable vapors or gases may be present.
- ▮ **NEVER** fill heater fuel tank in living space; fill tank outdoors.
- ▮ **NEVER** store or transport kerosene in other than a metal or plastic container that is (1) acceptable for kerosene, (2) non-red in color, and (3) clearly marked 'Kerosene.' **NEVER** store kerosene in the living space; kerosene should be stored in a well ventilated place outside the living area.
- ▮ The unit is **EXTREMELY HOT** while in operation. Due to high surface temperatures, keep children, clothing, furniture, and other combustible objects at least 36" away from top and front area.

▮ RISK OF INDOOR AIR POLLUTION

USE HEATER ONLY IN WELL VENTILATED AREAS. People with breathing problems should consult a physician before using the heater. In a house of typical construction, that is, one that is not of unusually tight construction due to heavy insulation and tight seals against air infiltration, an adequate supply of air for combustion and ventilation is provided through infiltration; however, if the heater is used in a small room where less than 200 cubic feet (5.7 m³) of air space is provided for each 1,000 BTU per hour of heater rating (considering the maximum burner adjustment), the door(s) to adjacent room(s) should be kept open or the window to the outside should be opened at least 1 inch (25.4 mm) to guard against potential buildup of indoor air pollution. DO NOT use the heater in a bathroom or any other small room with the door closed.

- ▮ **NEVER** use heater to cook or boil water. **NEVER** not use as a cooking appliance.
- ▮ **NEVER** use gasoline in this heater. (RISK OF FIRE)
- ▮ **NEVER** remove the cartridge tank when the heater is operating or when the heater is hot. **NEVER** use the cartridge tank to transport or store kerosene or any other flammable liquids.

Occasionally during normal operation you will hear the sound of fuel draining from the cartridge tank

to fill the fuel reservoir area. This is normal for a cartridge tank kerosene heater.

⚠ WARNING!! FAILURE TO INSTALL, MAINTAIN, AND/OR OPERATE THIS KEROSENE HEATER ACCORDING TO MANUFACTURER'S INSTRUCTIONS MAY RESULT IN CONDITIONS WHICH CAN PRODUCE BODILY INJURY AND/OR PROPERTY DAMAGE.

NOTE: The **WARNING** and **IMPORTANT** instructions appearing in this manual are not meant to cover all possible conditions and situations that may occur. It must be understood that common sense, caution, and care are factors which cannot be built into this heater. These factors must be supplied by the person(s) installing maintaining, or operating the kerosene heater.

Always contact your dealer, distributor, service agent, or the manufacturer on any problems or conditions you do not understand.

- ▮ **NEVER** leave heater operating if you intend to leave the room for any period of time. Always make sure to turn the heater off and inspect it to insure that it is completely extinguished prior to going to bed.
- ▮ **NEVER** leave heater unattended.
- ▮ **NEVER** use as a source of heat for drying objects.
- ▮ **NEVER** place objects on the top plate.

⚠ WARNING!! RISK OF BURNS

- ▮ **NEVER** operate the heater without the guard or grille completely attached.

⚠ IF POOR QUALITY KEROSENE is used a rapid accumulation of carbon and tar is likely. This may cause a strong odor and will destroy the wick. Additional heater damage may occur as the wick becomes more difficult to adjust. The use of poor quality fuel could also make the wick very hard to extinguish. Always make sure the fire is out. (See page 7, Extinguishing the Heater.)

⚠ ADJUSTMENT OF ROOM TEMPERATURE can not be changed by adjusting the heater. A kerosene heater is either on or off. There is no temperature adjustment. If heater output is reduced by lowering the wick in any way, improper combustion will occur producing odors and an accumulation of tar and carbon. If your room becomes too hot, open a door or a window or turn off the heater.

SAVE THESE INSTRUCTIONS FOR FUTURE REFERENCE!!

ITEM	PAGE	ITEM	PAGE
CAUTIONS-SAFETY GUIDE	1	11 WICK REPLACEMENT	10~12
1 INTRODUCTION	2	12 CHECKING THE IGNITION SYSTEM	13
2 FEATURES	2	13 WICK ADJUSTER MECHANISM	13
3 KEROSENE (1-K ONLY)	3	14 AUTOMATIC SAFETY SHUT-OFF DEVICE	13
4 UNPACKING AND ASSEMBLING THE HEATER	4	15 LONG TERM STORAGE OF YOUR HEATER	14
5 FUELING YOUR HEATER	5	16 SPECIAL SAFETY PRECAUTIONS	15
6 AUTOMATIC IGNITION SYSTEM	6	17 TROUBLE SHOOTING GUIDE	16
7 ADJUSTING THE WICK	7	18 PARTS LIST	17
8 EXTINGUISHING THE HEATER	7	19 EXPLODED PARTS DRAWING	17
9 WICK MAINTENANCE	9	20 SPECIFICATIONS	17
10 CARBON REMOVAL / DRY BURNING	9		

1] INTRODUCTION

Please read this OWNER'S MANUAL carefully. It will show you how to assemble, maintain, and operate the heater safely and efficiently to obtain full benefit from its many built-in features.

2) FEATURES

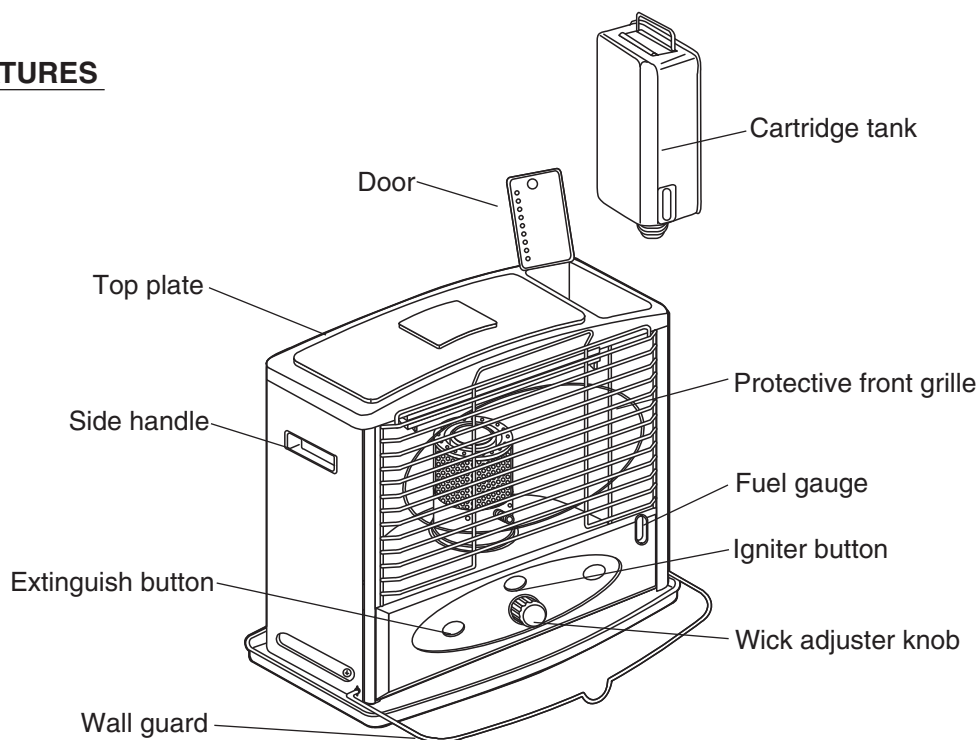

Fig. 1

- ~~ÁQ | Á^ | æ{ ^ } ó æ o & [} æ d o n n e] æ o i o ~ á { ^ } ó æ á / O E & • • [| á • Q & -877-475-5660 , Éæ] æ o á & È {~~

AUTOMATIC IGNITION SYSTEM

For safety and convenience, this heater features an automatic ignition system.

2 "D" cell batteries, included with the heater, provide the power for the igniter which lights the wick once it has been raised to its maximum height.

When the heater is fueled for the first time, allow a **minimum of 60 minutes** after filling the heater for the wick to absorb kerosene before you attempt to light the heater. Also, the first time you light the heater, it should be done **outdoors** to allow the oils, etc, used in manufacturing the heater to burn off outside, rather than in your home.

To use the automatic Ignition system:

- Make sure the batteries have been installed properly.
- Turn the wick adjuster knob clockwise until the wick has been raised to its maximum height.
- Push the ignition button to bring the glowing igniter into contact with the wick. This will cause ignition to occur.
- As soon as you see that the wick has been lit, release the ignition button. This will automatically lower the burn chamber back down over the wick.
- Rotate the burner knob from side to side a few times to make sure that the burner is positioned properly on the wick adjuster.
- Then begin following the steps outlined in "Adjusting the wick" (page. 7)

IGNITION VIA MATCH

If you encounter a problem with the ignition mechanism, or if you have dead batteries, it is possible to light the heater with a match (Fig. 7).

The procedure is as follows:

- Turn the wick adjuster knob clockwise until the wick has been raised to its maximum height.
- Lift the burn chamber by using the burner knob.
- Touch a lighted match to the exposed top edge of the wick.
- Once you see that the wick has been lit, lower the burn chamber back down over the wick.
- Rotate the burner knob from side to side a few times to make sure that the burner is positioned properly on the wick adjuster.
- Then begin following the steps outlined in "Adjusting the wick" (page. 7)

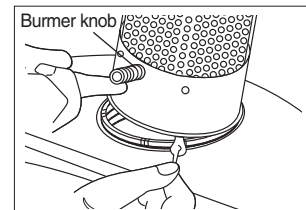

Fig. 7

CAUTION : Make sure that you do not leave the match, or any portion of it (match head, etc.) in the burner area. Debris left from the match can cause an uneven alignment of the burner and may result in smoke, incomplete combustion, odor, or fire.

NOTE : Once you have extinguished the heater, wait at least 10 minutes before reigniting the wick. Failure to do this will result in a very strong odor and / or smoke being produced.

NOTE : Do not use excessive force when pushing the ignition button. This can cause the igniter to catch the wick and may prevent ignition from occurring. Pushing too lightly on the Ignition button can prevent ignition from occurring by keeping the igniter too far from the wick. As Fig. 10 (Page 9) shows, the optimal distance between the igniter and the wick is 1/64- 1/32 inch (0.5 to 1mm). If it is difficult to ignite the heater, the filament on the igniter might be bent, broken or misshaped.

NOTE : Carbon build-up on the wick may prevent the wick from completely lowering when the extinguish button is pushed. This can result in the flame not extinguishing. If this happens, continue to push the extinguish button and turn the wick adjuster knob in a counterclockwise direction (towards **“OFF”**) as far as it will go. If this condition exists, inspect the heater and perform the checks and maintenances described on page 9.

NOTE: If the heater is jarred or shaken, the automatic safety shut-off device may automatically function.

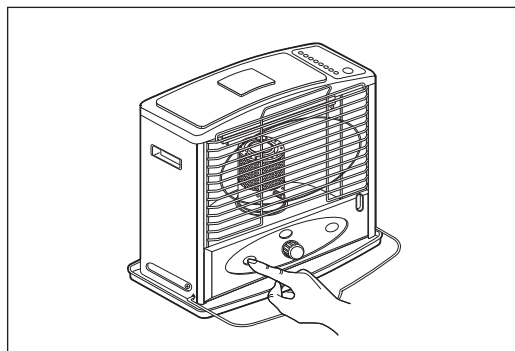

Fig.9

CAUTION: NEVER adjust or attempt to disassemble the automatic safety shut-off extinguishing device.

This can cause the automatic safety shut-off extinguishing device to not function properly in the case of an emergency.

CAUTION : After extinguishing the heater, **allow at least 10 minutes before reigniting the heater.** This allows the heater time to cool off and return to a normal temperature. Failure to allow the 10 minute cooling off period before reigniting the heater will result in the creation of a strong odor and possible flare-up.

WARNING : Carbon and tar can build up on the wick after the heater has been in use for a while. This can interfere with the ability of the wick to be lowered into the body of the heater, and can result in the flame not extinguishing completely. It is the responsibility of the owner to inspect the wick, to maintain proper position of the wick, and to replace the wick when necessary in order to prevent the build up of carbon and tar from creating a dangerous situation where the heater does not fully extinguish.

DAILY CHECK AND MAINTENANCE PROCEDURE

It is important to perform the following check and maintenance procedure on a daily basis during the heating season.

WARNING: In performing the check and maintenance procedure,

NEVER ATTEMPT TO REPAIR THE FOLLOWING PARTS:

- Automatic safety shut-off Device - Do not adjust or attempt to disassemble this important safety device. This is the principal safety mechanism of the heater.
- Do not spill kerosene on the device.
- Fuel Gauge - Do not remove or unfasten the screws that attach the fuel gauge to the tank.
- Do not disassemble the fuel gauge.

- **Inspect the cleanliness of the heater**

Keep the heater clean at all times. Keep the reflective panel free from dust, dirt, oil, grease, etc.. It is not safe to use a dirty kerosene heater. Dirt, dust and spilled kerosene cause unwanted odors.

- **Inspect the cartridge tank**

Lift out the cartridge tank and inspect for dents, cracks, leaks, etc. If damage is present, replace the tank at once. Check the drip tray to see if kerosene is present. This could indicate a leak. Do not use the heater if kerosene is present in the drip tray. Check for rust or foreign materials in the tank or fuel reservoir.

- **Inspect wick adjuster and wick guide cylinder**

Check daily to look for carbon accumulation. If carbon is present, lower the wick and remove the carbon using a flat edge screwdriver. Be careful not to allow any carbon deposits to drop into the heater.

- **Inspect the igniter**

If the automatic ignition system does not work, check the filament on the igniter (see Fig. 10) (page 9) to see if it is broken or misshapen. A small distortion can be fixed with a match stick. If the filament is stretched or broken, replace the igniter with a new one. **NOTE: Remove the batteries before replacing the igniter.** Refer to section "CHECKING THE IGNITION SYSTEM" on page 3 for instructions on how to replace the igniter.

Replacement wick has a black line. Fold the new wick and slide it into the holder.

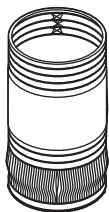

Step 10

The black line on the outside of the wick should match the top edge of the holder. Then press it against the teeth inside the holder to obtain a firm grip.

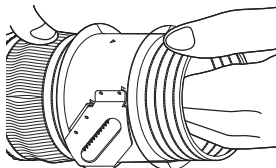

Step 11

Replace the wick and holder in the burner tank. Rotate 90 degrees left and right as well as up and down until the wick slides freely. Check to see that gasket is still in place on the burner tank.

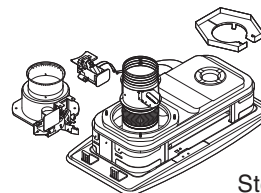

Step 12

It is recommended to reinstall the wick adjusting knob for easier assembling.

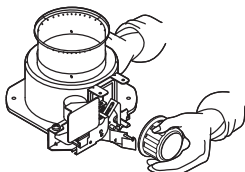

Step 13

Insert the pinion at the other end of the wick control shaft into top portion of the rack of the wick holder. This step can be easily carried out if the wick holder is raised.

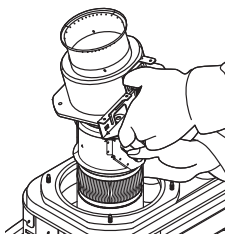

Step 14

Slide the wick adjuster assembly down the draft tube. Position the adjuster shaft to the front of the heater.

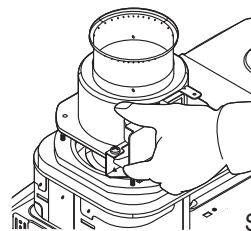

Step 15

Snug 4 wing nuts on the mounting stud, but do not tighten.

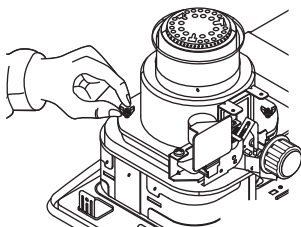

Step 16

Raise the wick to the full "up" position, and evenly tighten wing nuts in several steps.

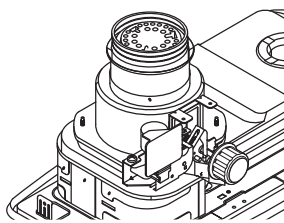

Step 17

Check height of wick. It should be 5/16" above collar.

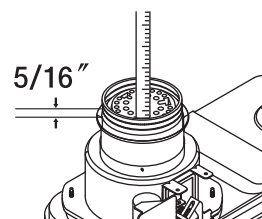

Step 18

Check for correct clearance between wick holder and draft tube. It should be the same all around.

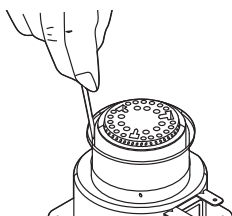

Step 19

Check the function of safety shut-off mechanism by pushing the extinguish button to upset the pendulum.

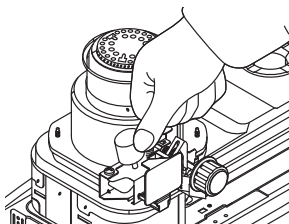

Step 20

Reinstall the automatic ignition assembly.

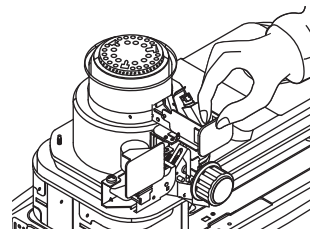

Step 21

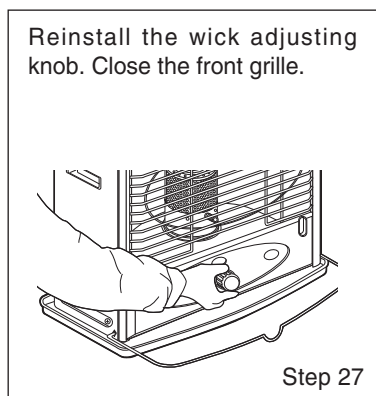
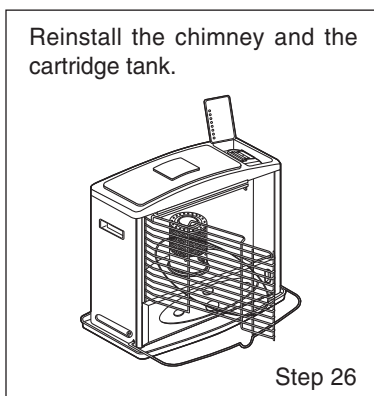
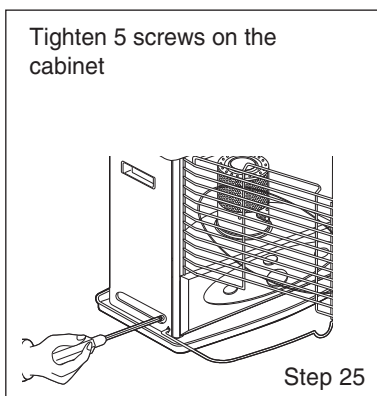
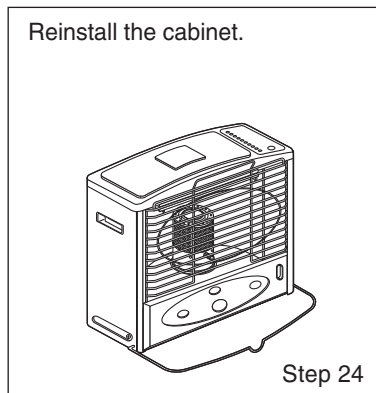
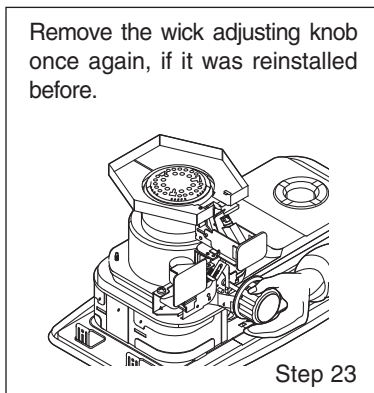
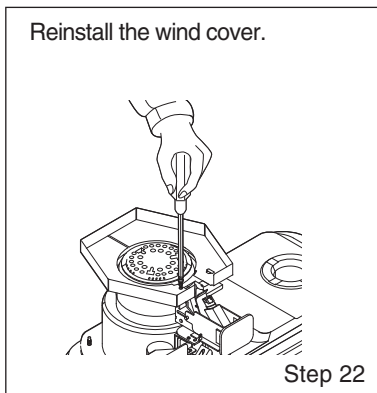

Install the batteries in the battery case, and fill the Cartridge tank with clean, pure kerosene. Set the tank into the heater and wait at least 60 minutes for the new wick to fully saturate with kerosene.

12 CHECKING THE IGNITION SYSTEM

If the automatic ignition system fails to operate properly, **perform the following checks:**

- **BATTERIES - 2 "D"** cell batteries are located at the rear of the heater. Check for proper installation. And / or Replace with new batteries.
- **IGNITE R PLUG** - If the automatic ignition system still doesn't work after replacing the batteries, check the igniter plug. If the glow coil filament is broken, bent, or doesn't glow when engaged via the ignition lever, it must be replaced. **CAUTION: Be sure Igniter plug is 2.5V DC, 1A only.**

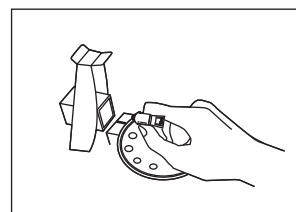

Fig. 11

To replace the igniter plug (Fig. 11);

- Remove the batteries.
- Open the protective grille and remove the burner assembly.
- Push the ignition button to raise the igniter plug.
- Push the igniter plug in and turn in a **counterclockwise** direction to remove.
- Install a new igniter plug (2.5V DC, 1 A only) by pushing it in and turning it in a **clockwise** direction.
- Replace the burner assembly, close the protective grill, and reinstall the batteries.

GLASS CYLINDER REPLACEMENT

Remove speed nuts holding cross pins with a pair of pliers or pry off with a screwdriver. Then pull out cross pins. Replace glass cylinder. In reassembling, make sure that inner and outer cylinders are set in their proper places.

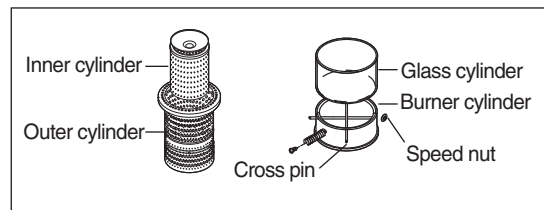

13 WICK ADJUSTER MECHANISM

Turning the wick adjuster knob in a clockwise direction lifts the wick to the top of the wick holder assembly. As the wick is dialed up, the torsion spring located on the wick control shaft is compressed. Raising the wick to the full up position allows the wick to come into contact with the igniter when the ignition knob is depressed. Pressing the extinguish button causes the torsion spring to rapidly lower the wick. You can slow the speed at which the wick is lowered by holding the wick adjuster knob when pressing the manual extinguish button. By slowly releasing the wick adjuster knob, you can slow the speed at which the wick is lowered and reduce the chance of encountering a kerosene odor when extinguishing the heater.

14 AUTOMATIC SAFETY SHUT-OFF DEVICE

This heater is equipped with an automatic safety shut-off device. The purpose of this device is to quickly and efficiently shut off the heater should the heater be jarred or tipped over while in operation. This is the main safety system that is built into the heater, and it functions to prevent the flame from spreading if the heater is knocked over.

The automatic safety shut-off device is built into the mechanism that raises and lowers the wick. It has been designed so that if the pendulum is jarred by a shock of some sort, it retracts a latch from the wick control shaft ratchet, and a torsion spring reacts to drop the wick to its fully lowered position. This rapid lowering of the wick extinguishes the flame. Do not attempt to adjust the torsion spring.

IMPORTANT NOTICE: For the automatic safety shut-off device to function properly, the wick must be free of carbon and tar deposits. Regularly performing the "Carbon Removal / Dry burning" procedure described in the "Wick Maintenance" and "Carbon Removal / Dry Burning" sections on page 9 is very important to the proper functioning of this important safety device.

IMPORTANT NOTICE: PLEASE CHECK THE AUTOMATIC SAFETY SHUT-OFF DEVICE ONCE A WEEK DURING THE HEATING SEASON TO INSURE THAT IT IS FUNCTIONING PROPERLY.

IMPORTANT NOTICE: EVERY TIME THE WICK IS REMOVED OR REPLACED, THE AUTOMATIC SAFETY SHUT-OFF DEVICE MUST BE TESTED TO INSURE THAT IT IS FUNCTIONING PROPERLY.

Carefully following the instructions for storage given below will insure that your heater will operate efficiently and safely next season (Fig. 12/Fig. 13).

-
- A line drawing of the front of the device. It is a rectangular box with a control panel on top. A black arrow points to the bottom edge of the front panel, indicating where to place a marker.

ÁQ | Á^ | æ^{ ^ } o á æ o & } æ&ðmííCE| æ o /O~ ā { ^ } óe ā /OE&•• [| ā /Q&~~~~~-877-475-5660~~~~~, Èæ] æ o ā &È{

17 TROUBLE SHOOTING GUIDE

TROUBLES	CORRECTIVE ACTION
<u>Heater Will Not Light :</u> <ol style="list-style-type: none"> 1. Fuel tank is empty 2. Water present in kerosene 3. Igniter plug Fails to Glow 4. Igniter plug makes contact with side of wick 	<ol style="list-style-type: none"> 1. Fill tank with water-clear 1-K kerosene or red dyed 1-K kerosene. 2. Drain tank. Remove wick assembly & replace wick. Reinstall wick assembly. Fill tank with water-clear 1-K kerosene or red dyed 1-K kerosene. 3. Replace batteries if necessary. Be sure batteries are installed properly. Replace igniter plug. Check for broken or disconnected wire. 4. Lower wick using wick adjuster knob until igniter plug makes contact with top of wick.
<u>Heater Produces Smoke or Odor :</u> <ol style="list-style-type: none"> 1. Flame is too high 2. Heater is in an air draft 3. Burner is not level 4. Carbon or tar built up on wick 5. Contaminated kerosene 	<ol style="list-style-type: none"> 1. Using wick adjuster knob, lower wick to desired 1/2" flame. 2. Move heater out of air draft. 3. Using burner knob, rotate burner from side to side until it seats properly over wick. 4. Perform "Carbon Removal / Dry Burning" procedure. Replace wick if necessary. 5. Drain tank. Remove wick assembly & replace wick. Reinstall wick assembly. Fill tank with water-clear 1-K kerosene or red dyed 1-K kerosene.
<u>Flame Flickers or Dies :</u> <ol style="list-style-type: none"> 1. Water present in kerosene 2. Carbon or tar built up on wick 	<ol style="list-style-type: none"> 1. Drain tank. Remove wick assembly & replace wick. Reinstall wick assembly. Fill tank with water-clear 1-K kerosene or red dyed 1-K kerosene. 2. Perform "Carbon Removal / Dry Burning" procedure. Replace wick if necessary.
<u>Wick Burning Down Excessively :</u> <ol style="list-style-type: none"> 1. Dangerous, volatile fuel mixed with kerosene (gasoline, benzene, alcohol, white gas, paint thinner, camp, stove fuel, oil compound) 	<ol style="list-style-type: none"> 1. Drain and clean tank Remove and replace wick Fill tank with water-clear 1-K kerosene or red dyed 1-K kerosene.
<u>Wick Adjuster Sticks :</u> <ol style="list-style-type: none"> 1. Water present in kerosene 2. Carbon or tar built up 	<ol style="list-style-type: none"> 1. Drain tank. Remove wick assembly & replace wick. Reinstall wick assembly. Fill tank with water-clear 1-K kerosene or red dyed 1-K kerosene. 2. Perform "Carbon Removal / Dry Burning" procedure. Replace wick if necessary.
<u>Heater is enveloped in flames :</u>	<p>Call Fire Department. Smother flames with fire extinguisher or sand. Otherwise smother flames with blankets and then throw water on blankets. Do not throw water directly on the heater itself.</p>

PARTS LIST

DRAWING NUMBER	DESCRIPTION	PART NUMBER
1	FUEL CAP	WS-CT01R
2	HINGE SPRING	WS-CT02R
3	DOOR(RMC-55R7)	WS-CT03R
3-1	DOOR(RMC-55R7B)	WS-CT03RB
4	TOP PLATE(RMC-55R7)	WS-CT04R
4-1	TOP PLATE(RMC-55R7B)	WS-CT04RB
5	CARTRIDGE TANK BAFFLE ASS'Y	WS-CT05R-1
6	VERTICAL REFLECTOR	WS-CT06R
7	BOTTOM REFLECTOR	WS-CT07R
8	CABINET HANDLE(RMC-55R7)	WS-CT08R
8-1	CABINET HANDLE(RMC-55R7B)	WS-CT08RB
9	CABINET(RMC-55R7)	WS-CT09R
9-1	CABINET(RMC-55R7B)	WS-CT09RB
10	FUEL INDICATOR WINDOW(RMC-55R7)	WS-CT10R
10-1	FUEL INDICATOR WINDOW(RMC-55R7B)	WS-CT10RB
11	TOP FRONT PANEL	WS-CT37R
12	FRONT PANEL(RMC-55R7)	WS-CT12R
12-1	FRONT PANEL(RMC-55R7B)	WS-CT12RB
13	WICK HOLDER GASKET	WS-CT13R
14	BATTERY CASE ASS'Y(RMC-55R7)	WS-CT14R
14-1	BATTERY CASE ASS'Y(RMC-55R7B)	WS-CT14RB
15	TANK HOLDER	WS-CT15R
16	BURNER TANK ASS'Y	WS-CT16R
17	DRIP TRAY ASS'Y	WS-CT17R-1
18	BURNER ASS'Y	WS-CT18R
19	GRILLE	WS-CT19R
20	WIND COVER	WS-CT20R
21	IGNITION COIL	WS-CT21R
22	SAFETY SHUTOFF DEVICE(RMC-55R7)	WS-CT22R-1
22-1	SAFETY SHUTOFF DEVICE(RMC-55R7B)	WS-CT22R-1B
23	IGNITER ASS'Y	WS-CT23R-1
24	WICK ADJUSTER(RMC-55R7)	WS-CT24R-1
24-1	WICK ADJUSTER(RMC-55R7B)	WS-CT24R-1B
25	WICK ADJUSTER KNOB(RMC-55R7)	WS-CT25R
25-1	WICK ADJUSTER KNOB(RMC-55R7B)	WS-CT25RB
26	WICK HOLDER	WS-CT26R
27	WICK	See Specs Below
28	WING NUT	WS-CT28R
29	TOP DRAFT TUBE A	WS-CT29R
30	GLASS CYLINDER	WS-CT30R
31	BOTTOM INSULATOR ASS'Y	WS-CT31R
32	TOP INSULATOR	WS-CT32R
33	WALL GUARD	WS-CT33R-1
34	CARTRIDGE TANK ASS'Y	WS-CT34R

REPAIR OF DAMAGED OR LEAKING
CARTRIDGE TANK ASSEMBLY MUST
BE DONE BY A FACTORY
AUTHORIZED SERVICE STATION.

EXPLODED PARTS DRAWING

NOTE: SPECIFY MODEL NUMBER AND
PART NUMBER WHEN ORDERING PARTS.

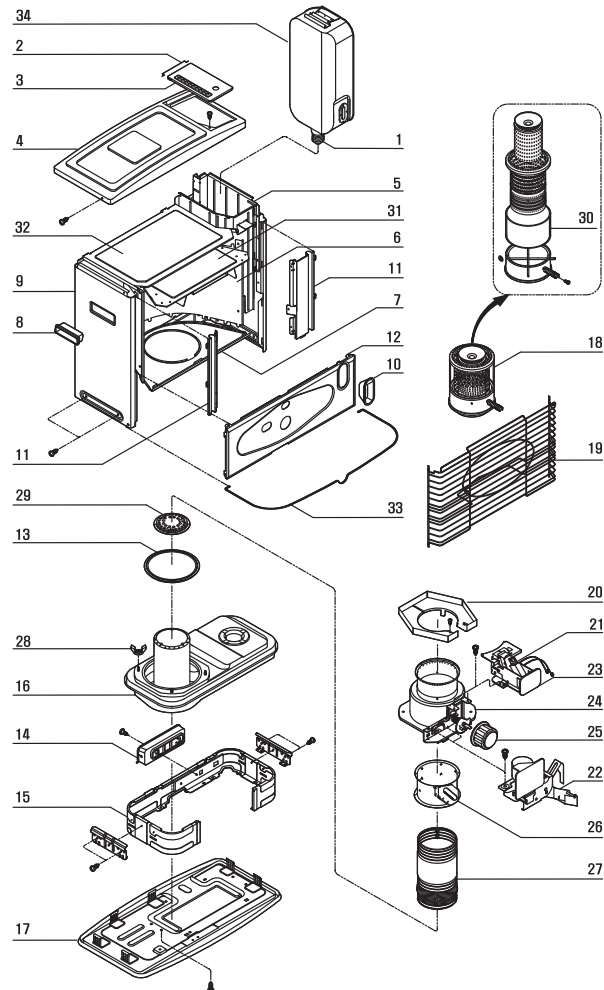

SPECIFICATIONS

Model No.	RMC-55R7/RMC-55R7B	
Type of Heater	Radiant Reflection	
Heat Output	Max. 10,000 BTU/hr	
Fuel Tank	Cartridge	
Tank Capacity	1.0 U.S. Gallon	
Continuous Combustion Time	Approx.11-14 hr.	
Max. Fuel Combustion	0.07 U.S. gallons/hr	
Ignition Method	Battery-D Cell · 2	
Weight(empty)	Approx. 25 Lbs.	
Dimensions	Height	19.3 inches
	Width	22.3 inches
	Depth	11.9 inches
Max. Wick Height	5/16 (8mm)	
Replacement Wick Number	Pick-A-Wick-PW27, Kero-World 20401-U, Dura Heat DH-200 Glowick 200-B	
U.L. Listed	Yes	