

VRT2000 AND VCT2000 SERIES

UNIVERSAL VENT-FREE FIREBOXES

Framing Dimensions

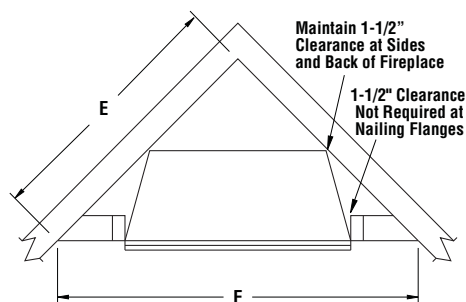
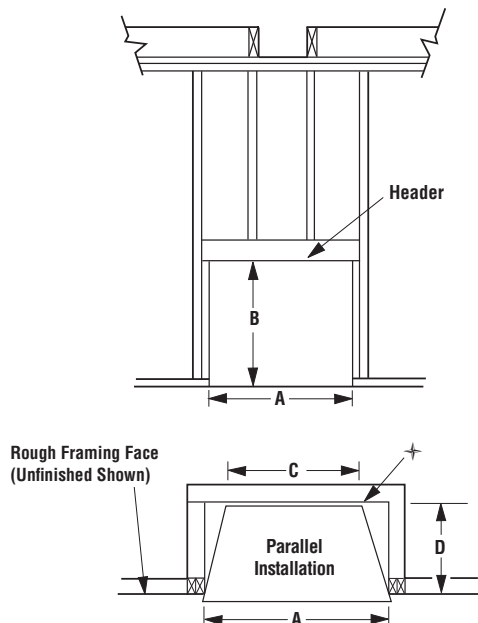

Dim.	36"	42"
A	38-1/4"	44-1/4"
B	37-5/8"	37-5/8"
C	22-5/8"	28-5/8"
D	22"	22"
E	47-3/8"	52-1/2"
F	66-7/8"	72-7/8"

✦ Back wall of chase/enclosure including finishing materials if any.

Fireplace Dimensions

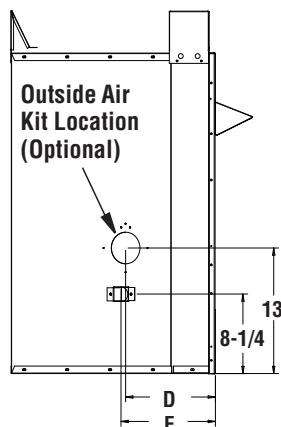
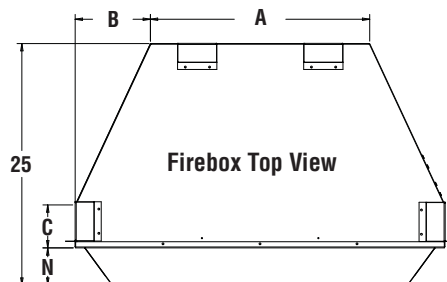

Left Side View

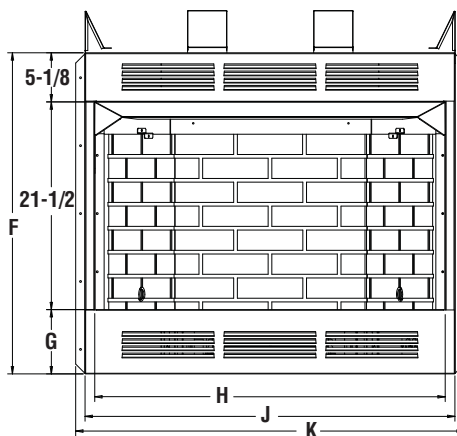

Front View

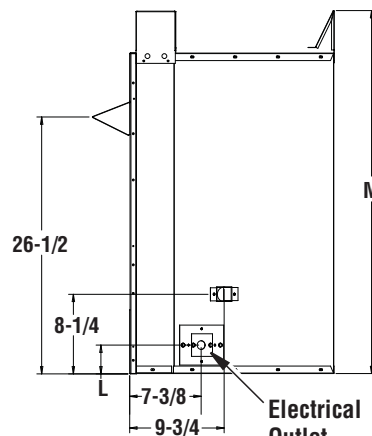

Right Side View

Inches

Model No.	A	B	C	D	E	F	G	H	J	K	L	M	N
36"	22-5/8"	7-3/4"	4-1/2"	9-3/8"	9-3/4"	33-1/8"	6-5/8"	36-1/8"	38-1/8"	40-1/8"	3	37-1/2"	3-7/8"
42"	28-5/8"	7-7/8"	4-1/2"	9-1/4"	9-1/4"	33-1/4"	6-3/4"	42-1/8"	44-1/8"	46"	3-5/8"	37-3/8"	4-1/2"

Diagrams, illustrations and photographs are not to scale. Consult installation instructions. Product designs, materials, dimensions, specifications, colors, and prices are subject to change or discontinuance without notice.

P/N 900711-00, REV. NC, 05/2016

Superior
FIREPLACES®

NOTE: DIAGRAMS & ILLUSTRATIONS ARE NOT TO SCALE.

Page 1 of 2

VRT2000 AND VCT2000 SERIES

Product Information

Cat. No.	Model	Type	Interior	Ship. Weight	Shipping Volume
F0323	VRT2036B	Radiant	Black	150 lb.	20.3 cu. ft.
F0324	VCT2036B	Louvered	Black	180 lb.	20.3 cu. ft.
F0325	VRT2036WS	Radiant	White Stacked	150 lb.	20.3 cu. ft.
F0326	VCT2036WS	Louvered	White Stacked	180 lb.	20.3 cu. ft.
F0327	VRT2042B	Radiant	Black	180 lb.	22 cu. ft.
F0328	VCT2042B	Louvered	Black	180 lb.	22 cu. ft.
F0329	VRT2042WS	Radiant	White Stacked	180 lb.	22 cu. ft.
F0330	VCT2042WS	Louvered	White Stacked	180 lb.	22 cu. ft.

Listing Information



Report No. F12-020

These appliances comply with National Safety Standards and are listed by PFS Corporation to ANSI Z21.91 Ventless Firebox Enclosures for Gas-Fired Unvented Decorative Room Heaters and is approved for use with appliances listed to ANSI Z21.11.2 decorative type unvented room heaters.

Clearances

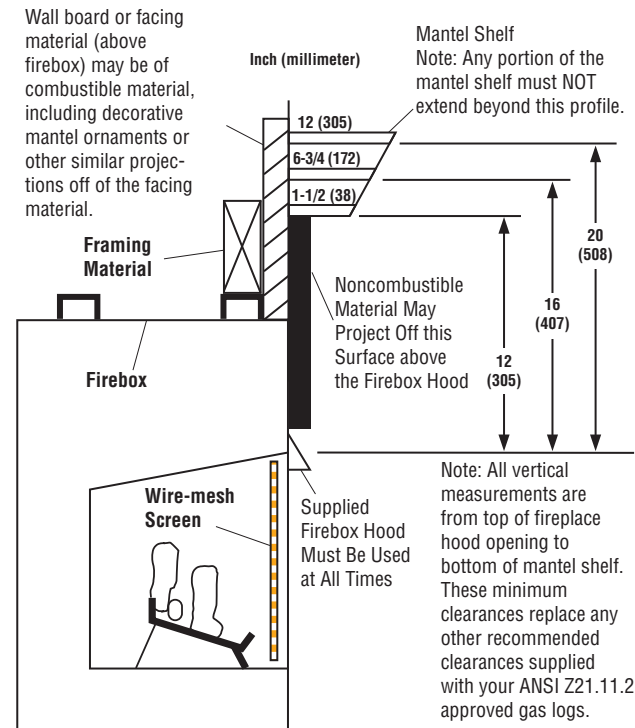

Minimum Wall and Ceiling Clearances (see figure below)

- Clearances from the side of the fireplace cabinet to any combustible material and wall should follow diagram shown here.
Example: The face of a mantel, bookshelf, etc. is made of combustible material and protrudes 3-1/2" from the wall. This combustible material must be 4" from the side of the fireplace cabinet.
- Clearances from the top of the firebox opening to the ceiling should not be less than 42".
- When the firebox is installed directly on carpeting, vinyl tile or other combustible material, other than wood flooring, the firebox should be installed on a metal or wood panel extending the full width and depth of the enclosure.
- Clearances from the bottom of firebox to the floor is 0".

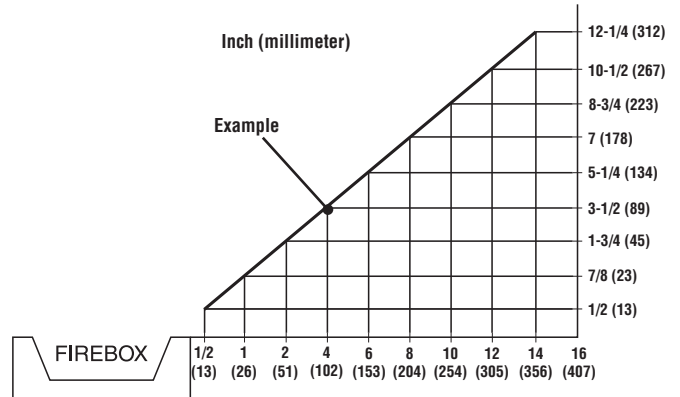

Nailing Flanges

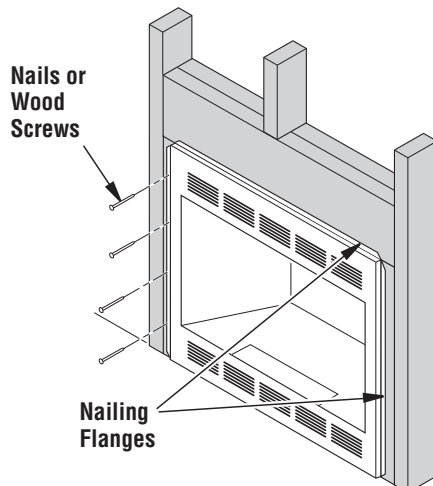

Hood

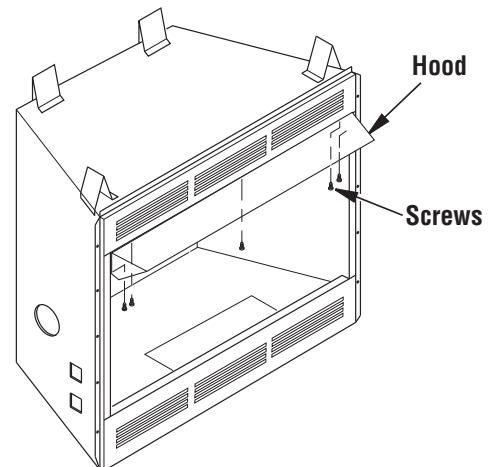

Screw and Hood Placement