

VAVC-5000

Parts Breakdown - Revision D



FOR QUESTIONS AND CONCERNS, CONTACT US AT

Allparts Equipment &
Accessories Inc.

www.allpartsinc.com

Call Us: 1-269-685-4123

Text Us: 1-269-447-0412

ITEM	PART NO.	DESCRIPTION	QTY
1	ACC-9080	AIR INTAKE FILTER ASSY.	2
2	357-9701	AIR FILTER	2
3	447-4523	COMPRESSOR PUMP	1
4	SS-82	5/8-11 X 2" HHCS	4
5	SS-9927	1/2-13 X 7/8" LG. HHCS	8
6	SS-1506	1/2" LOCK WASHER	16
7	SS-1527	1/2" FLAT WASHER	20
8	ACC-9079	VIBRATION ISOLATOR 15 HP.	4
9	SS-1524	5/16 FLAT WASHER	4
10	SS-1503	5/16 LOCK WASHER	4
11	SS-12	5/16-18 X 3/4 HHCS	4
12	ACC-9060	PUMP BASE ASSY.	1
13	SS-01901	1" X 45 DEG. ELBOW	1
14	SS-1088	1" ST. ELBOW	1
15	SS-2119	3/4 X 4" NIPPLE	2
16	SS-659	1/2 HEX NUT	8
17	SS-49	1/2 X 1.25 HEX BOLT	8
18	SS-661	5/8-11 HEX. NUT	4
19	SS-1508	5/8 LOCK WASHER	4
20	SS-725	HEX NUT 5/16"	8
21	MO-9039	MOTOR, 200 VOLT, 3 PHASE	1
21	MO-9040	MOTOR, 230/460 VOLT, 3 PHASE	1
21	MO-9041	MOTOR, 575 VOLT, 3 PHASE	1
22	ACC-9069	MOTOR BASE	1
23	ACC-9099	MOTOR WIRING HARNESS	1
24	H-9035	FLEX HOSE 3/4 DIA.	1
25	SS-1074	3/4 ST. ELBOW	1
26	SS-2074	3/4 X 2" NIPPLE	1
27	ACC-9092	CHECK VALVE 3/4" INLINE	1
28	TW-18	1/4" COMPRESSION ELBOW	1
29	SS-1160	3/4" UNION	1
30	ACC-9091	TEMPERATURE SWITCH	1
31	SS-1251	3/4 X 1/2 BUSHING	1
32	SS-1249	3/4 X 1/4 BUSHING	1
33	TIA-5200	SAFETY VALVE 200 PSI MAX.	1
34	ACC-9008	1/4" ELBOW NYLON TUBE	1
35	R8505	1/4" NYLON TUBE	1
36	SS-7345	1/4 SERVICE TEE	4
37	SS-2785	3/4" CROSS	1
38	SS-9924	3/8 PIPE CAP	1
39	SS-2108	3/8 X 2 NIPPLE	1
40	SS-1248	1/2 X 3/8 BUSHING	1
41	SS-1113	1/2 TEE	1
42	SS-1073	3/8" STR. ELBOW	1
43	SS-2073	1/2 CLOSE NIPPLE	1
44	SS-655	HEX NUT 1/4"	4
45	SS-1505	LOCK WASHER 1/4"	4
46	SS-2983	MACHINE SCREW 1/4"	4
47	OM-9002	BRACKET	1
48	SS-1248	3/8 x 1/2 BUSHING	1
49	R8504	1/2" POLY. TUBE	1
50	ACC-9005	3/8 COMP. FITTING	2
51	ACC-9002	CORD CONNECTOR	1
52	OM-9000	OIL MONITOR	1
53	SS-3213	1/4 COMP. FITTING	1
54	R8505	1/4" OD BLACK NYLON TUBE	1
55	TW-18	1/8 COMP. ELBOW	1
56	SS-9940	FILTER TUBING	2
57	445-2-1	FLYWHEEL	1
58	BT-9032	BELT	2
59	PU-9213	PULLEY	1
60	ACC-9009	FAN BLADE 15" DIA.	1
61	ACC-9071	FAN SHROUD	1
62	CT-9480	AFTERCOOLER TUBE INNER	1
63	CT-9479	AFTERCOOLER TUBE OUTER	1
64	VAS-15	MANIFOLD FITTING	1
65	ACC-9101-1	FAN GUARD	1

66 R7602 CONTROL WIRE 8 (B)

REV.	DATE	REVISION DESCRIPTION	PCN NO.
A	FEB,7,00	ACC-9101-1 ADDED	99-29
B	AUG16,00	WIRE ADDED	00-34
C	JAN23,00	FITTINGS UPDATED	01-7
D	AUG19'03	R8505 WAS OM-9003 (#54)	03-46

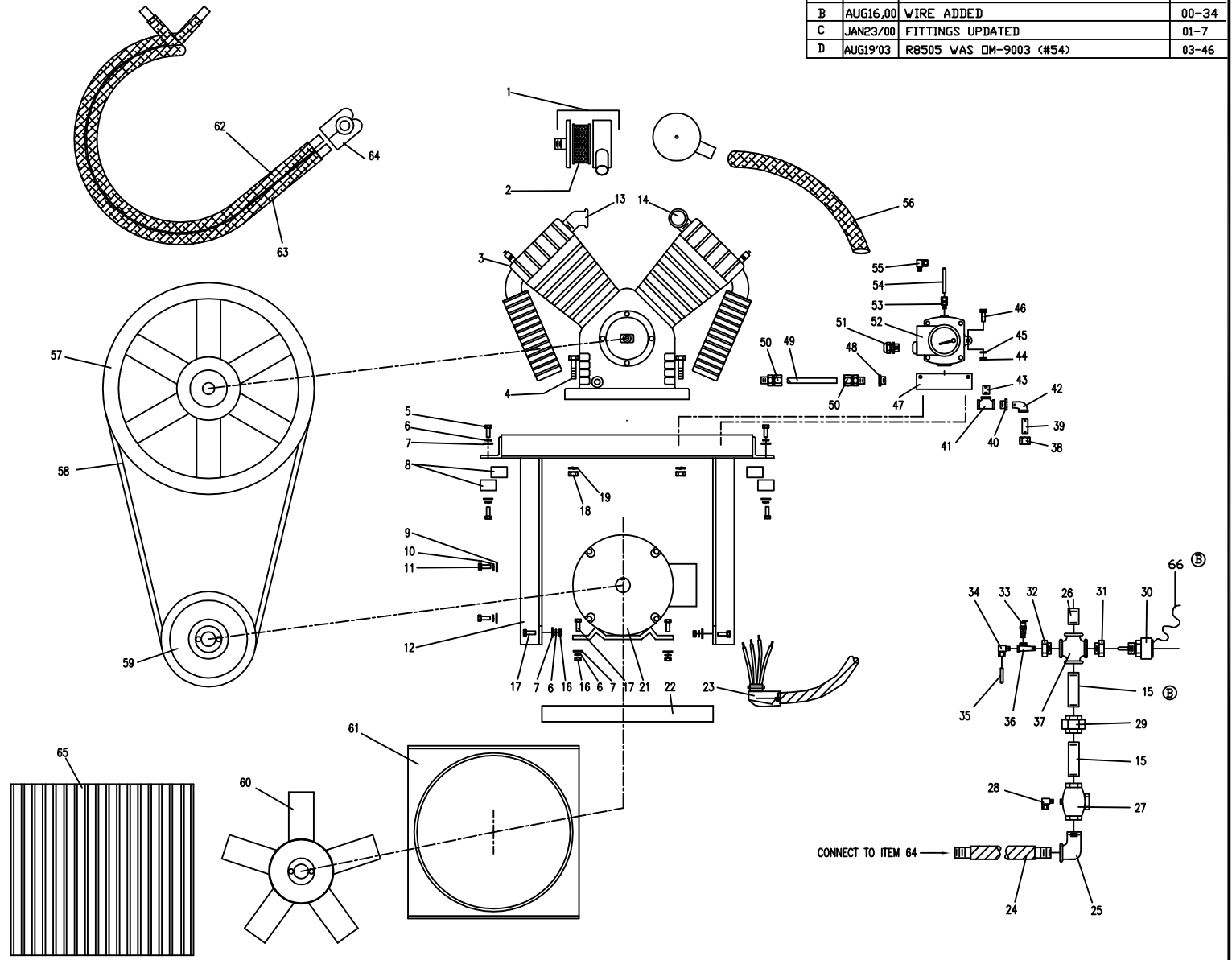

IMPORTANT NOTE: This print is the confidential property of DEVAIR, INC. It is not to be used or reproduced in any manner, nor submitted to other parties for examination without the prior approval of DEVAIR, INC.

FRACTIONAL DIMENSIONS: ±1/32
 DECIMAL DIMENSION: ±.005
 ANGLES: ±1°
 *UNLESS OTHERWISE SPECIFIED



NAME OF PROJECT				DESCRIPTION OF DRAWING	
15 HP. SILENT COMPRESSOR				EXPLODED VIEW	
DRAWN BY: IRAJ FILSOFI				DRAWING NO. VAVC-5000	
CHECKED BY:				SHT NO/REV. D	
DATE: 20 OCT'98				SCALE: N.T.S.	