



WARNING: To reduce the risk of injury, read the pressure washer instruction manual and the engine instruction manual before operating pressure washer.



IF YOU EXPERIENCE ANY ISSUES WITH YOUR PRESSURE WASHER, WE ARE HERE TO HELP YOU.

Visit our website www.SimpsonCleaning.com or call 1-877-362-4271

SHOULD YOU REQUIRE ASSISTANCE WITH A PART THAT MAY BE BROKEN OR MISSING OR YOU ARE HAVING DIFFICULTY WITH ASSEMBLY OR STARTING PLEASE CONTACT US. YOUR COMPLETE SATISFACTION IS OUR PRIMARY OBJECTIVE.

QUICK SETUP GUIDE

(Letters A-C)

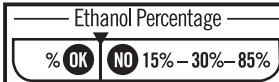

NOTICE: Use of fuels with greater than 10% ethanol are not approved for use in this product per EPA regulations and will damage the unit and void the warranty.

A

Install the Handle

Place handle onto frame, depress the snap buttons, and slide the handle assembly onto the frame until snap buttons snap into place.

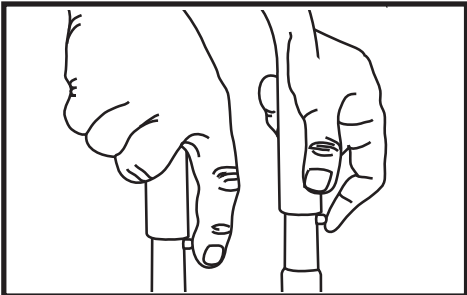

B

Add/Check Oil

The engine is shipped without oil. Before starting engine, add the oil provided. Check oil level prior to each use. Refer to Engine Owner's Manual for complete procedure.

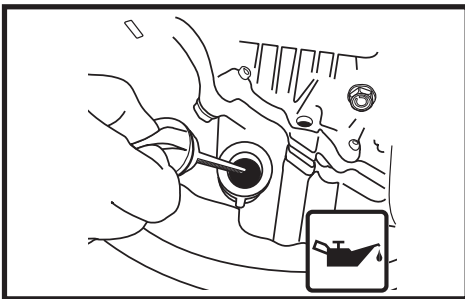

C

Add Gasoline

In a well ventilated outdoor area add fresh, high quality, unleaded gasoline with a pump octane rating of 86 or higher. Do not overfill. Wipe up spilled fuel before starting the engine. Refer to Engine Owner's Manual for complete procedure.

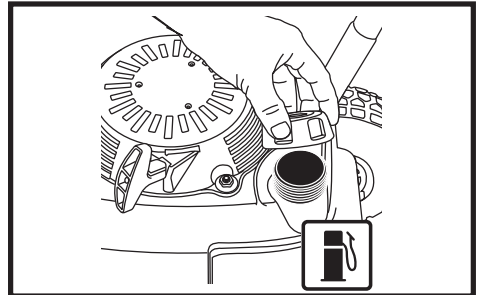

IMPORTANT: Ethanol Shield™ (sold separately) is a fuel stabilizer that helps eliminate and prevent ethanol related problems in power equipment. Follow the instructions on the container and add to the gasoline.



DANGER:

- Never run engine indoors or in enclosed, poorly ventilated areas. Engine exhaust contains carbon monoxide, an odorless and deadly gas.
- Risk of fluid injection and laceration. When using the high-pressure setting, DO NOT allow the high-pressure spray to come in contact with unprotected skin, eyes or with any pets or animals. Serious injury will occur.

QUICK START GUIDE

(Numbers 1-12)

1

Connect Garden Hose to Pump

Thread the garden hose to the pump inlet. See Label #1 on the unit.

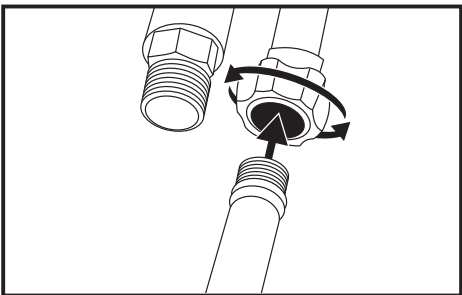

2

Connect High Pressure Hose to Pump

Thread the high pressure hose to the pump outlet. See Label #2 on the unit.

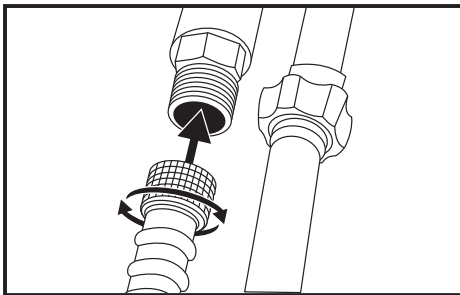

3

Connect High Pressure Hose to Spray Gun

Thread the other end of the high pressure hose to the spray gun.

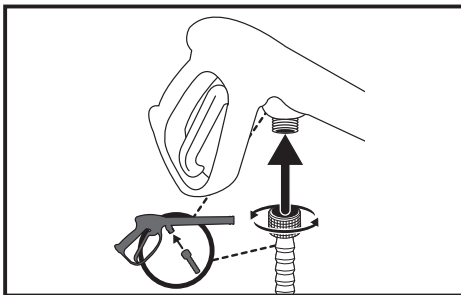

4

Connect Spray Wand to Spray Gun

Thread the spray wand into the end of the spray gun.

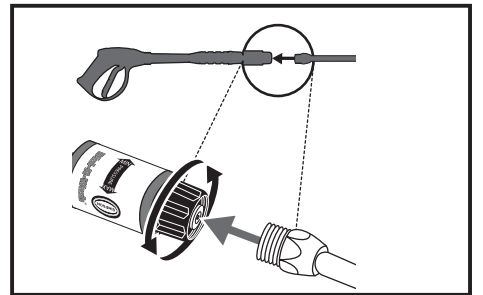

5

Connect QC Nozzles to Spray Wand

Pull quick connect coupler back and insert nozzle. Release quick connect coupler and twist nozzle to make sure it is secure in coupler.

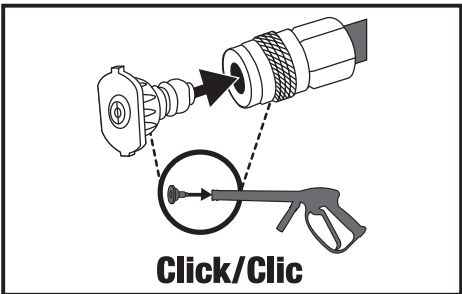

6

Turn Water Faucet Completely On

Do not run the unit without water supply connected and turned on. Use Cold Water Only.

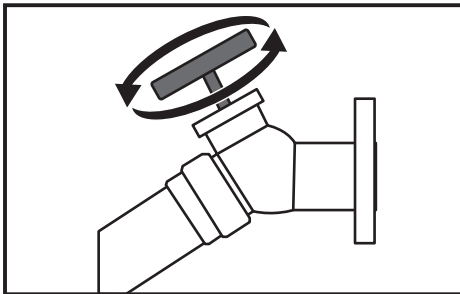

7

Release Air from System

Release all air from pump and high pressure hose by depressing trigger until a steady stream of water is present. Approximately 30 seconds.

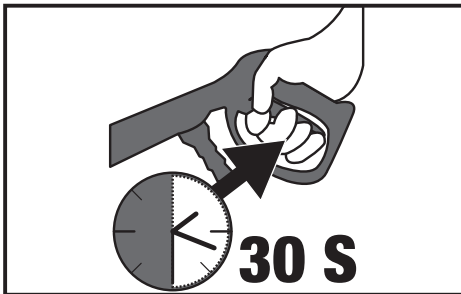

8

Verify the Fuel Valve is turned to the OPEN Position

The Fuel Valve has been preset by the factory to be in the OPEN position. See label #8 on unit.

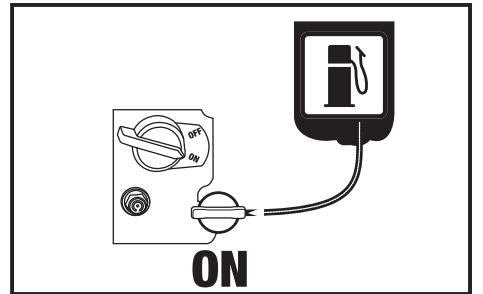

9

Verify the Engine Switch is turned to the ON Position

See label #9 on unit.

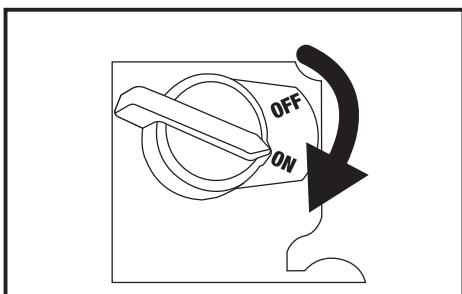

10

Verify the Choke Pin is Pulled Out to the CLOSED Position

The Choke Pin has been preset by the factory to be in the CLOSED Position. See label #10 on unit.

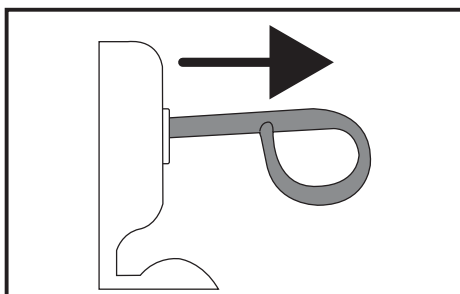

11

Pull the Recoil Starter Grip

Pull the recoil starter grip to start the engine. See label #11 on unit.

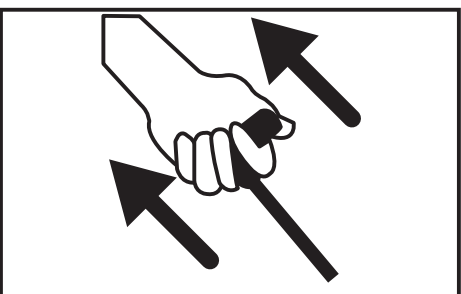

12

Push the Choke Pin to the OPEN Position

Gradually move the Choke Pin to the OPEN Position after engine starts. See label #12 on unit.

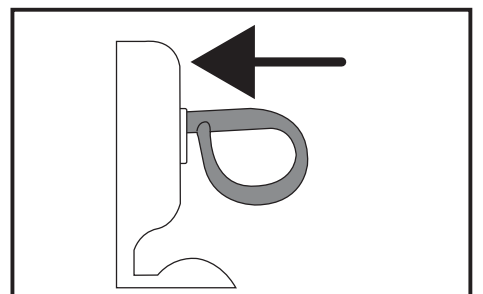

WARNING: This Guide is not a substitute for reading the instruction manual. User must read and understand operator's manual before using this product.