

SUPERIOR.

The Fireplace Company

Installation And Operating Instructions

*For Superior's
Vented
Decorative
Gas Appliance
With Direct Vent
Natural Gas Model
GDV-5000N
Propane Model
GDV-5000L*

*And Direct
Vent Kit
Accessory
Models
GDV-TK
GDV-TK2
And GDV-45*

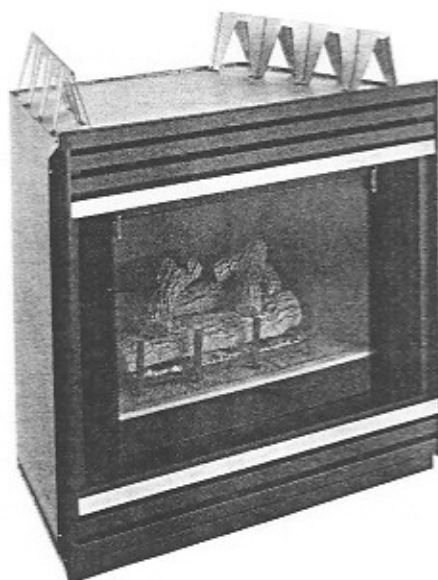

GDV-5000

This installation manual will help you obtain a safe, efficient, dependable installation for your fireplace and vent system. Please read and understand these installation instructions before beginning your installation.

WARNING: THE GDV-5000 FIREPLACE IS A VENTED DECORATIVE GAS APPLIANCE. DO NOT BURN WOOD OR OTHER MATERIAL IN THESE APPLIANCES.

Do not attempt to alter or modify the construction of the fireplace or its components. Any modification or alteration of construction may void the warranty, certification and approvals of these units.

FOR YOUR SAFETY

If you smell gas:

1. Open Windows.
2. Don't touch electrical switches.
3. Extinguish any open flame
4. Immediately call your gas supplier.

FOR YOUR SAFETY

Do not store or use gasoline or other flammable vapors or liquids in the vicinity of this or any other appliance.

Due to high temperatures, the appliance should be located out of traffic and away from furniture or draperies.

Do not place clothing or other materials on or near the appliance.

PLEASE RETAIN THIS MANUAL FOR FUTURE REFERENCE



GENERAL INFORMATION

This appliance complies with National Safety Standards and has been tested and listed by Underwriters Laboratories, Inc. and the Canadian Gas Association to ANSI Z21.50-1986 for U.S. installations and CAN/C.G.A. - 2.22 standard for Canadian installations as a vented decorative gas appliance with direct vent.

Installation must conform to local codes. In the absence of local codes installation must conform with the current National Fuel Gas Code, ANSI Z223.1 in the U.S. or the current CAN1-B149 Installation Code in Canada. The appliance, when installed, must be electrically grounded in accordance with local codes, with the National Electrical Code, ANSI/NFPA No 70-1984 in the U.S. or with the current Canadian Electric Code CSA C22.1 in Canada.

Note: Installation and repair should be done by a qualified service person. The appliance should be inspected annually by a professional service person. More frequent inspections/cleanings may be required due to excessive lint from carpeting, bedding material, etc. It is imperative that the control compartment, burners and circulating air passage ways of the appliance be kept clean.

Provide for adequate ventilation.

Provide adequate clearances around air openings and adequate accessibility clearance for service and proper operation. Never obstruct the front opening of the fireplace.

Minimum clearances to combustibles are: sides 1/2", floor 0", back 1/2", ceiling 37 1/2", sidewall 0". Vent surfaces top 3", sides 1 3/4", bottom 1".

Minimum inlet gas pressure is 4.5 inches water column for natural gas and 12 inches water column propane for the purpose of input adjustment. Maximum inlet gas supply pressure is 7.0 inches water column for natural gas and 13.0 inches water column for propane.

Input is 24,000 BTU/HR for natural gas
21,000 BTU/HR for propane

A 1/8" N.P.T. plugged tapping is provided on the gas control along side of the main burner for a test gage connection.

This appliance must be vented through an outside wall and must not be connected to a chimney flue servicing a solid fuel burning appliance.

The appliance must be isolated from the main gas supply during any pressure testing of the gas supply piping system at test pressures equal to or more than 1/2 psig.

INTRODUCTION

The GDV-5000 is a sealed combustion (direct vent) heat circulating gas appliance utilizing a millivolt 100% safety shut off gas control and a piezo ignition system. Horizontal trim kits and a forced air fan assembly are optional equipment.

The GDV-5000 must be installed on an outside wall using the model GDV-TK or GDV-TK2 vent terminal kit. The GDV-TK base assembly is designed to penetrate an outside rear wall having a minimum dimension (total thickness) of 4 1/4" and a maximum dimension of 7 1/4". The GDV-TK2 vent terminal kit will penetrate an outside rear wall greater than 7 1/4" thick up to 10 1/4" thick. The vent terminal kits may also be used with the model GDV-45 elbow accessory kit to install the unit diagonally in an outside corner (45°) wall having a minimum dimension of 4 1/4" and a maximum of 10 1/4".

ASSEMBLY STEPS

1. Position appliance prior to framing or into prepared framing.
2. Route gas line to appliance and install millivolt wall switch.
3. Install direct vent system (vent terminal kit).
4. Field wire main power supply to appliance junction box only if optional fan assembly is to be installed at a later time.
5. Complete finished wall material and trim.
6. Install logs into burner assembly. Connect to gas supply.
7. Wire remote millivolt wall switch to control valve.
8. Attach horizontal louvers and/or optional trim pieces to appliance.

INSTALLATION (FLAT WALL)

Step 1. To install the appliance against an outside wall (projecting into the room), frame appliance enclosure as illustrated in Figures 1 and 2. To install the appliance flush with an outside wall, frame exterior appliance enclosure as illustrated in Figures 3 and 4. If appliance is to be elevated above floor level, a solid continuous platform must be constructed. Additionally, if possible, the appliance should be centered between two 16" on center studs (as illustrated), to avoid extra framing when later installing the vent terminal kit. The header may rest on the top metal spacers but must not be notched to fit around them.

NOTE: DIAGRAMS & ILLUSTRATIONS NOT TO SCALE

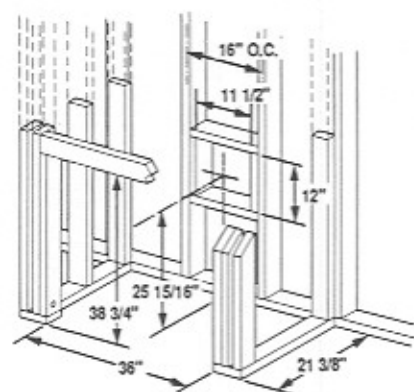

Figure 1

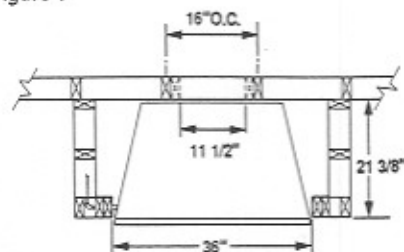

Figure 2

Note: The framed depth (21 3/8" from a framed wall) must always be measured from a finished surface. If a wall covering such as drywall is to be attached to the rear wall, then the 21 3/8" must be measured from the drywall surface. It is important that this dimension be exact in order for the vent terminal kit to be connected properly.

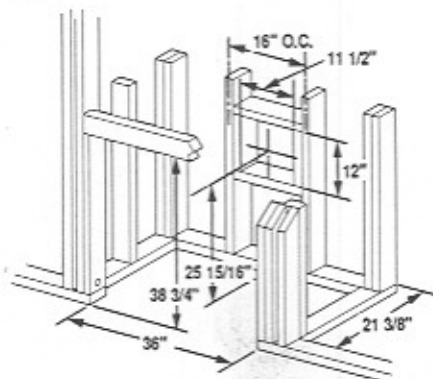

Figure 3

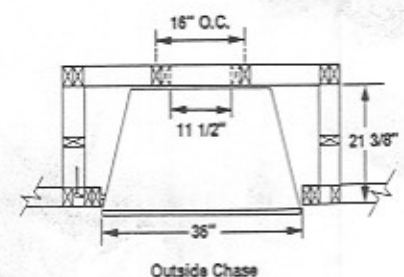

Figure 4

Step 2. Route a 1/2" NPT black iron gas line behind the front face of rough framing (Figure 5). Framing members at this point must be drilled to accept the gas line.

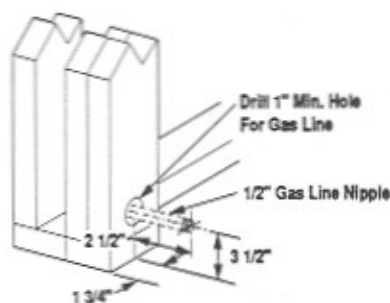

Figure 5

Step 3. Position the appliance into prepared framing, fasten with 6d nails through the nailing flange holes. The nailing flange and the area directly behind the nailing flange are exempt from the clearances described on the appliance label.

Step 4. Install the outside firestop assembly into prepared framed opening (Figure 6).

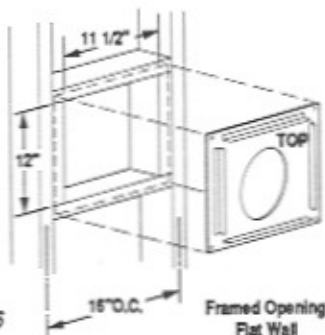

Figure 6

Note: If the total outside wall thickness is to be 4 1/4" to 7 1/4", then the GDV-TK vent terminal kit will complete the vent system installation. If the total wall thickness is greater than 7 1/4" but less than or equal to 10 1/4", then the GDV-TK2 vent terminal kit must be used. If wall thickness is less than the minimum, then the exterior wall surface must be extended to meet this minimum dimension.

Step 5. Insert vent terminal kit through firestop assembly and connect to appliance outlet collars in manner illustrated in Figure 7. Do not fully engage the vent terminal kit until finished exterior wall surface is applied. At that time, the vent terminal kit can be fully engaged into the appliance collars and secured to the outside wall with 6d nails as shown in Figure 8. To seal kit to wall, silicone caulking should be applied around the entire perimeter of the kit.

Note: For installation in the U.S., the vent terminal must be located at least 9" away from any opening into the building and the bottom of the vent terminal and air intake must be at least 12" above grade. For installation in Canada, the vent terminal must be at least 3' away from any building opening.

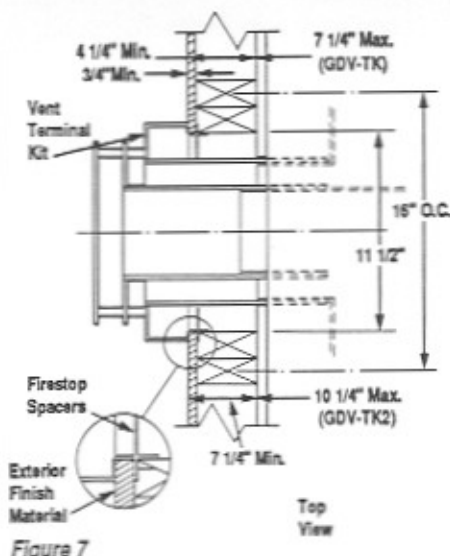

Figure 7

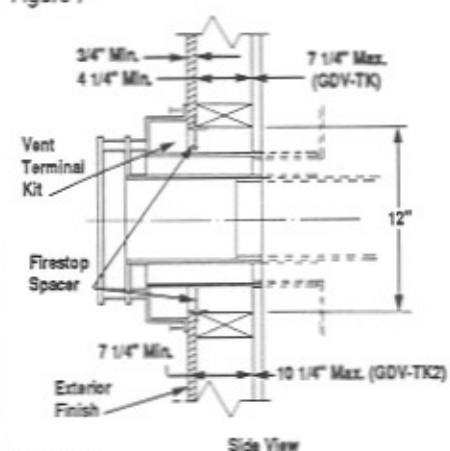

Figure 8

INSTALLATION (45° DIAGONAL CORNER)

Step 1. To install the appliance in a 45° diagonal corner frame appliance enclosure as illustrated in Figures 9, 10 and 16. If appliance is to be elevated above floor level, a solid continuous platform must be constructed. The header may rest on the top metal spacers but must not be notched to fit around them.

Note: The framed depth must always be as illustrated for the vent terminal kit to be installed and connected properly.

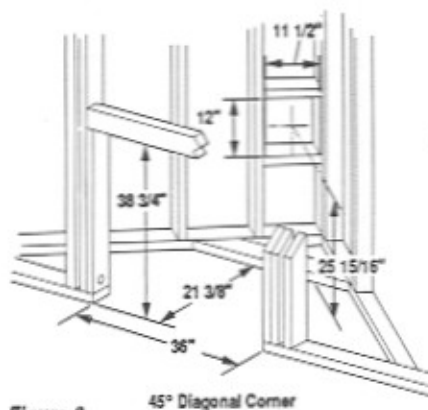

Figure 9

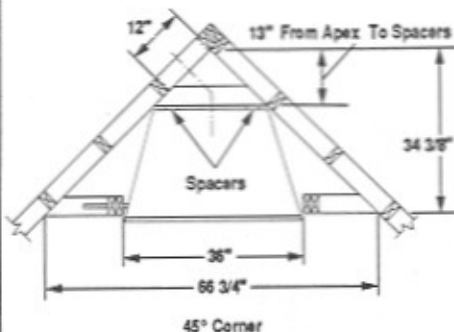

Figure 10

Step 2. Route a 1/2" NPT black iron gas line behind the front face of rough framing (Figure 5). The gas line may only enter the appliance from the left side. Framing members at this point must be drilled to accept the gas line.

Step 3. Attach the inner 45° elbow over the inner appliance collar until the flange hole aligns with the hole in the outer collar (Figure 11). Insert a #8-15 x 1/2" screw (provided) through hole in outer collar and into flange on inner collar (Figure 12). Do not tighten at this time.

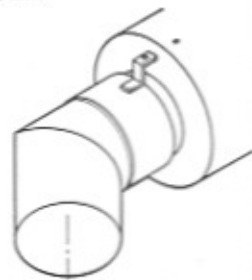

Figure 11

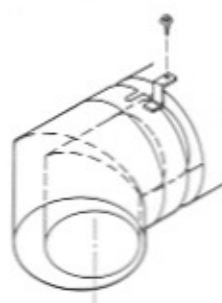

Figure 12

Step 4. Attach the outer 45° elbow over the outer appliance collar until back of slot contacts screw. Tighten screw to secure outer elbow (Figure 13).

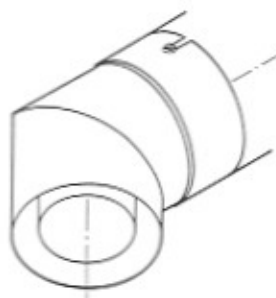

Figure 13

Note: To penetrate the outside wall on the left side behind the appliance, the flange on the inner elbow must be orientated with the upper hole in the appliance collar (Figure 14). To penetrate the outside wall on the right side behind the appliance, the opposite flange on the inner elbow must be orientated with the upper hole in the appliance collar (Figure 15).

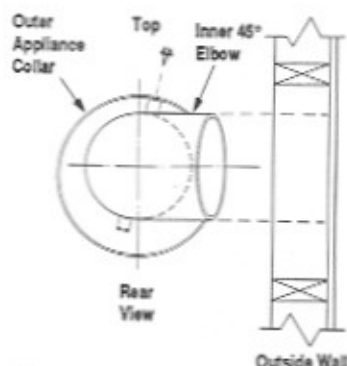

Figure 14

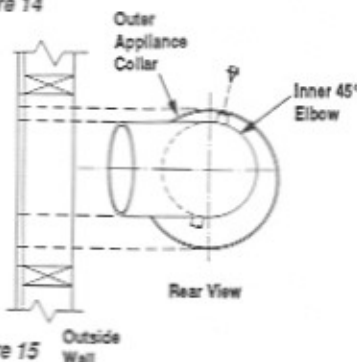

Figure 15

Step 5. Position the appliance into prepared framing, fasten with 6d nails through the nailing flange holes. The nailing flange and the area directly behind the nailing flange are exempt from the clearances described on the appliance label.

Step 6. Install the outside firestop assembly into prepared framed opening (Figure 16).

Note: If the total outside wall thickness is to be 4 1/4" to 7 1/4", then the GDV-TK vent terminal kit will complete the vent system installation. If the total wall thickness is greater than 7 1/4" but less than or equal to 10 1/4", then the GDV-TK2 vent terminal kit must be used. If wall thickness is less than the minimum then the exterior wall surface must be extended to meet this minimum dimension.

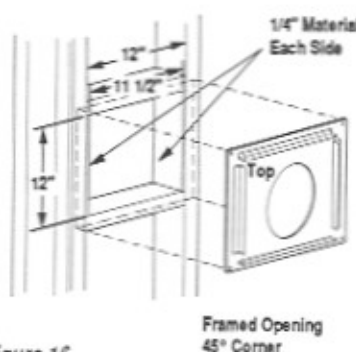

Figure 16

Step 7. Insert the vent terminal kit through firestop assembly and connect to 45° elbows in manner illustrated in Figure 17. Do not fully engage the vent terminal kit until finished exterior wall surface is applied. At that time, the vent terminal kit can be fully engaged around the 45° elbows and secured to the outside wall with 6d nails as shown in Figure 17. To seal kit to wall, silicon caulking should be applied around entire perimeter of the vent terminal kit.

Note: For installation in the U.S., the vent terminal must be located at least 9" away from any opening into the building and the bottom of the vent terminal and air intake must be at least 12" above grade. For installation in Canada, the vent terminal must be at least 3" from any building opening.

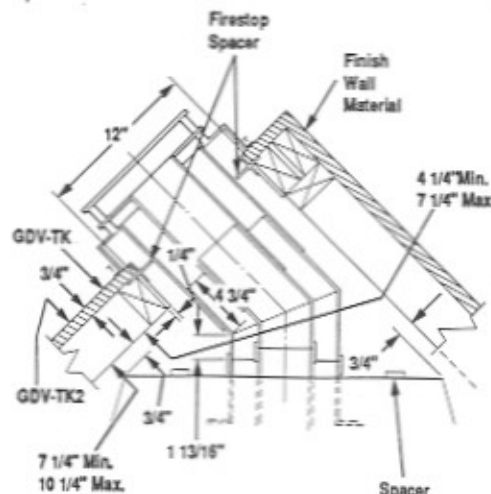

Figure 17

NOTE: DIAGRAMS & ILLUSTRATIONS NOT TO SCALE

VENT TERMINAL INSTALLATION DETAIL

If combustible overhead projection exceeds 2 1/2" beyond exterior wall, then its height above vent terminal kit is 12". If projection does not exceed 2 1/2" then height above termination kit is 3".

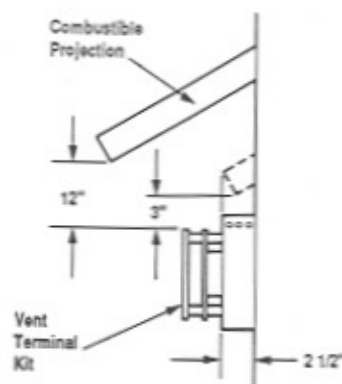

Figure 18

INSTALLING THE GAS LINE

Note: There are two possible gas line connection procedures that can be used in the U.S.: a flex connector or a rigid pipe connection. In most localities either connection procedure would be acceptable. It is always best to consult local codes. In Canada, the rigid pipe connection procedure must be employed.

Note: Check for gas leaks with soap and water solution. **DO NOT USE OPEN FLAME FOR LEAK TESTING.**

After gas line installation is complete, use insulation (not provided) to pack space where gas line penetrates the appliance. Pack insulation tightly from outside the appliance to completely seal this space.

Flex Connector Procedure (U.S. only)

Step 1. Attach a 3/8" flex connector (18" length) with a 1/2" shut off valve and a 3/8" adapter to the 1/2" gas supply. Using a wrench and pipe joint compound, tighten securely (Figure 19).

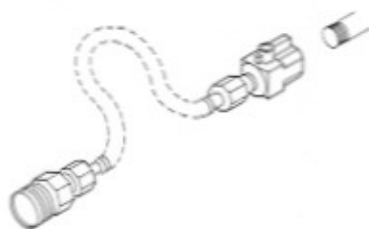

Figure 19

Step 2. Remove the 3/8" adapter fitting from the flex connector and attach the adapter to the gas control valve using a wrench and pipe joint compound. Tighten securely (Figure 20).

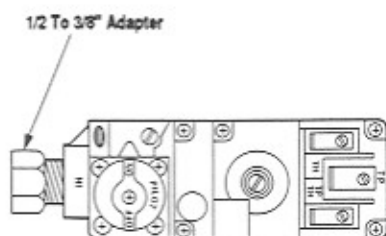

Figure 20

Step 3. Carefully bend and shape the flex connector so that a connection can be made to the adapter just mounted on the gas valve (Figure 21).

Note: Do not damage or kink the flex connector.

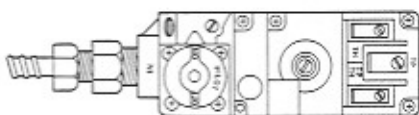

Figure 21

Rigid Pipe Procedure (U.S. and Canada)

Extend previously installed 1/2" NPT gas pipe to gas control. The pipe must be reduced to 3/8" for connection to the gas control. Figure 22 illustrates the method of connection. Secure tightly all fittings using a wrench and pipe joint compound.

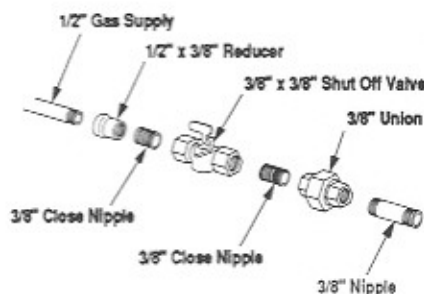

Figure 22

REMOTE MILLIVOLT WALL SWITCH WIRING

Step 1. Install the remote wall switch in a convenient location and route the 18 gage millivolt wire through access hole behind gas line (Figure 23). At least 12" of wire is required in the control compartment.

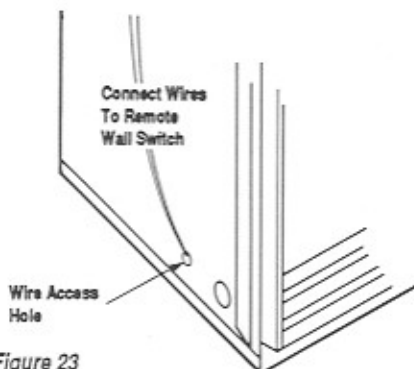

Figure 23

Step 2. Attach one wire from the remote millivolt wall switch to the "TH" terminal on the gas control valve. Connect the other wire from the wall switch to the lead wires from the door safety micro switch located in the control area.

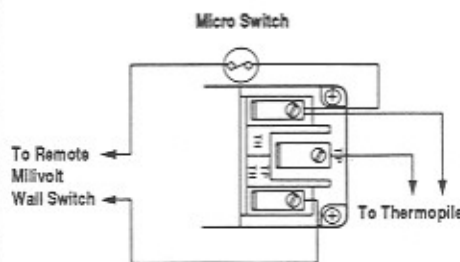

Figure 24

CAUTION: DO NOT WIRE MILLIVOLT REMOTE WALL SWITCH FOR GAS APPLIANCE TO A 120V POWER SUPPLY.

ACCESSORIES

Optional Fan Kit

If the optional fan kit, Model FAK-1500, is to be installed on the GDV-5000, refer to the installation instructions packed with the kit. The GDV-5000 has been pre-wired at the factory to accept the fan kit at some later time. The appliance, however, must be connected to the main power supply at the time of installation if the fan kit is to be installed later.

Route a 3 wire 120V 60Hz power supply line through a 120V wall switch (not provided) and to the junction box (located in the lower right side of the appliance). Refer to Figure 25 and the installation instructions packed with the FAK-1500 fan kit.

NOTE: DIAGRAMS & ILLUSTRATIONS NOT TO SCALE

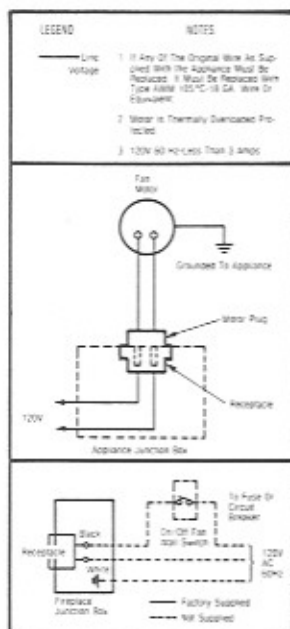

(Fan Wiring Diagram)

Figure 25

Optional Trim Package

There are four optional trim kits for use with the GDV-5000: Model 35HTK-SPB (solid polished brass), Model 35HTK-PB (plated polished brass), Model 35HTK-AB (plated antique brass) and Model 35HTK-SPS (solid polished stainless steel). Refer to the specific installation instructions packed with each trim kit for their proper use.

Horizontal Trim Installation

Remove the four (4) black louver strips and the two (2) brass cover pieces from the protective container and fasten to the face of the appliance. The louver strips snap onto the louver pegs without the need for tools. To assemble the louver strips, tilt the strip on top of the pegs and snap lower edge to lock in place. The brass cover pieces are mounted over the support bars directly above and below the fireplace opening. They also snap in place.

A gas valve cover is included in the homeowners information kit envelope to hide the gas controls located in the lower left louvered area. Slide cover onto lower center louver and position so as to conceal controls (Figure 26).

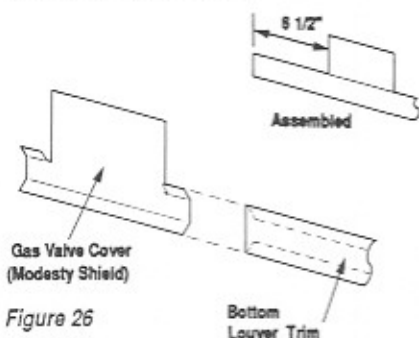

Figure 26

FINISHED WALL DETAILS

Complete finished interior wall and surround. To install the appliance facing flush with the finished wall, position framework to accommodate the thickness of the finished wall (Figures 26 and 27).

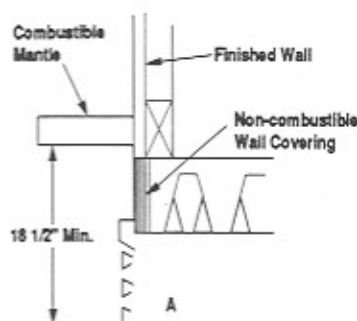

Figure 27

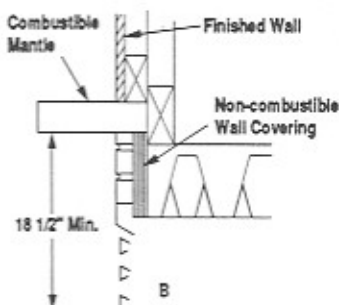

Figure 28

It is not necessary to install a hearth extension with this gas appliance. If a hearth extension is used, do not block the lower louvered area. Any hearth extension used is for appearance only and need not conform to normal fireplace specifications.

A combustible mantel shelf projecting a maximum of 8" from the wall may be installed a minimum distance of 18 1/2" above the fireplace opening (Figure 29).

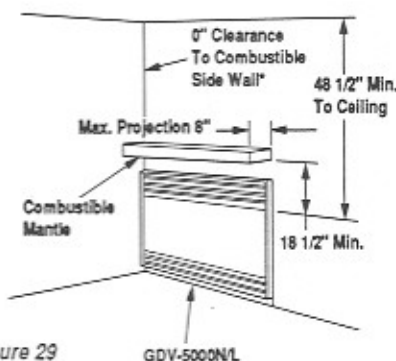

Figure 29

*Note: For Canadian installations, 6" clearance to combustible side wall required.

COLD CLIMATE INSULATION

If you live in a cold climate, seal all cracks around your fireplace with non-combustible material and wherever cold air could enter the room. It is especially important to insulate outside chase cavity between studs and under floor on which fireplace rests, if floor is above ground level.

Surround material must be caulked where it meets the black metal facing of the fireplace to avoid air intrusion. Use non-combustible caulking material only on fireplace facing to seal.

HIGH ELEVATION DERATING

When installing these appliances at high altitudes, it is recommended that the burner be derated by changing the existing orifice to a smaller one. For U.S. installations, derating should be done above the 4,000 feet level; for Canada installations, above the 2,000 feet level. Order and install appropriate high altitude orifice kit (Figure 29).

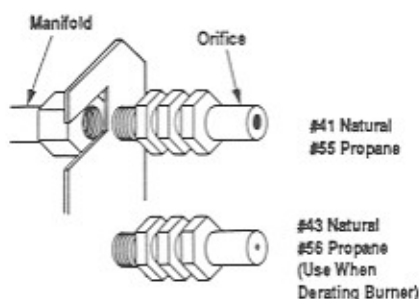

Figure 30

GLASS ENCLOSURE REMOVAL PROCEDURE

The gasketed glass enclosure panel must be removed for access to the pilot and burner area, to install logs or for cleaning the glass. To remove, follow this procedure:

Step 1. Be certain burner and pilot are turned "Off" and that the appliance and glass enclosure panel are cool to the touch.

Step 2. Remove the decorative mesh screen panels by removing the two (2) screen rod retention screws located top center of the fireplace opening (Figure 30). Save the rods, screws and screen panels for re-installation later.

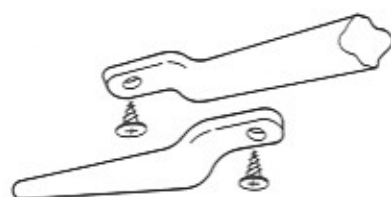

Figure 31

Step 3. Using a 5/16" open end wrench, loosen but do not remove three acorn nuts along the bottom glass retainer (Figure 31).

Step 4. Remove remaining 9 acorn nuts (3 on each vertical side retainers and 3 on the top retainer) (Figure 31).

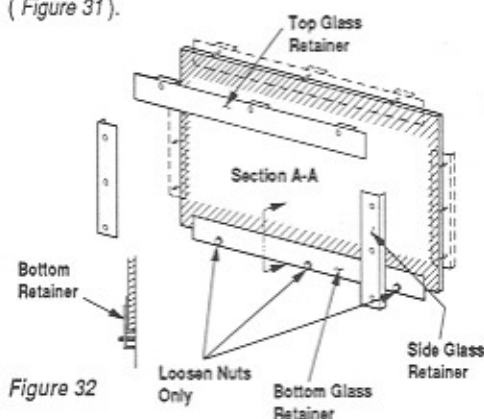

Figure 32

Step 5. Remove top and side glass retainers while holding glass in place with other hand. Do not remove bottom glass retainer.

Step 6. Carefully tilt glass back and lift up and out.

WARNING: HANDLE GLASS WITH CARE! THIS TEMPERED SAFETY GLASS IS SUSCEPTIBLE TO EDGE DAMAGE - DO NOT NICK EDGES WHILE HANDLING.

To Reinstall Glass Enclosure Panel:

Step 1. Position glass panel with red gasket seal toward appliance and wide black painted border at the bottom.

Step 2. Position glass onto tabs behind bottom retainer. The glass panel must be centered over the fireplace opening and must not touch bottom or side threaded studs.

IMPORTANT: GLASS MUST BE CENTERED AND MUST REST ON THESE TABS AND NOT ON THE THREADED STUDS. WHEN REINSTALLING GLASS, DO NOT DAMAGE SAFETY MICRO SWITCH IN LOWER LEFT CORNER.

Step 3. Install remaining three glass retainers and acorn nuts previously removed.

Step 4. Re-install decorative mesh screen rods and panels.

LOG INSTALLATION

Step 1. Remove glass enclosure panel (as specified previously).

Step 2. Carefully position and center lower logs onto burner with the larger log in front. These logs will "surround" the ceramic colorization rod located on the burner (Figure 32).

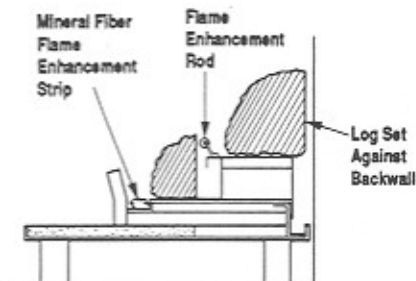

Figure 33

Step 3. Place the smaller logs across the two lower logs onto the grooves provided (Figures 33 and 34).

Note: Be certain that log set is centered and positioned against back wall of appliance and that the smaller logs are in the correct position.



Figure 34



Figure 35

Step 4. Replace the glass enclosure panel as previously described.

OPERATION

To operate the appliance, refer to the lighting instructions on page 8 or on the information panel located in the lower left corner of the control area, behind the louvers.

Your appliance control system is a millivolt type. It consists of a pilot burner, piezo ignition, a gas control valve and an On/Off switch. Additionally, there is a safety micro switch behind the lower left corner of the glass enclosure. The main burner will not operate unless the glass enclosure is in place which closes the micro switch.

To obtain proper operation, it is imperative that the pilot and main burner flame characteristics are steady, not lifting or floating, and be blue in color (Figure 36).

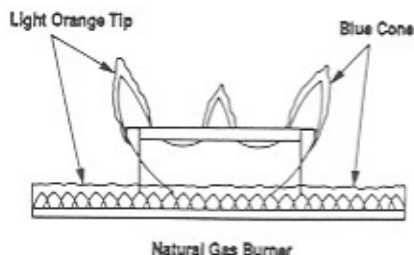

Figure 36

Note: For propane use, air shutter must be open 1/4 inch (Figure 39).

Approximately the top 3/8" at the pilot generator (thermopile) should be engulfed in the pilot flame (Figure 36).

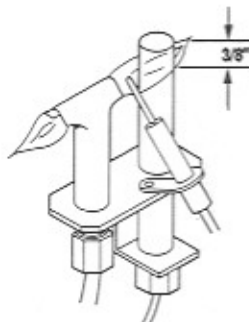

Figure 37

The air shutters on the venturi tube have been set at the proper position at the factory for both natural and propane gas units. The air shutter for natural gas has been set in a full open position (Figures 37 and 38).

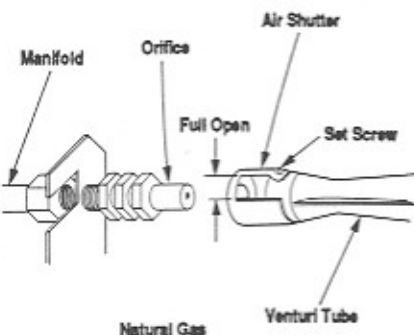

Figure 38

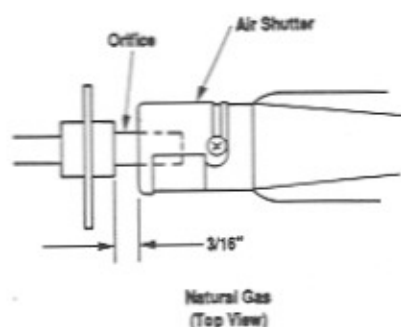

Figure 39

The air shutter for propane has been set in the half open, or 1/4" opening (Figures 39 and 40).

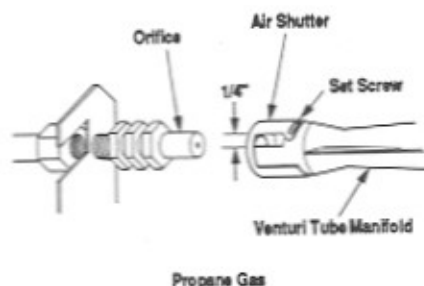

Figure 40

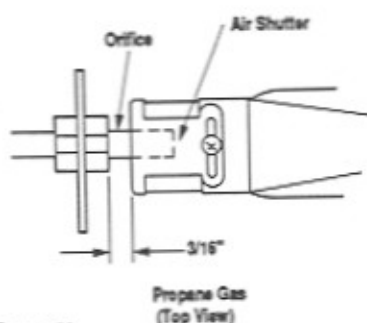

Figure 41

Any variation at these air shutters may result in an erratic flame and/or the possibility of sooting, distinguished by a bright yellow flame. Any adjustments to the air shutter different from that described above could cause the burner assembly to malfunction and could void the warranty.

OPERATION GUIDELINES AND MAINTENANCE INSTRUCTIONS

1. There is a micro switch behind the lower left corner of the glass enclosure panel. This safety feature prevents the burner from operating unless the glass panel is in place.

2. Upon completing your gas line connection, a small amount of air will be in the lines. When first lighting the appliance, it will take a few minutes for the lines to purge themselves of this air. Once purging is complete, the pilot and burner will light and operate as indicated in the instruction manual. Subsequent lightings of the appliance will not require such purging.

3. When lit for the first time, the appliance will emit a slight odor for an hour or two. This is due to the "curing" of the logs and "burn-in" of internal paints and lubricants used in the manufacturing process.

4. Upon each lighting of the appliance, condensation will occur and fog the inside of the glass enclosure. This condensation will disappear in a few minutes as the appliance heats up.

5. Keep control compartment, logs, burners and area surrounding the logs clean by vacuuming or brushing at least twice a year. Do not vacuum the mineral wool located in the front of the burner assembly.

CAUTION: THE LOGS CAN GET VERY HOT - HANDLE ONLY WHEN LOGS ARE COOL.

6. Always turn off gas to pilot before cleaning. Before re-lighting, refer to the lighting instructions.

7. The appliance and venting system should be inspected before use or at least annually by a qualified service person.

8. Always keep the appliance area clear and free from combustible materials, gasoline and other flammable liquids.

9. Never obstruct the flow of ventilation air. Keep the front of the appliance clear of all obstacles and materials.

WARNING: CHILDREN AND ADULTS SHOULD BE ALERTED TO THE HAZARDS OF HIGH SURFACE TEMPERATURE AND SHOULD STAY AWAY TO AVOID BURNS OR CLOTHING IGNITION. YOUNG CHILDREN SHOULD BE SUPERVISED WHEN THEY ARE IN THE SAME ROOM AS THE APPLIANCE.

10. The wire mesh fireplace screens are intended for decorative use. However, it is recommended that the screens be closed when the appliance is in use to prevent inadvertent access to the hot glass panel.

MILLIVOLT CONTROL LIGHTING INSTRUCTIONS

1. Turn remote switch to "Off". Turn gas valve knob to "pilot", depress and turn to "Off". Wait five minutes.

2. Turn gas valve knob to "pilot".

3. Hold in depressed position and light pilot by triggering the spark igniter (pushing red button) until pilot lights. Continue holding knob depressed for approximately 1 1/2 minutes until pilot remains lit when knob is released.

4. Turn gas valve knob to "On". Turn remote switch to "On". Burner will come on.

SHUTDOWN INSTRUCTIONS

1. The burner may be turned off by turning remote switch "Off". The pilot will remain lit for return to normal service.

2. For complete shutdown: Turn remote switch "Off". Depress and turn gas valve knob to "Off".

PILOT BURNER ADJUSTMENTS

1. Remove pilot adjustment cap on main valve.

2. Adjust pilot screw to provide properly sized flame (Figure 36).

3. Replace pilot adjustment cap.

MAINTENANCE

IMPORTANT: TURN OFF GAS AND ELECTRICAL POWER BEFORE SERVICING APPLIANCE. IT IS RECOMMENDED THAT A COMPETENT SERVICEMAN PERFORM THESE CHECKUPS AT THE BEGINNING OF EACH HEATING SEASON.

In order to properly clean the burner and pilot assembly, remove the glass enclosure, the logs and expose the burner and pilot assembly.

Cleaning Burner And Pilot

Clean all foreign materials from top of burner and from bottom panel below burner. Check to make sure that burner orifice is clean.

Visually inspect pilot. Brush or blow away any dust or lint accumulations. If pilot orifice is plugged, disassembly may be required to remove any foreign material from orifice or tubing. When appliance is put back in service, check pilot flame patterns with Figure 35.

FLAME COLORIZATION DEVICES

The burner assembly is equipped with a special flame enhancement rod located between the lower logs and a mineral fiber flame enhancement strip across the front (lower) burner parts. These devices colorize the gas flame and produce the "ember effect".

In normal operation, these devices will provide many hours of satisfactory performance. Over time, the orange color will diminish in intensity and it will be necessary to purchase a replacement rod and/or mineral fiber flame enhancement device. These devices are available at nominal charge from your local distributor/dealer or directly from Superior.

WARRANTY

Your gas fireplace is covered by a one year limited warranty. You will find a copy of the warranty in this manual. Please read the warranty to be familiar with its valuable coverage and file it with others you save for future reference.

TROUBLE SHOOTING

With proper installation and maintenance, your new gas fireplace should provide years of trouble free service. If you do experience a problem, trouble shooting guides are provided in this manual. These guides will assist you or a qualified service person in the diagnosis of problems and the corrective action to be taken.

REPLACEMENT PARTS

Contact the factory for questions concerning prices and policies covering replacement parts. Parts will be shipped at prevailing prices. Normally, all parts can be ordered through your Superior distributor or dealer.

When ordering repair parts, always give the following information:

1. The model number of the appliance
2. The part number
3. The description of the part.
4. The installation date of the appliance.

If you have any questions or problems, contact your local distributor/dealer or:

Superior Fireplace Company
4325 Artesia Avenue
Fullerton, CA 92633
(714) 521-7302

GDV-5000 SPECIFICATIONS

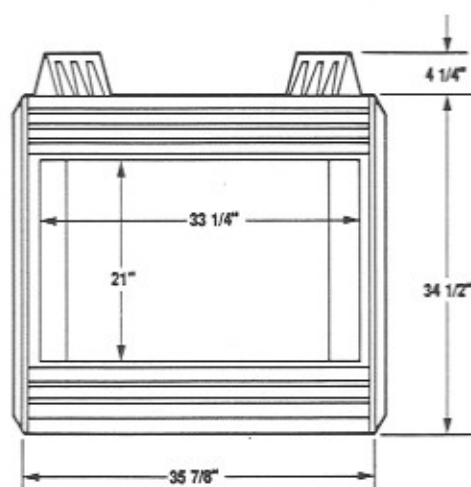

Figure 42

Front

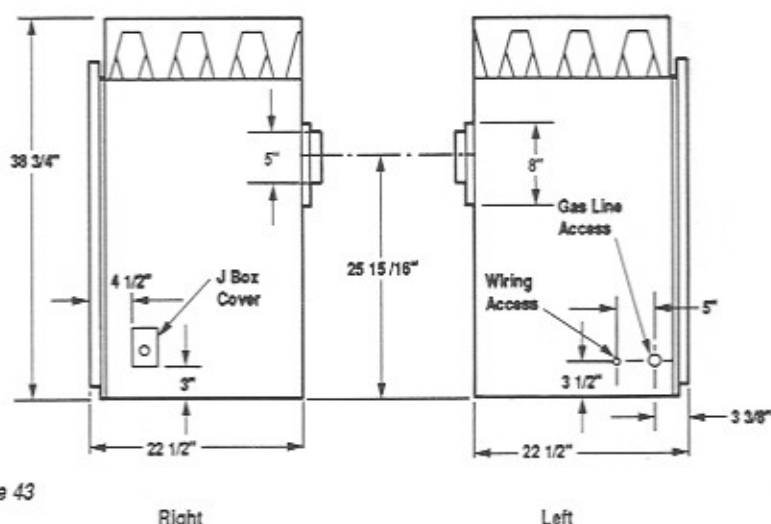

Figure 43

Right

Left

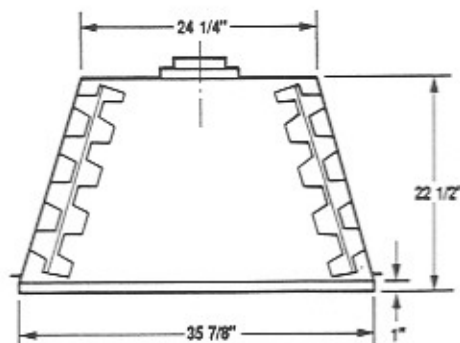

Figure 44

Top

IVATRA 3/6/11 HAD Item 12-16
 Burner flame spreader Assy = 32271

REPLACEMENT PARTS LIST

No.	DESCRIPTION	GDV-5000N		GDV-5000L	
		Part No.	Qty.	Part No.	Qty.
1.	Gas Fireplace Assembly	031141	1	031142	1
2.	Black Louver Bar	024501	4	024501	4
3.	Top Bar	024491	1	024491	1
4.	Trim Upper/Lower	024151	2	024151	2
5.	Acorn Nuts	094581	12	094581	12
6.	Door Micro Switch	094468	1	094468	1
7.	Screen Rod	011381	2	011381	2
8.	Screen Panel	090673	2	090673	2
9.	Front/Rear Log Assembly (Main Log)	028121	1	034111	1
10.	Top Right Log	028151	1	028151	1
11.	Top Left Log	028141	1	028141	1
12.	Burner Assembly	024981	1	032291	1
13.	Front Flame Enhancement Strip	032631	1	032631	1
14.	Flame Colorization Rod	032351	1	032351	1
15.	Venturi (Gasket Incl.)	093537	1	093537	1
16.	Flame Spreader Assy.	025201	1	025201	1
17.	Wall Switch Kit	025971	1	025971	1
18.	Refractory	024931	1	024931	1
19.	Top Glass Retainer	031441	1	031441	1
20.	Side Glass Retainer	031461	2	031461	2
21.	Bottom Glass Retainer	031431	1	031431	1
22.	Glass Enclosure Panel Assy.	031581	1	031581	1
23.	Gas Valve Cover	032381	1	032381	1
24.*	Flame Enhancement Replacement Kit	033711	1	033711	1

ROBERTSHAW CONTROLS

No.	GAS CONTROL DESCRIPTION	GDV-5000N		GDV-5000L	
		Part No.	Qty.	Part No.	Qty.
25.	Gas Control Valve (Robertshaw #7000 MVRLC)	009737	1	093771	1
26.	Piezo Ignitor	091301	1	091301	1
27.	Control Panel Sub-assembly	031631	1	031631	1
28.	Pilot Assembly	093761	1	093762	1
29.	Pilot Generator (Thermopile) TP-75	094527	1	094527	1
30.	Burner Orifice #41 (natural) #55 (propane)	094481	1	094482	1
31.	Fitting, Liquid Tight	094499	4	094499	4
32.	Union, Bulkhead	094501	1	094501	1
33.	Union, Bulkhead	094502	1	094502	1
34.*	High Altitude Orifice Kit (HAOK-DV5000)	027966	1	027967	1

*Note: Item 34 intended for high altitude installation. Item 24 includes items 13 and 14 in one replacement kit.

Flame Enhancement Rod Holder
 94471 LH
 94472 RH

038831
 DE-Rod Kit

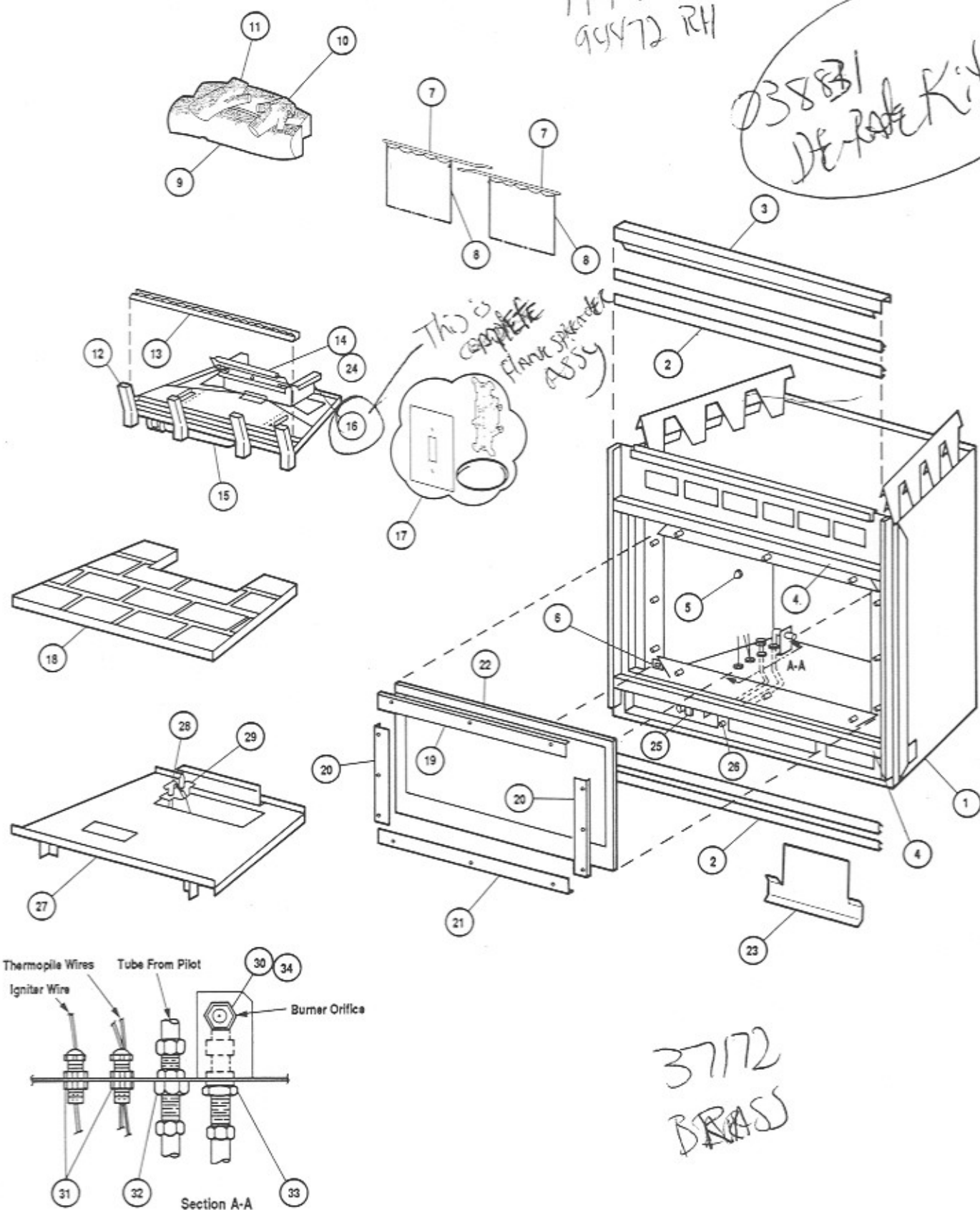

TROUBLE SHOOTING THE GAS CONTROL SYSTEM

MODEL GDV-5000

Note: Before trouble shooting the gas control system, be sure external gas shut off valve located at gas supply inlet is in the "On" position.

SYMPTOM	POSSIBLE CAUSES	CORRECTIVE ACTION
1. Spark ignitor will not light pilot after repeated triggering of red button.	A. Defective ignitor (no spark at electrode).	Check for spark at electrode and pilot; if no spark and electrode wire is properly connected, replace ignitor.
	B. Defective or misaligned electrode at pilot (spark at electrode).	Using a match, light pilot. If pilot lights, turn off pilot and trigger the red button again. If pilot lights, an improper gas mixture caused the bad lighting and a longer purge period is recommended. If pilot will not light - check gap at electrode and pilot - should be 1/8" to have a strong spark. If okay, replace pilot (Figure 36).
2. Pilot will not stay lit after carefully following lighting instructions.	A. Defective pilot generator (thermopile) or remote wall switch.	<ol style="list-style-type: none"> 1. Check pilot flame, must impinge on pilot generator (Figure 36). Clean and/or adjust pilot for maximum flame impingement on generator. 2. Be sure wire connections from generator at gas valve terminals are tight and generator is fully inserted into pilot bracket. 3. One of the wall switch wires may be grounded. Remove wall switch wires from valve terminals if pilot now stays lit. Trace wall switch wiring for ground. May be grounded to appliance or gas supply. 4. Check pilot generator with millivolt meter. Take reading at generator terminals of gas valve. Should read 325 millivolts minimum while holding valve knob depressed in pilot position and wall switch "Off". Replace faulty pilot generator if reading is below specified minimum.
	B. Defective automatic valve operator.	Turn valve knob to "On", place wall switch to "On" millivolt meter should read greater than 100 M.V. If the reading is okay and the burner does not come on, replace the gas valve.
3. Pilot burning, no gas to burner, Valve knob "On", Wall Switch "On".	A. Wall switch or wires defective.	Check wall switch and wires for proper connections. Jumper wire across terminals at wall switch, if burner comes on, replace defective wall switch. If okay, jumper wires across wall switch wires at valve, if burner comes on, wires are faulty or connections are bad.
	B. Pilot generator may not be generating sufficient millivoltage.	Re-check Symptom #2.
	C. Plugged burner orifice.	Check burner orifice for stoppage and remove.
	D. Defective glass micro switch (located at lower left corner of glass panel).	<ol style="list-style-type: none"> 1. Remove glass panel (see instructions). 2. Remove Two (2) screws from switch mounting bracket, pull switch out. 3. Jumper wire across terminals of switch. 4. If burner comes on, switch defective. Replace.
4. Frequent pilot outage problem.	A. Pilot flame may be too low or blowing (high) causing the pilot safety to drop out.	Clean and/or adjust pilot flame for maximum flame impingement on pilot generator (Figure 36).

GDV-5000 ACCESSORIES

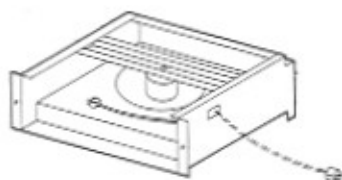

Forced Air Kit

FAK-1500



Horizontal Trim Kit

35HTK-SPS
35HTK-SPB
35HTK-PB



Horizontal Trim Kit

35HTK-AB

GDV-5000 COMPONENTS



45° Vent
Terminal Elbow

GDV-45

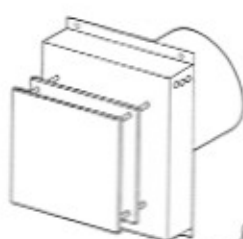

Vent Terminal Kit

GDV-TK
GDV-TK2

Superior GDV-5000 Direct Vent Gas Fireplaces Limited Warranty 1 Year

THE WARRANTY

Superior Fireplace Company warrants this 5000 Series Decorative Gas Appliance to be free from defects in materials and workmanship at the time of manufacture.

REMEDY AND EXCLUSIONS

The coverage of this Warranty is limited to all components of the decorative gas appliance manufactured by Superior Fireplace Company with the exception of mineral fiber flame enhancement strips, flame colorization rods, cement logs, and the glass enclosure panel.

This Warranty only covers Superior decorative gas appliances installed in the United States or Canada.

If the decorative gas appliance covered by this Warranty is found to be defective within one year from the date of installation (see Superior's right of investigation outlined below), Superior will, at its option, replace or repair defective components of the decorative gas appliance manufactured by Superior Fireplace Company at no charge, and will also pay for reasonable labor costs incurred in replacing or repairing such components. If repair or replacement is not commercially practical, Superior will, at its option, refund the purchase price of the Superior decorative gas appliance. With respect to the glass enclosure panel, the remedies of this paragraph are available for 90 days from the date of installation.

This warranty covers only parts and labor as provided above. In no case shall Superior Fireplace Company be responsible for materials, components, or construction which are not manufactured or supplied by Superior Fireplace Company, or for the labor necessary to install, repair or remove such materials, components or construction. All replacement or repair components will be shipped F.O.B. the nearest Superior Fireplace Company factory.

QUALIFICATIONS TO THE WARRANTY

The decorative gas appliance Warranty outlined above is further subject to the following qualifications:

- (1) The decorative gas appliance must be installed in accordance with Superior Fireplace Company installation instructions and local building codes. The Warranty on this Superior decorative gas appliance covers only the component parts manufactured by Superior Fireplace Company. The use of components manufactured by others with this Superior decorative gas appliance could create serious safety hazards, may result in the denial of certification by recognized national safety agencies, and could be in violation of local building codes. This warranty does not cover any damages occurring from the use of any components not manufactured or supplied by Superior Fireplace Company.
- (2) The Superior decorative gas appliance must be subjected to normal use. The decorative gas appliances are designed to burn either natural or propane gas only. Burning conventional fireplace fuels such as wood, coal, or any other solid fuel will cause damage to the decorative gas appliance, will produce excessive temperatures and will result in a fire hazard.

LIMITATION ON LIABILITY

It is expressly agreed and understood that Superior Fireplace Company's sole obligation and purchaser's exclusive remedy under this warranty, under any other warranty, expressed or implied, or in contract, tort or otherwise, shall be limited to replacement, repair, or refund, as specified above.

In no event shall Superior Fireplace Company be responsible for any incidental or consequential damages caused by defects in its products, whether such damage occurs or is discovered before or after replacement or repair, and whether or not such damage is caused by Superior Fireplace Company's negligence. Some states do not allow the exclusion or limitation of incidental or consequential damages, so the above limitation or exclusion may not apply to you. The duration of any implied warranty with respect to this Superior decorative gas appliance is limited to the duration of the foregoing warranty. Some states do not allow limitations on how long an implied warranty lasts, so the above may not apply to you.

INVESTIGATION OF CLAIMS AGAINST WARRANTY

Superior Fireplace Company reserves the right to investigate any and all claims against this Warranty and to decide upon method of settlement.

SUPERIOR FIREPLACE COMPANY NOT RESPONSIBLE FOR WORK DONE WITHOUT WRITTEN CONSENT

Superior Fireplace Company shall in no event be responsible for any warranty work done without first obtaining Superior's written consent.

DEALERS HAVE NO AUTHORITY TO ALTER THIS WARRANTY

Superior Fireplace Company's employees and dealers have no authority to make any warranties nor to authorize any remedies in addition to or inconsistent with those stated above.

HOW TO REGISTER A CLAIM AGAINST WARRANTY

In order for any claim under this Warranty to be valid, Superior Fireplace Company must be notified of the claimed defect in writing or by telephone to Superior Fireplace Company, attention Customer Service Department, 4325 Artesia Avenue, Fullerton, California 92633. Telephone: (714) 521-7302, as soon as reasonably possible after the defect is discovered. Claims against this Warranty in writing should include the date of installation, and a description of the defect.

OTHER RIGHTS

This Warranty gives you specific legal rights, and you may also have other rights which vary from state to state.

Superior reserves the right to make changes at any time, without notice, in design, materials, specifications, prices and also to discontinue colors, styles and products.

Distributed by:

SUPERIOR.
The Fireplace Company

4325 Artesia Avenue
Fullerton, CA 92633

Plants in Fullerton, CA,
Union City, TN