



OPERATING INSTRUCTIONS AND OWNER'S MANUAL

Model #

MH11Q

READ INSTRUCTIONS CAREFULLY: Read and follow all instructions. Place instructions in a safe place for future reference. Do not allow anyone who has not read these instructions to assemble, light, adjust or operate the heater.

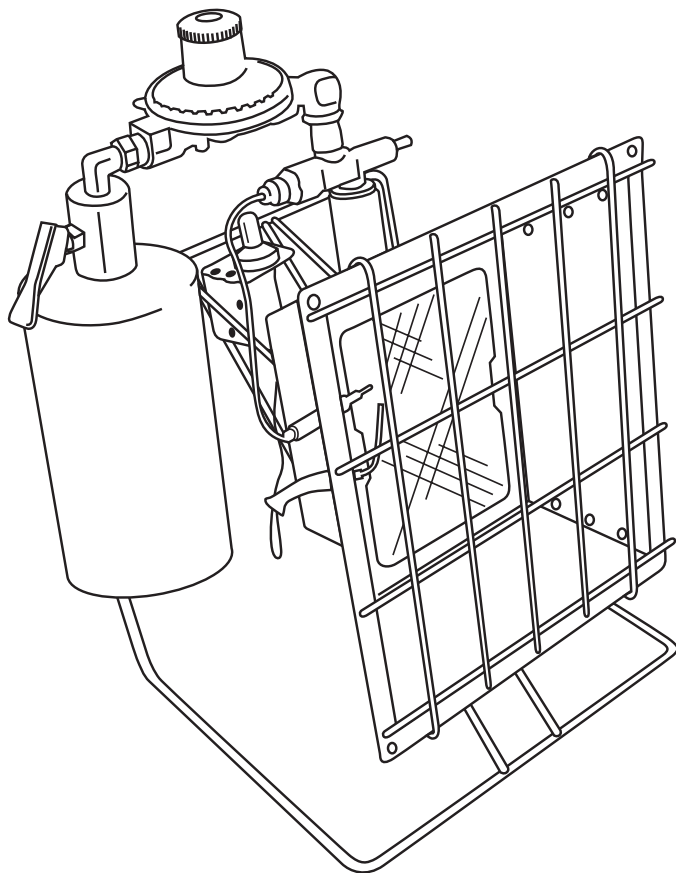

Model - MH11Q
**GAS-FIRED INFRA-RED
PORTABLE HEATER**
(Propane Cylinder Not Included)

⚠ FOR YOUR SAFETY:

- Carefully read instructions before lighting heater. Place instructions in a safe place for future reference.
- Do not store or use gasoline or other liquids with flammable vapors in the vicinity of this or any other appliance.
- If you smell gas:
 1. Evacuate enclosure.
 2. Call for professional help.

⚠ WARNING: CARBON MONOXIDE CAN KILL YOU!

Using a portable gas camping heater inside a tent, RV, camper, vehicle, shelter or other enclosed areas can produce deadly carbon monoxide.

⚠ DO NOT LEAVE HEATER UNATTENDED OR IN OPERATION WHILE SLEEPING.

CONTENTS

Hook-Up Information 3

General Information 4

For Safe Operation 4

Ventilation 4

Minimum Clearance from Combustible Material 1,5

Assembly Procedure 5

Lighting Instructions 5

Shutdown and Storage Instructions 6

Parts List 6

SPECIFICATIONS

MODEL NO. MH11Q

GAS TYPE PROPANE

INPUT BTU/HR. 11,000

CLEARANCES TO COMBUSTIBLES

FROM C.L. of HTR.to FLOOR 18"

SIDES 30"

REAR 30"

CEILING 30"

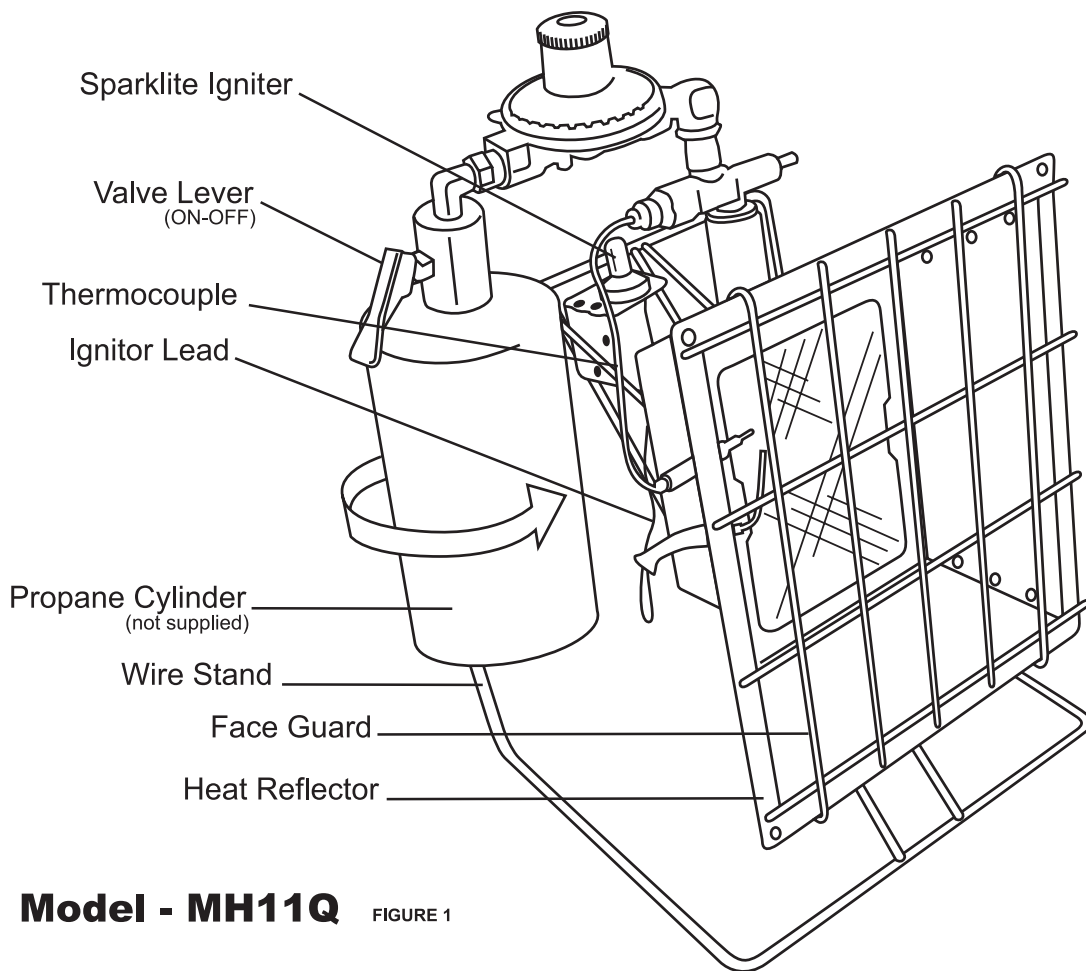

HOOK-UP INFORMATION

1. Heater model MH11Q is packaged completely assembled. Propane cylinders are not included with model MH11Q.
2. Remove heater from carton.
3. Hold heater in one hand and with the other hand hold propane cylinder vertically and carefully turn clockwise into heater valve until snug. (Careful not to cross-thread) – Figure 1.
4. Use only LP-gas cylinders constructed for use with propane only (HD-5) and marked in accordance with the specifications for LP-gas cylinders of the U.S. Department of Transportation (DOT Spec. 39).
5. Use propane fuel cylinders of not more than 75 cubic inches (2-1/2 pounds nominal water capacity) and connect to cylinder valve outlet connection No. 600 as specified in the Compressed Gas Associations Limited Standard Cylinder Valve Outlet Connection for propane-small valve series.

⚠ WARNING

- Never touch heater while in operation to avoid injury. *Move heater by grasping the propane cylinder carefully.*
- Read pages 3 and 4 before lighting heater.

⚠ WARNING

- **STOP-LOOK-READ-UNDERSTAND** these warning instructions to avoid serious injury, fire, asphyxiation or death.
- **DO NOT LEAVE HEATER UNATTENDED OR IN OPERATION WHILE SLEEPING.**
- **NOTE: DO NOT USE MATCHES FOR LEAK TESTING. USE ONLY SOAP SOLUTION.**

GENERAL INFORMATION

A. The Mr. Heater MH11Q is a low pressure propane appliance and is designed to be connected to a 14.1 or 16.4 ounce disposable propane cylinder. Every unit is tested during manufacturing and shipped fully assembled.

B. These heaters are equipped with an automatic Safety Shutoff valve. The gas flow will automatically stop if the heater fails to operate for any reason.

C. Maximum safety and convenience have been built into the Valve. The following table lists the approximate BTU's consumed and the operating hours you can reasonably expect from bulk propane cylinders.

D. Model MH11Q is equipped with an Igniter for convenient heater lite-off.

Valve Position	BTU Input	Cylinder 14.1 oz.	Cylinder 16.4 oz.
ON	11,000	1.6 hours	1.8 hours

FOR SAFE OPERATION

A. READ INSTRUCTIONS CAREFULLY: Read and adhere to these instructions. Do not allow anyone who has not read the instructions to assemble, light, adjust or operate the heater.

⚠ WARNING: KEEP THE HEATER OUT OF THE REACH OF CHILDREN

B. PROPANE IS VERY FLAMMABLE: In the event of a leak, propane will accumulate and the possibility of a fire is present. Propane gas is scented and its strong odor is readily detectable. Never strike a match or bring any flame or create an electric spark in an enclosure when you smell propane gas. Ventilate the area thoroughly, move the heater outside, find and correct the source of the leak before attempting to light any appliance. If you are unsure of these instructions evacuate immediately and call for help.

C. GAS LEAKAGE: If the leak cannot be corrected, do not tamper with the heater; follow the shut down instructions and return the heater to the dealer or address given on last page.

⚠ WARNING: DO NOT STORE PROPANE CYLINDERS NEAR AN OPEN FLAME OR HEAT.

D. LEAK DETECTION: Before each use of the heater check all fittings and connections with a soap solution to be sure there are no leaks. NEVER, NEVER USE ANY FLAME FOR LEAK TEST.

E. CONNECTING HEATER TO PROPANE CYLINDER: Always connect the heater to the cylinder in the outdoors or in a well ventilated area. NEVER connect this heater to a cylinder near an open flame.

F. USE OF HEATER: Always operate the heater with the propane cylinder in an upright position on a level noncombustible surface. NEVER place the cylinder on its side when operating the heater. In cooking position cylinder must be 30 degrees from horizontal.

G. ATTEND HEATER: Do not leave heater unattended while it is in operation.

H. ALWAYS LIGHT HEATER WITH MATCH or "Sparklite" ignitor.

I. DO NOT TAMPER: Should the heater not perform properly, such as little or no heat when operating in the "ON" position, or for any other reason, DO NOT ATTEMPT TO REPAIR OR TAMPER with the heater. Any tampering could make the use of the heater unsafe and dangerous. Return the heater to the dealer or the address given on last page for repair or replacement.

J. FOR STORAGE: The heater ON-OFF valve should always be turned to "Off" when the heater is not in use. Allow at least 15 minutes for cooling before handling and storing. Detach propane cylinder from heater before storing. DO NOT store propane cylinders near open flame or heat.

K. DO NOT TRANSPORT OR MOVE APPLIANCE WHILE IN OPERATION OR WHILE HEATER IS ATTACHED. FOLLOW SHUTDOWN AND STORAGE INSTRUCTIONS TO TRANSPORT OR MOVE THIS APPLIANCE.

L. CAUTION: Do not expose tile to moisture or water.

The State of California requires the following warning:

⚠ WARNING: COMBUSTION BY-PRODUCTS PRODUCED WHEN USING THIS PRODUCT CONTAIN CARBON MONOXIDE, A CHEMICAL KNOWN TO THE STATE OF CALIFORNIA TO CAUSE CANCER AND BIRTH DEFECTS (OR OTHER REPRODUCTIVE HARM).

VENTILATION

A. WARNING: This heater is an unvented appliance and MUST be used ONLY in a well ventilated area. NEVER attempt to operate the heater inside any vehicle, camper or enclosure.

B. Any combustion process requires and consumes oxygen, and will produce carbon monoxide. THIS HEATER MUST BE USED WITH ADEQUATE VENTILATION. Do not use in a tightly enclosed area. Two openings directly to the outdoors MUST be provided. One HIGH and one LOW. Preferably on opposite sides of the enclosure. EACH OPENING SHALL HAVE A MINIMUM FREE AREA OF 24 SQUARE INCHES (6" X 4"). Structures of tight construction or tents using fire retardant materials will require larger openings. If any additional fuel

burning appliances are operated, ALWAYS provide additional ventilation. Increase the area of each opening by at least 2 square inches for each 1,000 BTU's per hour of additional input rating.

MINIMUM CLEANANCE FROM COMBUSTIBLE MATERIALS

A. When operating, the heater surfaces are extremely hot. Keep sleeping bags, clothing, and all combustible materials clear of the heater by at least the distances shown on page 2.

B. WARNING: Provide ample ventilation. This heater consumes air (oxygen). Do not use this heater in unventilated structures to avoid endangering your life. Provide additional ventilation for any additional fuel-burning appliances and additional occupants.

C. WARNING: To avoid injury or property damage never allow clothing, tents or other combustible material within 30" of the heater. This heater must be located at least 18" above the floor level when in use. Never operate the heater when sleeping.

D. WARNING: Never direct the heat output of this heater toward any propane tank within 20 feet.

ASSEMBLY PROCEDURE

A. Make sure the lever on the heater is "off" by placing lever down to the "OFF" position.

B. Carefully screw disposable cylinder hand tight into the inlet tapping of valve. Make sure gas cylinder is in upright position.

C. Make sure the heater is firmly placed in the metal stand.

D. Make sure knurled lock nut is tightened securely – Figure 1.

LIGHTING INSTRUCTIONS

A. Before attempting to light the heater, check all fittings and connections with a soap solution. NEVER USE A MATCH TO CHECK FOR LEAKS. Should a gas leak occur, do not attempt to repair or use heater. Return the heater to your dealer or the address given on last page.

B. Fuel – This heater must be used with propane fuel cylinders as stated in paragraph 4 and 5 on page 2.

⚠ WARNING: USE HD.5 PROPANE GAS ONLY. DO NOT USE ANY OTHER TYPE FUEL. SEE YOUR PROPANE DEALER IF YOU HAVE ANY QUESTIONS REGARDING FUEL.

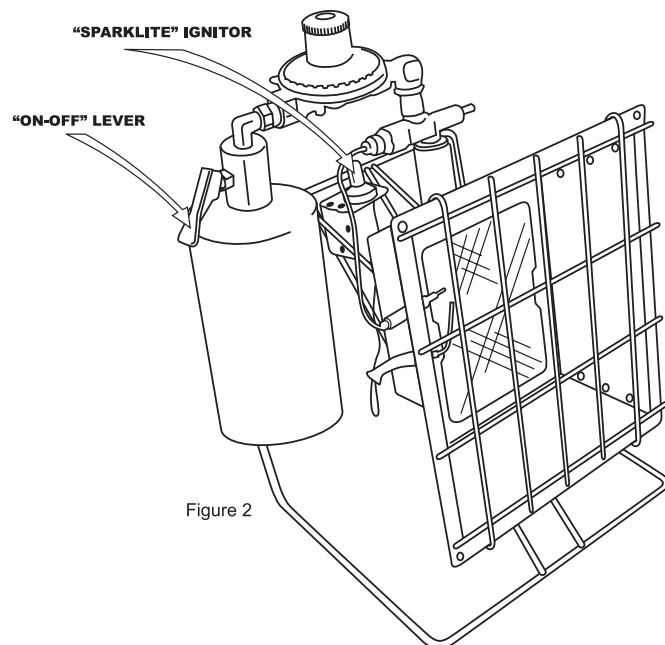

C. Turn the heater's "ON-OFF" lever to "ON".

D. To light, press "Sparklite" Ignitor and valve button on the safety shut-off valve at the same time. (See fig. 2) After the heater is lit, continue to hold valve button in for 30 seconds, then release the button slowly. CAUTION: DO NOT PUSH IN VALVE BUTTON BEFORE DEPRESSING SPARKLITE.

E. If burner does not light within 30 seconds, turn the heater's valve lever to "off" and allow at least five minutes for gas to dissipate before attempting to relight.

F. NOTE: Should the orifice become clogged as indicated by low volume of gas when operating in "ON" with a full cylinder, or should the heater fail to operate properly for any reason, return the heater to the dealer or the address given on last page for repair or replacement. DO NOT ATTEMPT TO REPAIR OR TAMPER WITH HEATER.

SHUTDOWN AND
STORAGE INSTRUCTIONS

- A.** The valve should ALWAYS be completely turned “OFF” when the heater is not in use.
- B.** When shutting off the heater, turn the heater’s valve lever to “OFF”. (See Figure 5)
- C. CAUTION:** After turning unit off, heater will remain extremely hot. Allow at least 15 minutes for cooling before handling and storing. Detach heater from cylinder before handling and storage.
- D. HEATER STORAGE:** Always remove the propane cylinder from the heater when not in use. Always store propane cylinders in a cool, well ventilated place away from any flame or heat and in a location not used for habitation. DO NOT STORE PROPANE CYLINDER WITHIN 50 FT. OF OPEN FLAME OR HEAT.
- E.** See Figure 6 for spare parts list

Replacement Parts List
for Heater Model MH11Q

ITEM	STOCK NO.	DESCRIPTION
1	73530	Replacement Safety Shutoff with Orifice Assembly
2	73532	Thermocouple Lead – 12”
3	73533	Tile Assembly
4	73534	Replacement Valve
5	73535	Plenum Assembly with Clip
6	73509	Wire Face Guard
7	75113	Knurled Lock Nut
8	73507	Reflector
9	73536	Square Metal Stand
10	73531	Orifice
11	73235	“Sparklite” Ignitor Assembly
12	73506	Electrode Assembly

Cooking Position

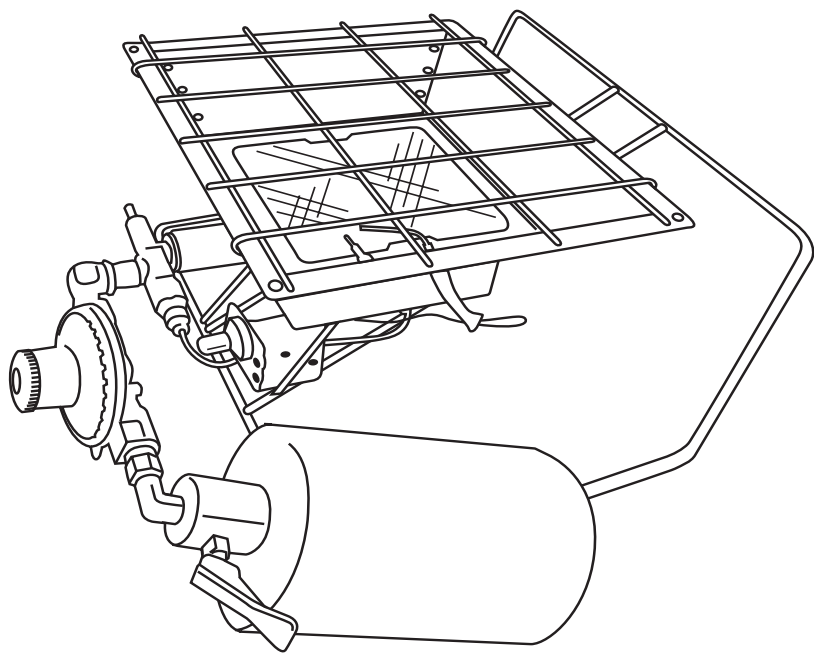

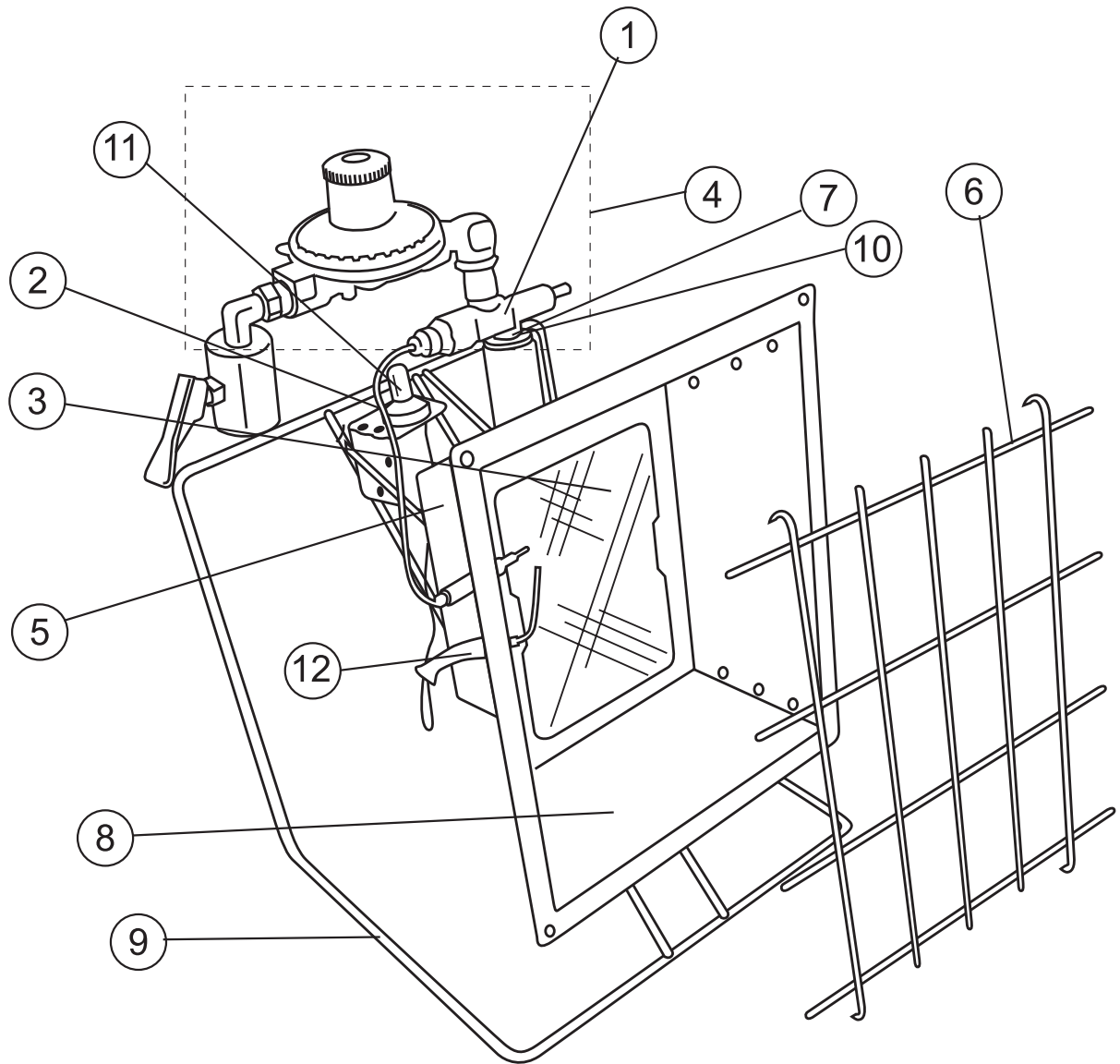



OPERATING INSTRUCTIONS AND OWNER'S MANUAL

Model #

MH11Q

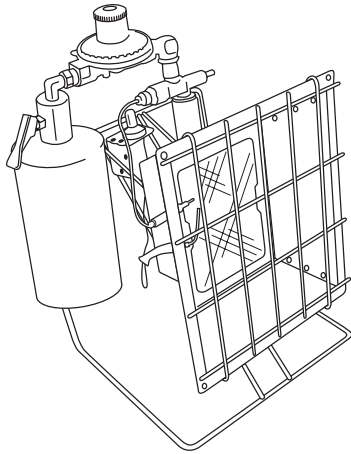

WARNING:

USE ONLY MANUFACTURER'S REPLACEMENT PARTS. USE OF ANY OTHER PARTS COULD CAUSE INJURY OR DEATH. REPLACEMENT PARTS ARE ONLY AVAILABLE DIRECT FROM THE FACTORY AND MUST BE INSTALLED BY A QUALIFIED SERVICE AGENCY.

PARTS ORDERING INFORMATION:

PURCHASING: Accessories may be purchased at any ENERCO GROUP, INC local dealer or direct from the factory.

FOR INFORMATION REGARDING SERVICE

Please call Toll-Free 800-251-0001
www.mrheater.com

Our office hours are 8:30 AM – 5:00 PM, EST, Monday through Friday.

Please include the model number, date of purchase, and description of problem in all communication.

LIMITED WARRANTY

ENERCO GROUP, INC. warrants its heaters and accessories to be free from defects in material and workmanship for a period of 1 year from date of purchase. ENERCO GROUP, INC. will repair or replace this product free of charge if it has been proven to be defective within the 1-year period, and is returned at customer expense with proof of purchase to ENERCO GROUP, INC. within the warranty period.

ENERCO GROUP, INC reserves the right to make changes at any time, without notice or obligation, in colors, specifications, accessories, materials and models.

ENERCO GROUP, INC., 4560 W. 160TH ST., CLEVELAND, OHIO 44135 • 216-881-5500
Mr. Heater is a registered trademark of Enerco Group, Inc.
© 2004, ENERCO GROUP, INC. All rights reserved