

REMOVE BANJO UNLOADER AND ATTACHED FITTINGS FROM HIGH PRESSURE PORT 1 AND LOW PRESSURE PORT 1
 KEEP FITTINGS SHOWN WITHIN THE BOX FOR REUSE
 REMOVE ADAPTER AND THERMAL RELIEF VALVE FROM LOW PRESSURE PORT 2

BEFORE ASSEMBLY, WRAP ALL MALE THREADS WITH TEFLON TAPE
 IF NOT ALREADY PLUGGED, INSERT STEEL PLUG (7113699) INTO HIGH PRESSURE PORT 2
 CONNECT STEEL ELBOW TO HIGH PRESSURE PORT 1
 CONNECT UNLOADER ASSEMBLY TO THE STEEL ELBOW AS SHOWN
 REUSE THE GARDEN HOSE INLET, CHEMICAL INJECTOR, AND QC SOCKET IF APPLICABLE
 ATTACH HOSE BARB ELBOW AND BYPASS HOSE AS SHOWN

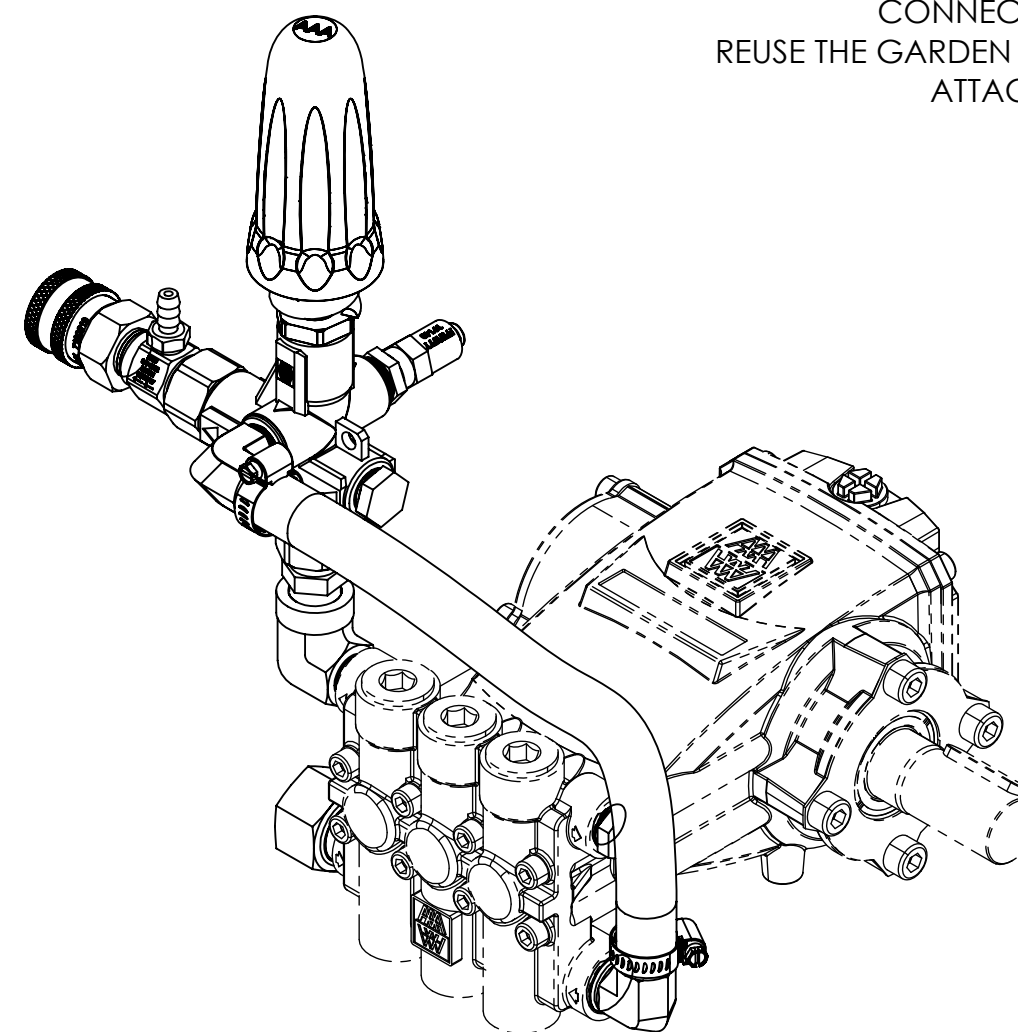

!
 SERVICER MUST CONFIRM PROPER
 UNLOADER ADJUSTMENT AND SET TO
 THE APPROPRIATE PRESSURE AND
 SPIKE SETTINGS.