

DEWALT®



Instruction Manual



Gas Pressure Washer

www.DEWALT.com

If you have questions or comments, contact us.

1-877-362-4271

Definitions: Safety Alert Symbols and Words

This instruction manual uses the following safety alert symbols and words to alert you to hazardous situations and your risk of personal injury or property damage.





-  **DANGER:** Indicates an imminently hazardous situation which, if not avoided, **will** result in **death or serious injury**.
-  **WARNING:** Indicates a potentially hazardous situation which, if not avoided, **could** result in **death or serious injury**.
-  **CAUTION:** Indicates a potentially hazardous situation which, if not avoided, **may** result in **minor or moderate injury**.
-  (Used without word) Indicates a safety related message.
- NOTICE:** Indicates a practice **not related to personal injury** which, if not avoided, **may** result in **property damage**.

Fig. A



- | | |
|----------------------------|-----------------------------|
| 1 Panel assembly | 8 Handle assembly |
| 2 Nozzle holder | 9 High pressure hose |
| 3 Professional spray gun | 10 High pressure pump |
| 4 Wheel | 11 PRESSUREADY® control box |
| 5 Quick-connect spray wand | 12 Battery housing |
| 6 Frame | |
| 7 Engine | |

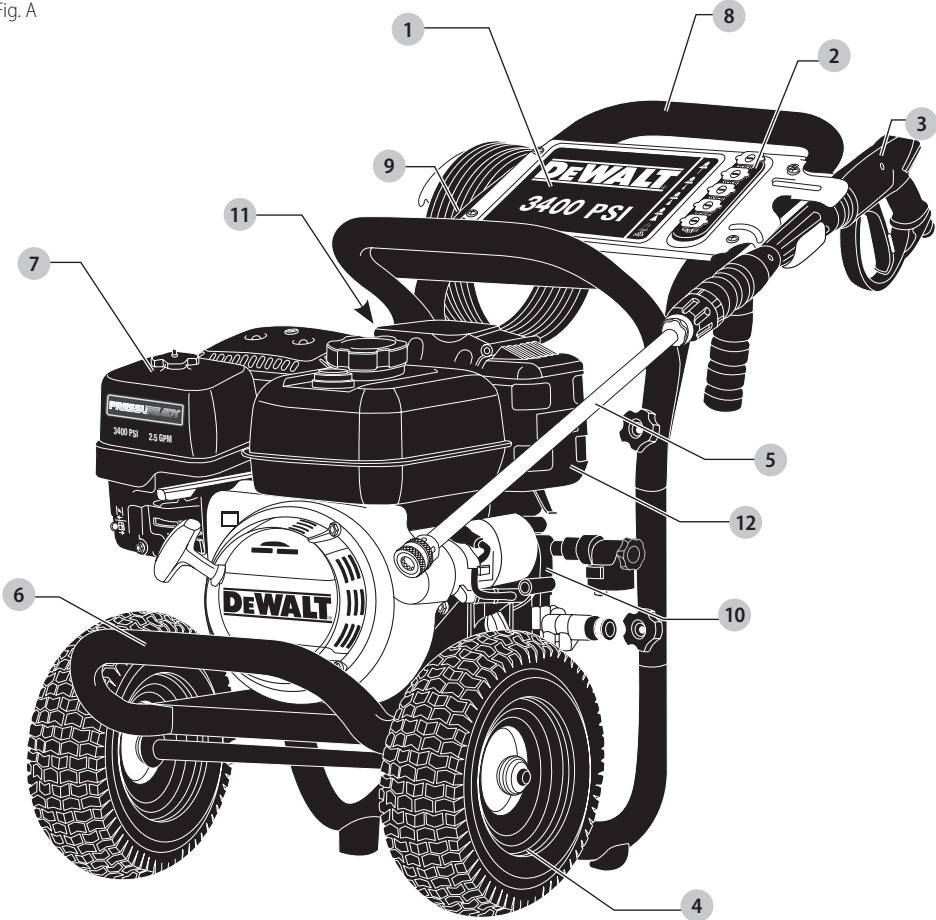

WARNING: Read all safety warnings and all instructions. Failure to follow the warnings and instructions could result in electric shock, fire and/or serious injury.



WARNING: To reduce the risk of injury, read the instruction manual.

IF YOU HAVE ANY QUESTIONS OR COMMENTS ABOUT THIS CONTACT US AT: **1-877-362-4271**

Important Safety Instructions



DANGER: Carbon Monoxide. Using an engine indoors can kill. Engine exhaust contains high levels of carbon monoxide (CO), a poisonous gas you cannot see or smell. You may be breathing CO even if you do not smell engine exhaust.

- **NEVER** use an engine inside homes, garages, crawlspaces or other partly enclosed areas. Deadly levels of carbon monoxide can build up in these areas. Using a fan or opening windows and doors does **NOT** supply enough fresh air.
- **ONLY** use outdoors and far away from open windows, doors and vents. These openings can pull in engine exhaust.
- Even when the engine is used correctly, CO may leak into your home. **ALWAYS** use a battery-powered or battery backup CO alarm in your house. **Read and follow all directions for CO alarm before using.** If you feel sick, dizzy or weak at anytime, move to fresh air immediately. See a doctor. You could have carbon monoxide poisoning.



WARNING: Do not operate this unit until you read this instruction manual and the engine instruction manual for safety, operation and maintenance instructions.



WARNING: When using this product basic precautions should always be followed, including the following:

1. Read all instructions before using the product.
2. To reduce the risk of injury, close supervision is necessary when a product is used near children.
3. **Know how to stop the product and bleed pressures quickly.** Be thoroughly familiar with the controls.
4. Stay alert—watch what you are doing.
5. Do not operate the product when fatigued or under the influence of alcohol or drugs.
6. Keep operating area clear of all persons.
7. **Do not overreach or stand on unstable support.** Keep good footing and balance at all times.
8. Follow the maintenance instructions specified in the manual.



DANGER: RISK OF INJECTION OR SEVERE INJURY. KEEP CLEAR OF NOZZLE. DO NOT DIRECT DISCHARGE STREAM AT PERSONS. THIS PRODUCT IS TO BE USED ONLY BY TRAINED OPERATORS.



WARNING: This product may not be equipped with a spark-arresting muffler. If the product is not equipped and will be used around flammable materials or on land covered with materials such as agricultural crops, forest, brush, grass or other similar items, then an approved spark arrester must be installed and is legally required in the state of California. It is a violation of California statutes section 130050 and/or sections 4442 and 4443 of the California Public Resources Code, unless the engine is equipped with a spark arrester, as defined in section 4442, and maintained in effective working order. Spark arresters are also required on some U.S. Forest Service land and may also be legally required under other statutes and ordinances.



WARNING: This product and its exhaust can expose you to chemicals including lead and lead compounds, and carbon monoxide, which are known to the State of California to cause cancer and birth defects or other reproductive harm. For more information go to www.P65Warnings.ca.gov.

SAVE THESE INSTRUCTIONS



DANGER: RISK OF EXPLOSION OR FIRE

WHAT CAN HAPPEN

- Spilled gasoline and it's vapors can become ignited from cigarette sparks, electrical arcing, exhaust gases and hot engine components such as the muffler.
- Heat will expand fuel in the tank which could result in spillage and possible fire explosion.
- Operating the pressure washer in an explosive environment could result in a fire.

HOW TO PREVENT IT

- Shut off engine and allow it to cool before adding fuel to the tank.
- Use care in filling tank to avoid spilling fuel. Move pressure washer away from fueling area before starting engine.
- Keep maximum fuel level 1/2" (12.7 mm) below bottom of filler neck to allow for expansion.
- Operate and fuel equipment in well-ventilated areas free from obstructions. Equip areas with fire extinguisher suitable for gasoline fires.

- Materials placed against or near the pressure washer can interfere with its proper ventilation features causing overheating and possible ignition of the materials.
- Never operate pressure washer in an area containing dry brush or weeds.



DANGER: RISK OF FLUID INJECTION AND LACERATION

WHAT CAN HAPPEN

- Your pressure washer is equipped with PRESSUREADY®. The pressure washer can be started by simply squeezing the spray gun trigger.
- Your pressure washer operates at fluid pressures and velocities high enough to penetrate human and animal flesh which could result in amputation or other serious injury. Leaks caused by loose fittings or worn or damaged hoses can result in injection injuries. **DO NOT TREAT FLUID INJECTION AS A SIMPLE CUT!** See a physician immediately!

HOW TO PREVENT IT

- The Auto Lock spray gun must be used to help prevent accidental starting. Use only identical replacement parts.
- Inspect the high pressure hose regularly. Replace the hose immediately if it is damaged, worn, has melted from contacting the engine, or shows any signs of cracks, bubbles, pinholes, or other leakage. Never grasp a high pressure hose that is leaking or damaged.
- Never touch, grasp or attempt to cover a pinhole or similar water leak on the high pressure hose. The stream of water IS under high pressure and WILL penetrate skin.
- Never place hands in front of nozzle.
- Direct spray away from self and others.
- Make sure hose and fittings are tightened and in good condition. Never hold onto the hose or fittings during operation.
- Do not allow hose to contact muffler.
- Never attach or remove wand or hose fittings while system is pressurized.
- When using replacement spray wands or guns with this pressure washer, do not use a wand and/or wand/gun combination that is shorter in length than what was provided with this pressure washer as measured from the nozzle end of the spray wand to the spray gun trigger.

- Muffler exhaust heat can damage painted surfaces, melt any material sensitive to heat (such as siding, plastic, rubber, vinyl or the pressure hose, itself), and damage live plants.
- Always keep pressure washer a minimum of 4' (1.2 m) away from surfaces (such as houses, automobiles or live plants) that could be damaged from muffler exhaust heat.

- Improperly stored fuel could lead to accidental ignition. Fuel improperly secured could get into the hands of children or other unqualified persons.
- Store fuel in a CARB (California Air Resources Board) or EPA (Environmental Protection Agency) approved container, in a secure location away from work area.

- Use of acids, toxic or corrosive chemicals, poisons, insecticides, or any kind of flammable solvent with this product could result in serious injury or death.
- Do not spray flammable liquids.



DANGER: RISK TO BREATHING (ASPHYXIATION)

WHAT CAN HAPPEN

- Breathing exhaust fumes will cause serious injury or death! Engine exhaust contains carbon monoxide, an odorless and deadly gas.
- Some chemical/cleaning soaps contain substances which could cause injury to skin, eyes or lungs.

HOW TO PREVENT IT

- Operate pressure washer in a well-ventilated area. Avoid enclosed areas such as garages, basements, etc.
- Never operate unit in or near a location occupied by humans or animals.
- Use only chemical/cleaning soaps specifically recommended for high pressure washers. Follow manufacturers recommendations. Do not use chlorine bleach or any other corrosive compound.

- Injuries can result if system pressure is not reduced before attempting maintenance or disassembly.
- To relieve system pressure, shut off engine, turn off water supply and pull spray gun trigger until water stops flowing.
- Use only accessories rated equal to or higher than the rating of the pressure washer.



! DANGER: RISK OF INJURY FROM SPRAY

WHAT CAN HAPPEN

- High-velocity fluid spray can cause objects to break, projecting particles at high speed.
- Light or unsecured objects can become hazardous projectiles.

HOW TO PREVENT IT

- Always wear ANSI-approved Z87.1 safety glasses. Wear protective clothing to protect against accidental spraying.
- Never point wand at or spray people or animals.
- Always secure trigger lock when wand is not in service to prevent accidental operation.
- Never permanently secure trigger in pull-back (open) position.



! DANGER: RISK OF UNSAFE OPERATION

WHAT CAN HAPPEN

- Unsafe operation of your pressure washer could lead to serious injury or death to you or others.

HOW TO PREVENT IT

- Do not use chlorine bleach or any other corrosive compound.
- Become familiar with the operation and controls of the pressure washer.
- Keep operating area clear of all persons, pets and obstacles.
- Do not operate the product when fatigued or under the influence of alcohol or drugs. Stay alert at all times.
- Never compromise the safety features of this product.

- Do not operate machine with missing or broken parts. Use only identical replacement parts.
- Never leave spray gun/wand unattended while unit is running.

- If proper manual starting procedure is not followed, engine can kickback causing serious hand and arm injury.
- If engine does not start after two pulls, squeeze trigger of gun to relieve pump pressure. Pull starter cord slowly until resistance is felt. Then pull cord rapidly to avoid kickback and prevent hand or arm injury.

- The spray gun/wand is a powerful cleaning tool that could look like a toy to a child.
- Keep children away from the pressure washer at all times.

- Reactive force of spray will cause gun/wand to kickback, and could cause the operator to slip or fall or misdirect the spray. Improper control of gun/wand can result in injuries to self and others.
- Do not overreach or stand on an unstable support.
- Do not use pressure washer while standing on a ladder.
- Grip gun/wand firmly with both hands. Expect the gun to kickback when triggered.



! DANGER: RISK OF INJURY OR PROPERTY DAMAGE WHEN TRANSPORTING OR STORING

WHAT CAN HAPPEN

- Fuel or oil can leak or spill and could result in fire or breathing hazard. Serious injury or death can result. Fuel or oil leaks will damage carpet, paint or other surfaces in vehicles or trailers.
- Oil could fill the cylinder and damage the engine if the unit is not stored or transported in an upright position.

HOW TO PREVENT IT

- If pressure washer is equipped with a fuel shut-off valve, turn the valve to the off position before transporting to avoid fuel leaks. If pressure washer is not equipped with a fuel shut-off valve, drain the fuel from tank before transporting. Only transport fuel in a CARB (California Air Resources Board) or EPA (Environmental Protection Agency) approved container. Always place pressure washer on a protective mat when transporting to protect against damage to vehicle from leaks. Always transport and store unit in an upright position. Remove pressure washer from vehicle immediately upon arrival at your destination.



! DANGER: RISK OF ELECTRICAL SHOCK

WHAT CAN HAPPEN

- Spray directed at electrical outlets or switches, or objects connected to an electrical circuit, could result in a fatal electrical shock.

HOW TO PREVENT IT

- Unplug any electrically operated product before attempting to clean it. Direct spray away from electric outlets and switches.



! DANGER: RISK OF CHEMICAL BURN

WHAT CAN HAPPEN

- Use of acids, toxic or corrosive chemicals, poisons, insecticides, or any kind of flammable solvent with this product could result in serious injury or death.

HOW TO PREVENT IT

- Do not spray acids, gasoline, kerosene, or any other flammable materials with this product. Use only household detergents, cleaners and degreasers recommended for use with pressure washers.
- Wear protective clothing to protect eyes and skin from contact with sprayed materials.



! WARNING: RISK OF BURSTING

WHAT CAN HAPPEN

- Over inflation of tires could result in serious injury and property damage.

HOW TO PREVENT IT

- Use a tire pressure gauge to check the tires pressure before each use and while inflating tires; see the tire sidewall for the correct tire pressure.

NOTE: Air tanks, compressors and similar equipment used to inflate tires can fill small tires similar to these very rapidly. Adjust pressure regulator on air supply to no more than the rating of the tire pressure. Add air in small increments and frequently use the tire gauge to prevent over inflation.

- High-velocity fluid spray directed at pneumatic tire sidewalls (such as found on automobiles, trailers and the like) could damage the sidewall resulting in serious injury.
- On pressure washers rated above 1600 psi (11032 kPa) use the widest fan spray (40° nozzle) and keep the spray a minimum of 8" (200 mm) from the pneumatic tire sidewall. Do not aim spray directly at the joint between the tire and rim.



! WARNING: RISK OF HOT SURFACES

WHAT CAN HAPPEN

- Contact with hot surfaces, such as engines exhaust components, could result in serious burn.

HOW TO PREVENT IT

- During operation, touch only the control surfaces of the pressure washer. Keep children away from the pressure washer at all times. They may not be able to recognize the hazards of this product.



! WARNING: RISK OF INJURY FROM LIFTING

WHAT CAN HAPPEN

- Serious injury can result from attempting to lift too heavy an object.

HOW TO PREVENT IT

- The pressure washer is too heavy to be lifted by one person. Obtain assistance from others before lifting.

SAVE THESE INSTRUCTIONS FOR FUTURE USE

BATTERIES AND CHARGERS

The battery pack is not fully charged out of the carton. Before using the battery pack and charger, read the safety instructions below and then follow charging procedures outlined. When ordering replacement battery packs, be sure to include the catalog number and voltage.

Your pressure washer uses a DeWALT charger. Be sure to read all safety instructions before using your charger. Consult the chart at the end of this manual for compatibility of chargers and battery packs.

For all information regarding the battery pack or charger, please call 1-800-4-DEWALT (1-800-433-9258) or visit our website www.dewalt.com. The battery pack and charger are to be taken to an authorized DeWALT service center.

Important Safety Instructions for All Battery Chargers

! WARNING: Read all safety warnings and all instructions for the battery pack, charger and pressure washer. Failure to follow the warnings and instructions may result in electric shock, fire and/or serious injury.

- **Before using the charger, read all instructions and cautionary markings on the charger, battery pack and product using the battery pack.**
- **DO NOT attempt to charge the battery pack with any chargers other than the ones in this manual.** The charger and battery pack are specifically designed to work together.
- **These chargers are not intended for any uses other than charging DeWALT rechargeable batteries.**

Any other uses may result in risk of fire, electric shock or electrocution.

- **Do not expose the charger to rain or snow.**
- **Pull by the plug rather than the cord when disconnecting the charger.** This will reduce the risk of damage to the electric plug and cord.
- **Make sure that the cord is located so that it will not be stepped on, tripped over or otherwise subjected to damage or stress.**
- **Do not use an extension cord unless it is absolutely necessary.** Use of improper extension cord could result in risk of fire, electric shock or electrocution.
- **When operating a charger outdoors, always provide a dry location and use an extension cord suitable for outdoor use.** Use of a cord suitable for outdoor use reduces the risk of electric shock.
- **An extension cord must have adequate wire size (AWG or American Wire Gauge) for safety.** The smaller the gauge number of the wire, the greater the capacity of the cable, that is, 16 gauge has more capacity than 18 gauge. An undersized cord will cause a drop in line voltage resulting in loss of power and overheating. When using more than one extension to make up the total length, be sure each individual extension contains at least the minimum wire size. The following table shows the correct size to use depending on cord length and nameplate ampere rating. If in doubt, use the next heavier gauge. The lower the gauge number, the heavier the cord.

Minimum Gauge for Cord Sets

Volts		Total Length of Cord in Feet (meters)				
120 V		25 (7.6)	50 (15.2)	100 (30.5)	150 (45.7)	
240 V		50 (15.2)	100 (30.5)	200 (61.0)	300 (91.4)	
Ampere Rating		American Wire Gauge				
More Than	Not More Than					
0	6	18	16	16	14	
6	10	18	16	14	12	
10	12	16	16	14	12	
12	16	14	12	Not Recommended		

- **Do not place any object on top of the charger or place the charger on a soft surface that might block the ventilation slots and result in excessive internal heat.** Place the charger in a position away from any heat source. The charger is ventilated through slots in the top and the bottom of the housing.
- **Do not operate the charger with a damaged cord or plug.**
- **Do not operate the charger if it has received a sharp blow, been dropped or otherwise damaged in any way.** Take it to an authorized service center.
- **Do not disassemble the charger; take it to an authorized service center when service or repair is required.** Incorrect reassembly may result in a risk of electric shock, electrocution or fire.
- **Disconnect the charger from the outlet before attempting any cleaning.** This will reduce the risk of

electric shock. Removing the battery pack will not reduce this risk.

- **NEVER** attempt to connect 2 chargers together.
- **The charger is designed to operate on standard 120V household electrical power. Do not attempt to use it on any other voltage.** This does not apply to the vehicular charger.

! WARNING: Shock hazard. Do not allow any liquid to get inside the charger. Electric shock may result.

! WARNING: Burn hazard. Do not submerge the battery pack in any liquid or allow any liquid to enter the battery pack. Never attempt to open the battery pack for any reason. If the plastic housing of the battery pack breaks or cracks, return to a service center for recycling.

! CAUTION: Burn hazard. To reduce the risk of injury, charge only DEWALT rechargeable battery packs. Other types of batteries may overheat and burst resulting in personal injury and property damage.

NOTICE: Under certain conditions, with the charger plugged into the power supply, the charger can be shorted by foreign material. Foreign materials of a conductive nature, such as, but not limited to, grinding dust, metal chips, steel wool, aluminum foil or any buildup of metallic particles should be kept away from the charger cavities. Always unplug the charger from the power supply when there is no battery pack in the cavity. Unplug the charger before attempting to clean.

Important Safety Instructions for All Battery Packs

! WARNING: Read all safety warnings and all instructions for the battery pack, charger and pressure washer. Failure to follow the warnings and instructions may result in electric shock, fire and/or serious injury.

- **Do not charge or use the battery pack in explosive atmospheres, such as in the presence of flammable liquids, gases or dust.** Inserting or removing the battery pack from the charger may ignite the dust or fumes.
- **NEVER force the battery pack into the charger. DO NOT modify the battery pack in any way to fit into a non-compatible charger as battery pack may rupture causing serious personal injury.** Consult the chart at the end of this manual for compatibility of batteries and chargers.
- Charge the battery packs only in designated DEWALT chargers.
- **DO NOT** splash or immerse in water or other liquids.
- **Do not store or use the pressure washer and battery pack in locations where the temperature may reach or exceed 104 °F (40 °C) (such as outside sheds or metal buildings in summer).** For best life store battery packs in a cool, dry location.

NOTE: Do not store the battery pack in pressure washer. Always ensure the spray gun trigger lock is engaged. Never tape the spray gun trigger in the ON position.

- **Do not expose battery pack or pressure washer/appliance to fire or excessive temperature.** Exposure to fire or temperature above 265 °F (130 °C) may cause explosion.
- **Do not incinerate the battery pack even if it is severely damaged or is completely worn out.** The battery pack can explode in a fire. Toxic fumes and materials are created when lithium ion battery packs are burned.
- **If battery contents come into contact with the skin, immediately wash area with mild soap and water.** If battery liquid gets into the eye, rinse water over the open eye for 15 minutes or until irritation ceases. If medical attention is needed, the battery electrolyte is composed of a mixture of liquid organic carbonates and lithium salts.
- **Contents of opened battery cells may cause respiratory irritation.** Provide fresh air. If symptoms persist, seek medical attention.

! WARNING: Burn hazard. Battery liquid may be flammable if exposed to spark or flame.

! WARNING: Fire hazard. Never attempt to open the battery pack for any reason. If the battery pack case is cracked or damaged, do not insert into the charger. Do not crush, drop or damage the battery pack. Do not use a battery pack or charger that has received a sharp blow, been dropped, run over or damaged in any way (e.g., pierced with a nail, hit with a hammer, stepped on). Damaged battery packs should be returned to the service center for recycling.

Transportation

! WARNING: Fire hazard. Do not store or carry the battery pack so that metal objects can contact exposed battery terminals. For example, do not place the battery pack in aprons, pockets, tool boxes, product kit boxes, drawers, etc., with loose nails, screws, keys, etc. **Transporting batteries can possibly cause fires if the battery terminals inadvertently come in contact with conductive materials such as keys, coins, hand tools and the like.** The US Department of Transportation Hazardous Material Regulations (HMR) actually prohibit transporting batteries in commerce or on airplanes in carry-on baggage UNLESS they are properly protected from short circuits. So when transporting individual battery packs, make sure that the battery terminals are protected and well insulated from materials that could contact them and cause a short circuit.

NOTE: Lithium-ion batteries should not be put in checked baggage.

SHIPPING THE DEWALT FLEXVOLT™ BATTERY

The DEWALT FLEXVOLT™ battery has two modes: **Use** and **Shipping**.

Use Mode: When the FLEXVOLT™ battery stands alone or is in a DEWALT 20V Max® product, it will operate as a 20V Max® battery. When

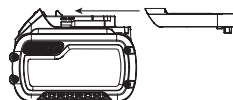

the FLEXVOLT™ battery is in a 60V Max* or a 120V Max* (two 60V Max* batteries) product, it will operate as a 60V Max* battery.

Shipping Mode: When the cap is attached to the FLEXVOLT™ battery, the battery is in Shipping Mode. Strings of cells are electrically disconnected within the pack resulting in three batteries with a lower Watt hour (Wh) rating as compared to one battery with a higher Watt hour rating. This increased quantity of three batteries with the lower Watt hour rating can exempt the pack from certain shipping regulations that are imposed upon the higher Watt hour batteries.

The battery label indicates two Watt hour ratings (see example). Depending on how the battery is shipped, the appropriate Watt hour rating must be used to determine the applicable shipping requirements. If utilizing the shipping cap, the pack will be considered 3 batteries at the Watt hour rating indicated for "Shipping". If shipping without the cap or in a tool, the pack will be considered one battery at the Watt hour rating indicated next to "Use".

Example of Use and Shipping Label Marking

USE: 120 Wh Shipping: 3 x 40 Wh

For example, Shipping Wh rating might indicate 3 x 40 Wh, meaning 3 batteries of 40 Watt hours each. The Use Wh rating might indicate 120 Wh (1 battery implied).

Fuel Gauge Battery Packs

Some DeWALT battery packs include a fuel gauge which consists of three green LED lights that indicate the level of charge remaining in the battery pack.

The fuel gauge is an indication of approximate levels of charge remaining in the battery pack according to the following indicators:

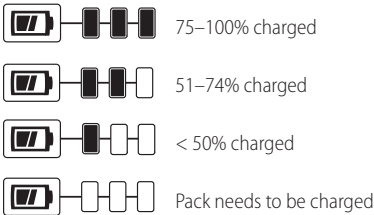

To actuate the fuel gauge, press and hold the fuel gauge button. A combination of the three green LED lights will illuminate designating the level of charge left. When the level of charge in the battery is below the usable limit, the fuel gauge will not illuminate and the battery will need to be recharged.



NOTE: The fuel gauge is only an indication of the charge left on the battery pack. It does not indicate pressure washer functionality and is subject to variation based on product components, temperature and end-user application.

For more information regarding fuel gauge battery packs, please call 1-800-4-DeWALT (1-800-433-9258) or visit our website www.dewalt.com.

The RBRC® Seal

The RBRC® (Rechargeable Battery Recycling Corporation) Seal on the nickel cadmium, nickel metal hydride or lithium-ion batteries (or battery packs) indicates that the costs to recycle these batteries (or battery packs) at the end of their useful life have already been paid by DeWALT. In some areas, it is illegal to place spent nickel cadmium, nickel metal hydride or lithium-ion batteries in the trash or municipal solid waste stream and the Call 2 Recycle® program provides an environmentally conscious alternative.



Call 2 Recycle, Inc., in cooperation with DeWALT and other battery users, has established the program in the United States and Canada to facilitate the collection of spent nickel cadmium, nickel metal hydride or lithium-ion batteries. Help protect our environment and conserve natural resources by returning the spent nickel cadmium, nickel metal hydride or lithium-ion batteries to an authorized DeWALT service center or to your local retailer for recycling. You may also contact your local recycling center for information on where to drop off the spent battery. RBRC® is a registered trademark of Call 2 Recycle, Inc.

Introduction

This battery charger is designed to charge DeWALT 12–20V Max* lithium ion battery packs. This charger requires no adjustment and is designed to be as easy as possible to operate. Simply place your battery pack into the receptacle of a plugged in charger and it will automatically charge the pack. Consult the chart at the end of this manual for compatibility of chargers and battery packs.

Charging a Battery (Fig. B)

1. Plug the charger into an appropriate outlet before inserting battery pack.
2. Insert the battery pack **23** into the charger, making sure the battery pack is fully seated in the charger. The red (charging) light **25** will blink continuously indicating that the charging process has started.
3. The completion of charge will be indicated by the red light remaining ON continuously. The battery pack is fully charged and may be used at this time or left in the charger. To remove the battery pack from the charger, push the battery release button **24** on the battery pack and then slide the battery pack out of the charger.

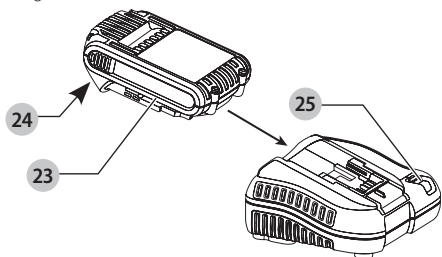

NOTE: To ensure maximum performance and life of lithium-ion battery packs, charge the battery pack fully before first use.

Fig. B



Charger Operation

Refer to the indicators below for the charge status of the battery pack.

	Charging		
	Fully Charged		
	Hot/Cold Pack Delay*		

*The red light will continue to blink, but a yellow indicator light will be illuminated during this operation. Once the battery pack has reached an appropriate temperature, the yellow light will turn off and the charger will resume the charging procedure.

The compatible charger(s) will not charge a faulty battery pack. The charger will indicate faulty battery pack by refusing to light.

NOTE: This could also mean a problem with a charger. If the charger indicates a problem, take the charger and battery pack to be tested at a DeWALT authorized service center.

Hot/Cold Pack Delay

When the charger detects a battery pack that is too hot or too cold, it automatically starts a Hot/Cold Pack Delay, suspending charging until the battery pack has reached an appropriate temperature. The charger then automatically switches to the pack charging mode. This feature ensures maximum battery pack life.

A cold battery pack will charge at a slower rate than a warm battery pack. The battery pack will charge at that slower rate throughout the entire charging cycle and will not return to maximum charge rate even if the battery pack warms.

Never operate the charger if the fan does not operate properly or if ventilation slots are blocked. Do not permit foreign objects to enter the interior of the charger.

Electronic Protection System

Li-Ion pressure washers are designed with an Electronic Protection System that will protect the battery pack against overloading, overheating or deep discharge.

The pressure washer will automatically turn off if the Electronic Protection System engages. If this occurs, place the lithium-ion battery pack on the charger until it is fully charged.

Wall Mounting

These chargers are designed to be wall mountable or to sit upright on a table or work surface. If wall mounting, locate the charger within reach of an electrical outlet, and away from a corner or other obstructions which may impede air flow. Use the back of the charger as a template for the location of the mounting screws on the wall. Mount the charger securely using drywall screws (purchased separately) at least 1" (25.4 mm) long, with a screw head diameter of 0.28–0.35" (7–9 mm), screwed into wood to an optimal depth leaving approximately 7/32" (5.5 mm) of the screw exposed. Align the slots on the back of the charger with the exposed screws and fully engage them in the slots.

Charger Cleaning Instructions



WARNING: Shock hazard. Disconnect the charger from the AC outlet before cleaning. Dirt and grease may be removed from the exterior of the charger using a cloth or soft non-metallic brush. Do not use water or any cleaning solutions.

Important Charging Notes

- Longest life and best performance can be obtained if the battery pack is charged when the air temperature is between 65 °F and 75 °F (18 ° – 24 °C). DO NOT charge the battery pack in an air temperature below +40 °F (+4.5 °C), or above +104 °F (+40 °C). This is important and will prevent serious damage to the battery pack.
- The charger and battery pack may become warm to the touch while charging. This is a normal condition, and does not indicate a problem. To facilitate the cooling of the battery pack after use, avoid placing the charger or battery pack in a warm environment such as in a metal shed or an uninsulated trailer.
- If the battery pack does not charge properly:
 - Check operation of receptacle by plugging in a lamp or other appliance;
 - Check to see if receptacle is connected to a light switch which turns power off when you turn out the lights;
 - Move the charger and battery pack to a location where the surrounding air temperature is approximately 65 °F – 75 °F (18 ° – 24 °C);
 - If charging problems persist, take the charger and battery pack to be tested at a DeWALT authorized service center.
- The battery pack should be recharged when it fails to produce sufficient power on jobs which were easily done previously. DO NOT CONTINUE to use under these conditions. Follow the charging procedure. You may also charge a partially used pack whenever you desire with no adverse effect on the battery pack.
- Foreign materials of a conductive nature such as, but not limited to, grinding dust, metal chips, steel wool, aluminum foil, or any buildup of metallic particles should be kept away from charger cavities. Always unplug the charger from the power supply when there

is no battery pack in the cavity. Unplug the charger before attempting to clean.

6. Do not freeze or immerse the charger in water or any other liquid.

Storage Recommendations

NOTICE: DO NOT store battery pack in pressure washer. ALWAYS turn unit off and remove the battery pack before storing.

1. The best storage place is one that is cool and dry, away from direct sunlight and excess heat or cold.
2. For long storage, it is recommended to store a fully charged battery pack in a cool dry place out of the charger for optimal results.

NOTE: Battery packs should not be stored completely depleted of charge. The battery pack will need to be recharged before use.

SAVE THESE INSTRUCTIONS FOR FUTURE USE

ASSEMBLY

Pressure Washer Assembly (Fig. A, C-F)

1. Slide the handle assembly **8** onto the frame **6** and secure with saddle bolts **20** and knobs **21**.

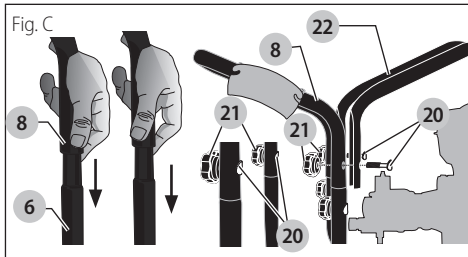

2. Align holes in the top handle **22** with the mounting holes in the handle assembly **8**. Insert saddle bolts **20** through aligned holes and secure top handle to handle assembly with knobs **21**. Tighten until snug.

CAUTION: Risk of personal injury. Avoid placing hands between handle and frame when assembling to prevent pinching.

3. Attach high pressure hose **9** to spray gun **3**. Make sure it is secure.

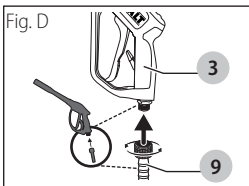

4. Connect wand **5** to spray gun **3**. Make sure connection is secure.

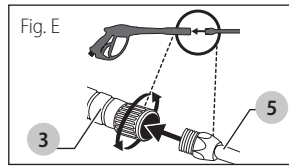

5. Remove the five colored quick-connect nozzles from the plastic bag and insert them into correct grommet on the nozzle holder. Nozzles are color coded to match colored nozzles on panel assembly.

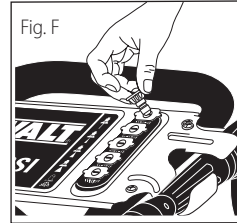

6. Check the tire pressure and add air if needed.

NOTE: Air tanks, compressors and similar equipment used to inflate tires can fill small tires similar to these very rapidly. Adjust pressure regulator on air supply to no more than the rating of the tire pressure. Add air in small increments and frequently use the tire gauge to prevent over inflation.

WARNING: Risk of bursting. Use a tire pressure gauge to check the tires pressure before each use and while inflating tires; see the tire sidewall for the correct tire pressure.

OPERATION

Pressure Adjustments

The pressure setting is preset at the factory to achieve optimum pressure and cleaning. To lower the pressure, follow these instructions.

1. Back away from the surface to be cleaned. The further away the nozzle is, the less the pressure will be on the surface to be cleaned.
2. Change to the 40° nozzle (white). This nozzle delivers a less powerful stream of water and a wider spray pattern. Refer to **Spray Wand Nozzles**.
3. This pressure washer's high pressure pump is equipped with an adjustable unloader **30** (Fig. G) feature that allows the pressure setting to be adjusted. To lower the pressure, turn the pressure control knob on the pump counterclockwise to the desired pressure. To return the pump pressure to the factory setting, turn the pressure control knob on the pump clockwise until it stops.

NOTICE: DO NOT try to turn pressure regulator knob past the built-in stop or damage to the pump will result.

NOTICE: DO NOT overtighten the pressure control knob. If overtightened the knob COULD break and result in immediate loss of water pressure and costly repairs to the unit.

NOTICE: DO NOT attempt to increase pump pressure. A higher pressure setting than the factory set pressure may damage the pump.

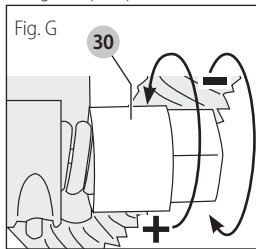

Spray Wand Nozzles (Fig. A, H)

The nozzles for the spray wand are stored in the nozzle holder ② on the panel assembly ①. Colors on the panel identify nozzle location and spray pattern. Refer to the following chart to choose the correct nozzle for the job to be performed.

Nozzle Color	Spray Pattern	Uses	Surfaces***
Red	0° 	powerful pinpoint for very intense cleaning	metal or concrete; DO NOT use on wood
Yellow	15° 	intense cleaning of small areas	metal, concrete or wood
Green	25° 	intense cleaning of larger areas	metal, concrete or wood
White	40° 	covers wide areas of cleaning	metal, concrete, wood or vinyl
Black	low pressure 	applies chemical/cleaning soaps	metal, concrete, wood or vinyl

*** **NOTICE:** The high pressure spray from your pressure washer is capable of causing damage to surfaces such as wood, glass, automobile paint, auto striping and trim, delicate objects such as flowers and shrubs. Before spraying, check the item to be cleaned to assure yourself that it is strong enough to resist damage from the force of spray.

Changing Nozzles on Spray Wand (Fig. H)

DANGER: Risk of fluid injection. Do not direct discharge stream toward persons, unprotected skin, eyes or any pets or animals. Serious injury will occur.



WARNING: Flying objects could cause risk of serious injury. DO NOT attempt to change nozzles while pressure washer is running. Turn engine off before changing nozzles.

1. Pull quick-connect coupler back and insert nozzle.
2. Release quick-connect coupler and twist nozzle to make sure it is secure in coupler.



WARNING: Flying objects could cause risk of serious injury. Ensure nozzle is completely inserted in quick-connect socket and quick-connect collar is fully engaged (forward) before squeezing spray gun trigger.

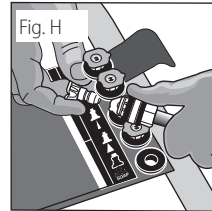

Chemicals/Cleaning Soaps

Applying chemicals or cleaning soaps is a low pressure operation.

NOTE: Use only chemical and cleaning soaps designed for pressure washer use. Do not use bleach.

To Apply Chemical/Cleaning Soaps (Fig. I)

1. Press chemical/soap hose 26 onto barbed fitting located near high pressure hose connection of pump as shown.

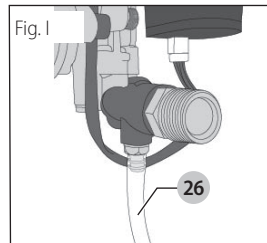

2. Place the other end of chemical/soap hose with filter into the container holding the chemical/cleaning soap.
NOTE: For every 10 gallons (38 liters) of water pumped 1 gallon (3.8 liters) of chemical/cleaning soap will be used.
3. Install low-pressure (black) nozzle into quick connect fitting of spray wand, refer to **Spray Wand Nozzles**.
NOTE: Chemical/cleaning soaps will not siphon if the black soap nozzle is not installed on the spray wand.
4. **After use of chemical/cleaning soaps**, place chemical/soap hose into container of clean water and draw clean water through chemical injection system to rinse system thoroughly.

NOTICE: Risk of property damage. Failure to do so could cause damage to the pump. Pumps damaged due to chemical/cleaning soaps will not be covered under warranty.

Starting



WARNING: To reduce the risk of injury, read the pressure washer instruction manual and the engine instruction manual before starting pressure washer.



DANGER: Risk of fluid injection and laceration.

When using the high pressure setting, **DO NOT** allow the high pressure spray to come in contact with unprotected skin, eyes, or with any pets, animals, or people. Serious injury will occur.

- Your washer operates at fluid pressures and velocities high enough to penetrate human and animal flesh, which could result in amputation or other serious injury. Leaks caused by loose fittings or worn or damaged hoses can result in injection injuries. **DO NOT TREAT FLUID INJECTION AS A SIMPLE CUT!** See a physician immediately!
- Never leave spray gun/wand unattended while unit is running or powered on. When operating in PRESSUREADY® system mode the engine and water flow will stop when the spray gun trigger is released. When the spray gun trigger is squeezed again the engine and water flow will restart automatically.



DANGER: Carbon Monoxide. Using an engine indoors can kill. Engine exhaust contains high levels of carbon monoxide (CO), a poisonous gas you cannot see or smell. You may be breathing CO even if you do not smell engine exhaust.

- Breathing exhaust fumes will cause serious injury or death! Engine exhaust contains carbon monoxide, an odorless and deadly gas.
- Operate pressure washer in a well-ventilated area. Avoid enclosed areas such as garages, basements, etc.
- Never operate unit in or near a location occupied by humans or animals.



WARNING: Risk of fire, asphyxiation and burning. Never fill fuel tank when engine is running or hot. Do not smoke when filling fuel tank.

- Remove battery before filling fuel tank. Do not fill fuel tank when battery is installed.
- Never fill fuel tank completely. Fill tank to 1/2" (12.7 mm) below bottom of filler neck to provide space for fuel expansion. Wipe any fuel spillage from engine and equipment before starting engine.
- DO NOT** let hoses come in contact with very hot engine muffler during or immediately after use of your pressure washer. Damage to hoses from contact with hot engine surfaces will **NOT** be covered by warranty.

NOTICE: NEVER pull water supply or high pressure hose to move pressure washer. This could damage hose and/or pump inlet/outlet.

- DO NOT** use hot water, use cold water only.
- Never turn water supply off while pressure washer engine is running or damage to pump will result.
- WHEN OPERATING IN MANUAL MODE ONLY:** **DO NOT** stop spraying water for more than two minutes at a time. Pump operates in bypass mode when spray gun trigger is not pressed. When the temperature inside the pump rises too high the thermal relief valve (13, Fig. J) will open and release a gush of water in an effort to lower the temperature inside the pump. The thermal relief valve will then close. If pump is left in bypass mode for more than two minutes internal components of the pump can be damaged.

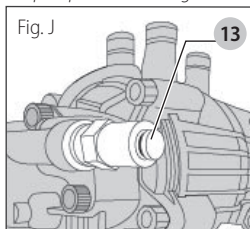

IMPORTANT: This pressure washer can be started in two modes, PRESSUREADY® System Mode or Manual Mode. Carefully follow the instructions for the chosen mode.

PRESSUREADY® System Mode Start-up Procedure (Fig. A, K–S)

- In a well-ventilated outdoor area, add fresh, high-quality, unleaded gasoline with a pump octane rating of 86 or higher. Do not overfill. Wipe up spilled fuel before starting the engine. Refer to engine instruction manual for correct procedure.

IMPORTANT: Ethanol Shield™ (sold separately) is a fuel stabilizer that helps eliminate and prevent ethanol related problems in power equipment. Follow the instructions on the container and add to the gasoline.



NOTICE: Use of fuels with greater than 10% ethanol are not approved for use in this product per EPA regulations and will damage the unit and void the warranty.

- Check engine oil level. Refer to the engine instruction manual for correct procedure.



NOTICE: The engine is shipped without oil. Before starting engine, add the oil provided. Damage to the engine will occur if the engine is run without oil, this damage will not be covered under warranty.

3. Ensure the engine ON/OFF switch **27** in the OFF position.

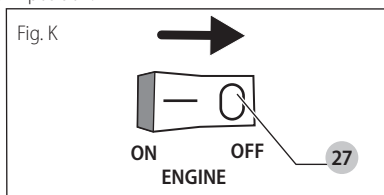

4. Place the fuel valve lever in the ON position.

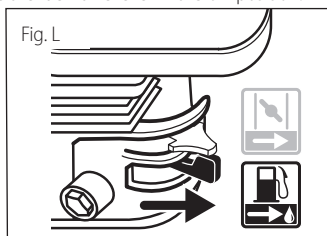

5. Connect the water hose to the cold water source. Turn the water source on to remove all air from the hose and flush any debris. When a steady stream of water is present, turn the cold water source off.
6. Verify the filter screen **14** is in water inlet of pump. If the filter is not flat, convex side should face out.

NOTICE: Failure to use an inlet screen filter may cause damage to pump components and void warranty.

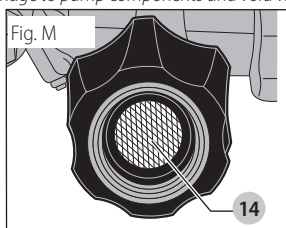

7. Connect the cold water source **15** to pump inlet.
- NOTE:** Water source must provide a minimum of 5 gallons per minute at 20 psi (138 kPa). **NOTE:** The pressure washer will not start in PRESSUREREADY® system mode with low water flow.

WARNING: To reduce the possibility of contamination always protect against backflow when connected to a potable water system.

8. Connect high pressure hose **9** to pump outlet.

Fig. N

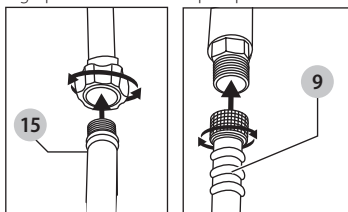

9. Attach high pressure hose **9** to spray gun. Make sure it is secure. See **Assembly**.
10. Connect wand **5** to spray gun. Make sure connection is secure. See **Assembly**.

11. Connect the QC nozzle to the spray wand. Choose the correct nozzle for the job to be performed, see **Spray Wand Nozzles**. If applying a chemical/cleaning soap, refer to **Chemicals/Cleaning Soaps**.

12. Turn the cold water source on.

NOTICE: Risk of property damage. Failure to do so could cause damage to the pump.

13. Remove all air from the pump and high pressure hose by squeezing the spray gun trigger for approximately 30 seconds or until a steady stream of water is present. Release the spray gun trigger.

14. Install the battery pack:



WARNING:

- Make certain the engine ON/OFF switch is in the OFF position to prevent switch actuation before removing or installing battery.
- DO NOT insert/remove battery while engine is running.
- **ONLY USE** DEWALT rechargeable batteries, use of any other battery will void the warranty.

NOTE: For best results, make sure your battery pack is fully charged.

- **Open battery housing cover:** Push the spring lock down **(1)** to unlock the cover and pull cover up to open **(2)**.

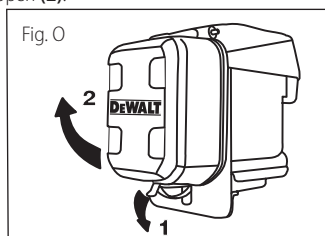

- **To install battery pack:** Insert battery pack **23** into battery housing **12** as shown in Fig. P until fully seated and an audible click is heard. Make sure battery pack is fully seated and fully latched into position.
- Close and lock the battery housing cover.
- The green, yellow, and red light on the PRESSUREREADY® control box should illuminate momentarily and then turn off. The blue light on the ON/STOP button should be flashing.

Fig. P

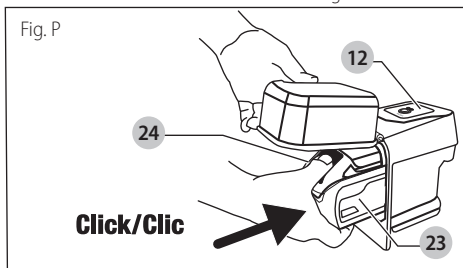

- Place the engine ON/OFF switch **27** in the ON position.

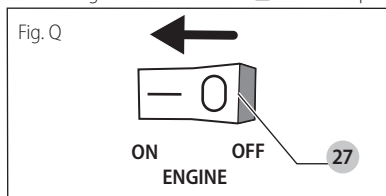

- Press the ON/STOP button **28** for 2 seconds. The green READY light will illuminate. The yellow WATER FLOW light should also illuminate to verify the water is connected properly and turned on.

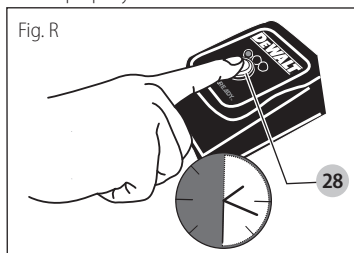

- When the green system ready light illuminates, squeeze the spray gun trigger to start the engine. After squeezing the spray gun trigger it will take approximately 3 seconds for engine to start. After the engine has started, the water flow will begin and the yellow water flow light will illuminate. See the **PRESSUREADY® Fault Codes Table** in the **Troubleshooting** section for more information.

NOTE: The spray gun is equipped with a spring loaded trigger lock **16**. Manually release trigger lock as shown in Fig. S.

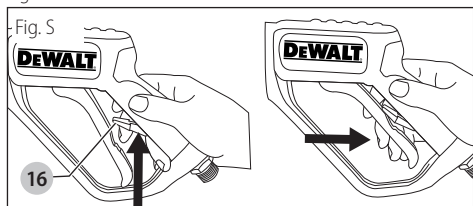

WARNING: Risk of unsafe operation. Stand on a stable surface and grip spray gun/wand firmly with both hands. Expect the spray gun/wand to kickback when triggered.

- When spray gun trigger is released, water flow will stop immediately and the engine will shut off in approximately 10 seconds. Ensure spring loaded trigger lock is moved forward into the locked position.
- To restart pressure washer, manually release trigger lock and squeeze the spray gun trigger and the engine will restart. Note that it will take approximately 3 seconds for engine to start after squeezing spray gun trigger. After the engine has started, the water flow will begin.

DANGER: Risk of injury from spray. Ensure the spring loaded trigger lock **16** is moved forward to the locked position, when the spray gun is not in use to prevent accidental spraying.

Alternate Manual Mode Start-up Procedure (Without Battery) (Fig. A, T-Z)

- In a well-ventilated outdoor area, add fresh, high-quality, unleaded gasoline with a pump octane rating of 86 or higher. Do not overfill. Wipe up spilled fuel before starting the engine. Refer to engine instruction manual for correct procedure.

IMPORTANT: Ethanol Shield™ (sold separately) is a fuel stabilizer that helps eliminate and prevent ethanol related problems in power equipment. Follow the instructions on the container and add to the gasoline.

Ethanol Percentage	
<10% OK	NO 15%–30%–85%

NOTICE: Use of fuels with greater than 10% ethanol are not approved for use in this product per EPA regulations and will damage the unit and void the warranty.

- Check engine oil level. Refer to the engine instruction manual for correct procedure.
- NOTICE:** The engine is shipped without oil. Before starting engine, add the oil provided. Damage to the engine will occur if the engine is run without oil, this damage will not be covered under warranty.
- Place the engine ON/OFF switch **27** in the ON position.

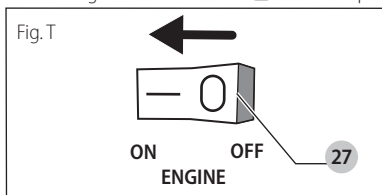

- Place the fuel valve lever in the ON position.

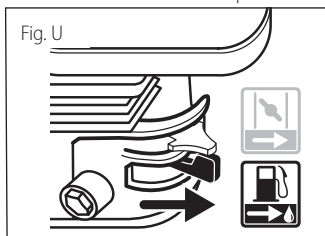

- Move the choke to the CLOSED Position.

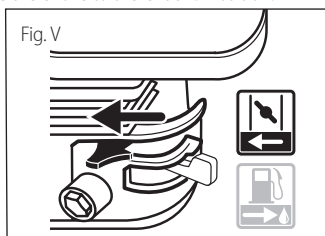

6. Connect the water hose to the cold water source. Turn the cold water source on to remove all air from the hose and flush any debris. When a steady stream of water is present, turn the cold water source off.
7. Verify the filter screen **14** is in water inlet of pump. If the filter is not flat, convex side should face out.

NOTICE: Failure to use an inlet screen filter may cause damage to pump components and void warranty.

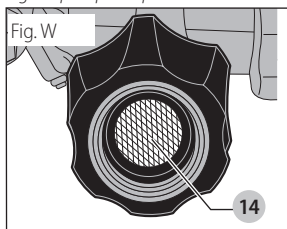

8. Connect the cold water source **15** to pump inlet.
NOTE: Water source must provide a minimum of 5 gallons per minute at 20 psi (138 kPa).

WARNING: To reduce the possibility of contamination always protect against backflow when connected to a potable water system.

9. Connect high pressure hose **9** to pump outlet.

Fig. X

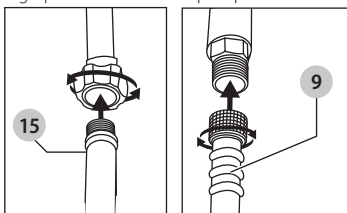

10. Attach high pressure hose **9** to spray gun. Make sure it is secure. See **Assembly**.
11. Connect wand **5** to spray gun. Make sure connection is secure. See **Assembly**.
12. Connect the QC nozzle to the spray wand. Choose the correct nozzle for the job to be performed, see **Spray Wand Nozzles**. If applying a chemical/cleaning soap, refer to **Chemicals/Cleaning Soaps**.

13. Turn the cold water source on.

NOTICE: Risk of property damage. Failure to do so could cause damage to the pump.

14. Remove all air from the pump and high pressure hose by squeezing the spray gun trigger for approximately 30 seconds or until a steady stream of water is present. Release the spray gun trigger.

15. Pull the recoil starter grip to start the engine.

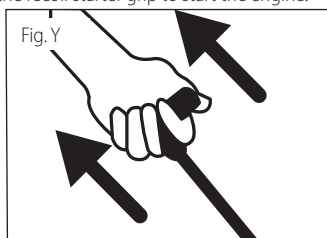

WARNING: Risk of unsafe operation. If engine does not start after two pulls, squeeze spray gun trigger to relieve pump pressure. Pull starter cord slowly until resistance is felt. Then pull cord rapidly to avoid kickback and prevent hand or arm injury.

16. Gradually move the Choke to the OPEN Position after engine starts.

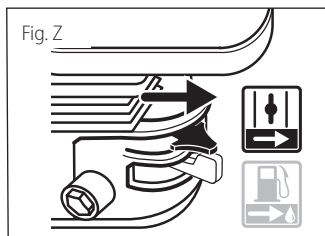

17. Depress trigger on gun to start water flow.



WARNING: Risk of unsafe operation. Stand on a stable surface and grip gun/spray wand firmly with both hands. Expect the gun to kick when triggered.

18. Release trigger to stop water flow.



WARNING: Do not allow the unit to run for more than two minutes without the spray gun trigger being pulled. This could cause overheating and damage to the pump. When the temperature inside the pump rises too high, the thermal relief valve will open and release a spray of water from the pump to lower the internal temperature. The valve will then close.



DANGER: Risk of injury from spray. Ensure the spring loaded trigger lock **16** (Fig. S) is moved forward to the locked position, when the spray gun is not in use to prevent accidental spraying.

Shutting Down (Fig. P, AA, BB)

NOTICE: Risk of property damage. Never turn water supply off while pressure washer engine is running or damage to pump will result.

1. If chemical/cleaning soaps were applied, place the chemical/soap hose into a container of clean water and draw clean water through chemical injection system to rinse system thoroughly.

NOTICE: Risk of property damage Failure to do so could cause damage to the pump.

2. Place the engine ON/OFF switch **27** in the OFF position.

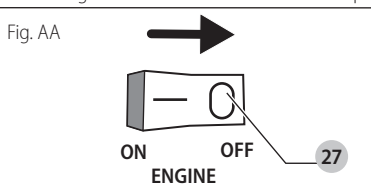

NOTE: When operating the pressure washer in the PRESSUREREADY® system mode the engine ON/OFF switch **MUST** be in the OFF position to stop the engine. When spray gun trigger is released, the water flow will stop immediately and the engine should shut off in approximately 10 seconds. When the spray gun trigger is squeezed again, the engine will restart and the water flow will begin again.

- Place the fuel valve lever in the OFF position.

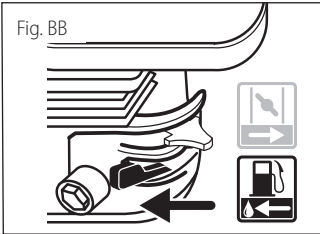

- PRESSUREREADY® system mode only:** Remove the battery pack and store properly.

- To remove battery pack (Fig. P):** Depress the battery release button **24** on the battery and pull battery pack out from the battery housing.



WARNING: Risk of Damage. **DO NOT** store battery pack in pressure washer when not in use. Remove battery pack after every use.

- Turn cold water source off.
- Pull spray gun trigger to relieve any water pressure in hose or spray gun.
- Refer to **Storage** for proper storage procedures.

MAINTENANCE



WARNING: Risk of burning. When performing maintenance, you may be exposed to hot surfaces, water pressure or moving parts that can cause serious injury or death.



WARNING: Risk of fire. Always disconnect, spark plug wire, let the engine cool and release all water pressure before performing any maintenance or repair. The engine contains flammable fuel. Do not smoke or work near open flames while performing maintenance.

To ensure efficient operation and longer life of your pressure washer, a routine maintenance schedule should be prepared and followed. If the pressure washer is used in unusual conditions, such as high temperatures or dusty conditions, more frequent maintenance checks will be required.

Engine

Consult the engine instruction manual for the manufacturer's recommendations for any and all maintenance.

NOTE: The pressure washer frame is equipped with an oil drain hole to help make changing the engine oil easier.

Pump

The pump was filled with oil at the factory. The pump on this unit is maintenance free and requires no oil. If there is a problem with the pump contact us at 1-877-362-4271 or reference the **Troubleshooting Guide**.

Nozzle Cleaning (Fig. CC, DD)

If the nozzle becomes clogged with foreign materials, such as dirt, excessive pressure may develop. If the nozzle becomes partially clogged or restricted, the pump pressure will pulsate and when operating in PRESSUREREADY® system mode the engine may shut off due to the low water flow. Clean the nozzle immediately using the nozzle kit supplied and the following instructions:

- Shut down the pressure washer. See **Shutting Down** for the correct procedure.
- Disconnect the spray wand from the spray gun.
- Remove the high pressure nozzle from the spray wand. Remove any obstructions with the nozzle cleaning tool **29** provided and back flush with clean water.

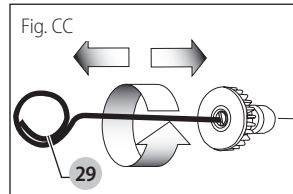

- Direct water supply into spray nozzle to back flush loosened particles for 30 seconds.

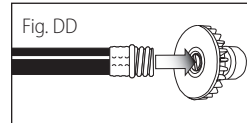

- Reconnect the nozzle to the spray wand.
- Reconnect spray wand to gun then turn on water supply.
- Start pressure washer and place spray wand into high pressure setting to test. See **Starting** for the correct procedure.

To Clean the Water Inlet Filter (Fig. EE)

This filter screen **14** should be checked periodically and cleaned if necessary.

- Shut down the pressure washer. See **Shutting Down** for the correct procedure.
- Remove the filter screen **14** by grasping the end and removing it from water inlet of pump.
- Clean filter by flushing it with water on both sides.
- Reinsert filter into water inlet of pump. If the filter is not flat, convex side should face out.

NOTE: Do not operate pressure washer without filter properly installed.

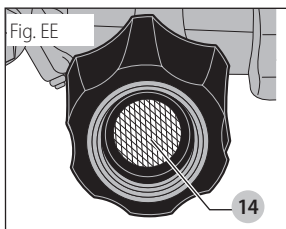

STORAGE

Engine

Consult the engine instruction manual for the recommendations for storage.

To Prevent Fuel-Related Problems

1. Add Ethanol Shield™ fuel stabilizer following the manufacturer's instructions. When adding a gasoline stabilizer, fill the fuel tank with fresh gasoline. If only partially filled, air in the tank will promote fuel deterioration during storage. If you keep a container of gasoline for refueling, be sure that it contains only fresh gasoline.
2. After adding a gasoline stabilizer:
 - a. Connect the cold water source to pump inlet, turn on cold water source and squeeze the spray gun trigger for approximately 30 seconds or until a steady stream of water is present. Release the spray gun trigger.
 - b. Start pressure washer/engine. See **Starting** for the correct procedure. Run the engine outdoors for 10 minutes to be sure that treated gasoline has replaced the untreated gasoline in the carburetor.
3. Turn the fuel valve to the OFF position.
4. Continue to run the engine until it stops from the lack of fuel in the carburetor fuel bowl. Running time should be less than 3 minutes.
5. Turn off the cold water source.

Pump

The manufacturer recommends using SIMPSON® / POWERWASHER™ Pump Guard or equivalent when storing the unit for more than 30 days and/or when freezing temperatures are expected. SIMPSON® / POWERWASHER™ Pump Guard is environmentally friendly.

NOTE: Using pump guard helps provide proper lubrication to the internal seals of the pump regardless of temperature or environment.

NOTICE: Risk of property damage. Use only SIMPSON® / POWERWASHER™ Pump Guard or equivalent. Other products could be corrosive and/or contain alcohol which may cause pump damage.

1. Turn off pressure washer and disconnect hoses from pump.
2. Unscrew bottle valve from Pump Guard bottle and remove seal.
3. Screw bottle valve back onto bottle.

4. Attach bottle to water inlet of pump.
5. Squeeze bottle to inject contents into pump.



WARNING: Use **Manual Mode Start-up**

Procedure (without battery) instructions. Do not install battery.

6. With the engine ON/OFF switch in the OFF position, simultaneously pull starter rope and squeeze bottle. Repeat until protector fluid exits pump outlet.

NOTE: This step may require two people.

Pressure Washer



WARNING: Risk of Damage. DO NOT store battery pack in pressure washer when not in use. Remove battery pack after every use.

1. Shut down the pressure washer. See **Shutting Down** for the correct procedure.
2. Drain all water from high pressure hose, coil it and store it in cradle of the pressure washer handle.
3. With nozzle pointed down and the spray gun and wand in a vertical position, squeeze spray gun trigger to drain all water from spray gun and wand. Store in spray gun holder.
4. Store chemical/soap hose so it is protected from damage.

NOTICE: Risk of property damage. Always store and transport unit in an upright position.

ACCESSORIES



WARNING: Since accessories, other than those offered by DEWALT, have not been tested with this product, use of such accessories with this pressure washer could be hazardous. To reduce the risk of injury, only DEWALT recommended accessories should be used with this product.

Recommended accessories for use with your pressure washer are available for purchase from your local dealer or authorized service center. If you need assistance in locating any accessory for your pressure washer, please contact the FNA Group at cservice@fna-group.com, 7152 99th Street Pleasant Prairie, WI 53158, or call 1-877-362-4271.



DANGER: Risk of fluid injection. When using replacement lances or guns with this pressure washer, do not use a lance and/or lance/gun combination that is shorter in length than what was provided with this pressure washer as measured from the nozzle end of the lance to the gun trigger.



WARNING: The use of any other accessory not recommended for use with this pressure washer could be hazardous. Use only accessories rated equal to or higher than the rating of the pressure washer.

Service Information

Please have the following information available for all service calls: Model Number _____

Serial Number _____

Date and Place of Purchase _____

Repairs

Battery and charger: The charger and battery pack are not serviceable. For all information regarding the battery pack or charger, please call **1-800-4-DeWALT (1-800-433-9258)** or visit our website www.dewalt.com. The battery pack and charger are to be taken to an authorized DeWALT service center.

Pressure washer and all other concerns: To assure product SAFETY and RELIABILITY, repairs, maintenance and adjustment should be performed by a FNA factory service center, a FNA authorized service center or other qualified service personnel. Always use identical replacement parts. Contact our Customer Service Department at **1-877-362-4271** or cservice@fna-group.com

Limited Warranty

The manufacturer of this product agrees to repair or replace designated parts that prove defective within the warranty period listed below at the manufacturer's sole discretion. Specific limitations/extensions and exclusions apply.

This warranty covers defects in material and workmanship and not parts failure due to normal wear, depreciation, abuse, accidental damage, negligence, improper use, maintenance, water quality or storage. To make a claim under the terms of the warranty, all parts said to be defective must be retained and available for return upon request to a designated Warranty Service Center for warranty inspection. The judgments and decisions of the manufacturer concerning the validity of warranty claims are final.

These warranties pass through to the end user and are non-transferable. As a factory authorized and trained Warranty Service Center, the factory will honor the terms of all component warranties and satisfy claims of the appropriate warranty provisions.

Normal wear items include, but are not limited to, valves and seals, which are not covered by this warranty.

This warranty replaces all other warranties, express or implied, including without limitation any warranties of merchantability or fitness for a particular purpose and all such warranties are hereby disclaimed and excluded by the manufacturer. The manufacturer's warranty obligation is limited to repair and replacement of defective products as provided herein and the manufacturer shall not be liable for any further loss, damages, or expenses – including damages from shipping, accident, abuse, acts of God, misuse, or neglect. Neither is damage from repairs using parts not purchased from the manufacturer or alterations performed by non-factory authorized personnel. Failure to install and operate equipment according to the guidelines put forth in the instruction manual shall void warranty.

This warranty does not cover the following:

machines used for rental purposes, damage resulting from shipping (claims must be filed with freighter), accident, abuse, act of God, misuse, or neglect. Neither is damage from repairs or alterations performed by non-factory authorized personnel or failure to install and operate

equipment according to the guidelines put forth in the instruction manual.

The manufacturer will not be liable to any persons for consequential damage, for personal injury, or for commercial loss.

Responsibility of Original Purchaser (Initial User):

- To process a warranty claim on your DeWALT pressure washer, report the concern to **1-877-362-4271** or cservice@fna-group.com for authorization and direction to the nearest authorized service center in your area.
- Retain original cash register sales receipt as proof of purchase for warranty work.
- Use reasonable care in the operation and maintenance of the product as described in the Owners Manual(s).

Warranty Does Not Apply to Failures Due to:

- Freight damage
- Damage due to chemical deterioration, scale build up, rust, corrosion or thermal expansion
- Freeze damage
- Damage caused by parts or accessories not obtained from an authorized dealer or not approved by the manufacturer.
- Normal wear of moving parts or components affected by moving parts.

Engine and Emissions Control System: Covered by engine manufacturer warranty. See **Engine manual**.

Battery and Charger: Covered by battery/charger manufacturer warranty. See **Battery charger manual**.

PRESSUREADY SYSTEM®: Three (3) years from date of purchase

High Pressure Pump (defects in material and workmanship)

AAATM - Five (5) years from date of purchase

Frame (defects in material and workmanship)

Ten (10) years from date of purchase.

Accessories (Defects in Material and Workmanship)

Includes nozzles, hoses, spray guns, wands, tires, feet
Ninety (90) days from date of purchase.

Glossary

Bypass mode: Allows water to re-circulate within pump when the engine is running and the spray gun trigger is not pulled.

Chemical/soap hose: Feeds chemical/cleaning soap into the pump to mix with the water. Refer to **Chemicals/Cleaning Soaps** section.

Chemical injection system: Mixes chemical/cleaning soap with water to improve cleaning effectiveness.

Choke control: Opens and closes carburetor choke valve.

NOTE: The choke adjust automatically when operating in the PRESSUREADY® system mode, only adjust the choke when operating in Manual Mode.

CU: Cleaning Units. GPM multiplied by psi. (GPM x PSI = CU)

Fuel valve lever: Opens/closes connection between fuel tank and carburetor.

GPM*: Gallons Per Minute. The unit of measure for the flow rate of water.

PSI*: Pounds per Square Inch. The unit of measure for water pressure. Also used for air pressure, hydraulic pressure, etc.

** Complies with CETA Performance Standard CPC-100.
Values are within manufacturing tolerance of +/- 10%.*

kPa (kilopascal): Metric pressure measurement. 1 kilopascal equal 1000 pascals.

Quick-connect spray wand: Allows the user to quickly change out high pressure nozzles. Refer to **Spray Wand Nozzles**.

Thermal relief valve (Manual mode only): When the temperature inside the pump rises too high the valve will open and release a gush of water in an effort to lower the temperature inside the pump. The valve will then close.

Cold water supply: All pressure washers must have a source of cold water. The minimum requirements for a water supply are 20 psi (138 kPa) and 5 gallons per minute.

PRESSUREADY® system mode: This mode uses an advanced electronic system to stop and start the pressure washer when the spray gun trigger is squeezed and released. The PRESSUREADY® system also communicates with the user through fault codes to help diagnose and solve issues with the pressure washer.

Manual mode: This mode starts the pressure washer without the use of the battery and the PRESSUREADY® system.

Troubleshooting Guide

This section provides a list of the more frequently encountered malfunctions, their causes and corrective actions. The operator or maintenance personnel can perform some corrective actions, and others may require the assistance of a FNA authorized service center or other qualified service personnel.

Problem	Troubleshooting Key #
Engine will not start	1, 2, 3, 4, 5, 6, 7, 8, 10, 16, 29, 30 (refer to the engine's instruction manual for further engine troubleshooting)
No or low pressure (initial use)	9, 10, 11, 12, 13, 14, 15, 16
Will not draw chemical/cleaning soaps	16, 17, 18, 19, 20, 21
No or low pressure (after period of normal use)	22, 23, 24
Water leaking at gun/spray wand connection	25, 26
Water leaking at pump	25, 26, 27, 28
Pump Pulsates	12

Troubleshooting Key

Key #	POSSIBLE CAUSE	POSSIBLE SOLUTION
1	No fuel.	Add fuel.
2	Low or no oil. NOTE: This pressure washer is equipped with a low oil sensor. If the oil is low or the unit is not level the unit will shut off or fail to start.	Add required amount of oil. Ensure the pressure washer is placed on a level surface.
3	Manual mode only: Pressure builds up after two pulls on the recoil starter or after initial use.	Squeeze spray gun trigger to relieve pressure.
4	Choke in the OPEN position.	Move choke to the CLOSED position.
5	Spark plug wire not attached.	Attach spark plug wire.
6	Engine ON/OFF switch in OFF position.	Place engine ON/OFF switch in ON position.
7	Choke in the CLOSED position on a hot engine or an engine that has been exposed to thermal heat for a long period of time.	Move choke to the OPEN position.
8	Fuel valve OFF.	Move the fuel valve to the ON position.
9	Spray wand not in high pressure.	See Spray Wand Nozzles under Operation .
10	Low water supply.	Water supply must be at least 5 GPM @ 20 psi (138 kPa). NOTE: The pressure washer can not start in PRESSUREREADY® system mode with low water supply.
11	Leak at high pressure hose fitting.	Repair leak. Apply sealant tape if necessary.

Key #	POSSIBLE CAUSE	POSSIBLE SOLUTION
12	Nozzle obstructed.	See Nozzle Cleaning under Maintenance .
13	Water filter screen clogged.	Remove and clean filter. See To Clean the Water Inlet Filter under Maintenance .
14	Air in garden and/or high pressure hose.	Turn off the engine, then the cold water source. Disconnect the cold water source from the pump inlet and turn the cold water source on to remove all air and debris from the hose. When there is a steady stream of water present, turn cold water source off. Reconnect cold water source to pump inlet and turn on water source. Squeeze the spray gun trigger for approximately 30 seconds or until a steady stream of water is present.
15	Choke in the CLOSED position.	Move choke to the OPEN position.
16	High pressure hose is too long.	Use high pressure hose under 50 feet (15.24 m). Lengthen water supply hose instead of high pressure hose.
17	Spray wand not in low pressure.	See Spray Wand Nozzles under Operation .
18	Chemical/soap filter clogged.	Clean chemical/soap filter.
19	Chemical/soap filter not in cleaning solution.	Make sure filter end of chemical/soap hose is fully submerged into chemical/cleaning soap.
20	Chemical/cleaning soap too thick.	Dilute chemical/cleaning soap. Chemical/cleaning soap should be the same consistency as water.
21	Worn seal or packing.	Have parts cleaned or replaced by authorized service center.
22	Chemical/cleaning soap build up in chemical injector.	Have replaced by an authorized service center.
23	Worn or obstructed valves.	Have replaced by authorized service center.
24	Worn unloader piston.	Have replaced by authorized service center.
25	Worn or broken o-ring.	Check and replace.
26	Loose hose connection.	Tighten.
27	Piston packings worn.	Have replaced by authorized service center.
28	Pump head or tubes damaged from freezing.	Have replaced by authorized service center.
29	Air filter filled with oil.	Clean air filter element. Refer to engine instruction manual for correct procedure.
30	LED lights on the Pressuready® are flashing indicating a problem.	See the PRESSUREADY® Fault Codes Table for problem. After problem is solved clear and reset the fault code. 1. Press the ON/STOP button to clear and reset the fault code. 2. If the fault code does not clear, remove and reinstall battery.

PRESSUREADY® FAULT CODES

If the unit experiences any issues, the advanced electronics can help you understand what is needed. After diagnosing and solving the system fault, clear and reset the fault code.





To Reset



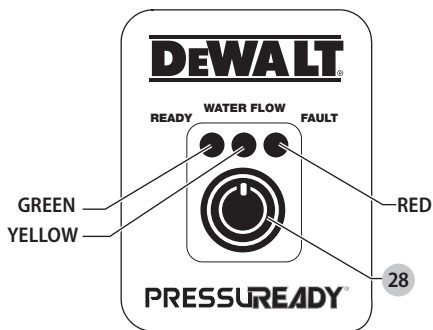





















1. Press the ON/STOP button **28** to clear and reset the fault code.
2. If the fault code does not clear, remove and reinstall battery.















Please refer to the use and care manual for more details.



Please scan the QR code on the handle or call our toll free number 877-362-4271 for assistance with fault codes or to locate your nearest authorized service center.



NO PROBLEM		Green light ON = System Ready to Start
A SYSTEM FAULT IS INDICATED		When a system fault occurs, the yellow light illuminates ON while the red light flashes in a sequence, then the yellow light turns OFF and the red light will continue to flash in a different sequence.
		See the chart to determine the System Fault. Count the sequence of the red light flashes to determine the system fault. All light sequences will continue to repeat until the problem is corrected. After diagnosing and solving the system fault, clear and reset the fault code.
		Example: The yellow light illuminates ON and the red light flashing once, then the yellow light turns OFF and the red light flashes once, this indicates "the engine will not start" system fault. This light sequences will continue to repeat until the problem is corrected.

RED/YELLOW LIGHT SEQUENCE	POSSIBLE FAULT	POSSIBLE SOLUTION	RED/YELLOW LIGHT SEQUENCE	POSSIBLE FAULT	POSSIBLE SOLUTION
   	Engine will not start: (1.1)	Place engine ON/OFF switch in ON position	   	Engine suddenly stopped running: (3.1)	Empty fuel tank, need to add fuel
		Connect garden hose and turn water flow ON			Oil level low, need to add oil
		Place the unit on a level surface	   	Engine speed is to high: (3.2)	Take to authorized service center
		Fill fuel tank			
		Fill engine oil	   	Battery voltage low: (4.1)	Charge battery
		Attach spark plug wire			
   	Unit will not "power on": (2.1)	Air filter filled with oil. Clean air filter element. Refer to engine instruction manual for correct procedure.	   	Battery fault: (4.2)	Replace the battery
		Take to authorized service center			

RED/YELLOW LIGHT SEQUENCE	POSSIBLE FAULT	POSSIBLE SOLUTION
 	Battery temperature too low: (5.1)	Outside temp too low, do not operate
 	Battery temperature too high: (5.2)	Outside temp too high, do not operate
 	Battery fault: (5.3)	Replace the battery
 	Battery fault: (5.4)	Replace the battery
 	Unit is not on a level surface: (6.1)	Place on level surface
 	Unit is not on a level surface: (6.2)	Place on level surface
  The yellow light turns OFF and the red light flashes a 1, 2, 3 or 4 sequence.	Water flow sensor fault: (7.1 + .2 .3 .4)	Take to authorized service center

RED/YELLOW LIGHT SEQUENCE	POSSIBLE FAULT	POSSIBLE SOLUTION
  The yellow light turns OFF and the red light flashes a 1, 2, 3, 4, 5, 6 or 7 sequence.	Water flow sensor fault: (8.1 + .2 .3 .4 .5 .6 .7)	Take to authorized service center

QUICK SETUP GUIDE

WARNING: To reduce the risk of injury, read the pressure washer instruction manual and the engine instruction manual before operating pressure washer.

A Install the Handle

Slide the handle assembly onto the frame. Align holes, insert saddle bolts and secure in place with knobs. Tighten until snug. Align holes in the top handle with the mounting holes in the handle assembly. Insert saddle bolts through aligned holes and secure top handle to handle assembly with knobs. Tighten until snug.

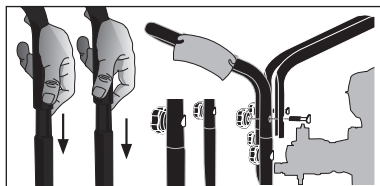

B Add/Check Oil

The engine is shipped without oil. Before starting engine, add the oil provided. Check oil level prior to each use. Refer to **Engine Owner's Manual** for complete procedure.

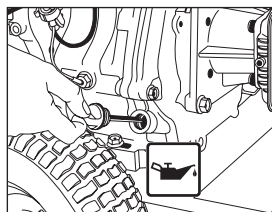

C Add Gasoline

In a well ventilated outdoor area add fresh, high quality, unleaded gasoline with a pump octane rating of 86 or higher. Do not overfill. Wipe up spilled fuel before starting the engine. Refer to **Engine Owners Manual** for complete procedure.

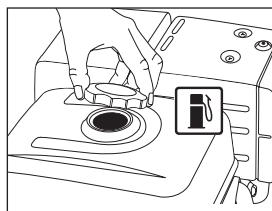

IMPORTANT: Ethanol Shield™ (sold separately) is a fuel stabilizer that helps eliminate and prevent ethanol related problems in power equipment. Follow the instructions on the container and add to the gasoline.

QUICK START GUIDE

DANGER:

- Never run engine indoors or in enclosed, poorly ventilated areas. Engine exhaust contains carbon monoxide, an odorless and deadly gas.
- Risk of fluid injection and laceration. When using the high-pressure setting, DO NOT allow the high-pressure spray to come in contact with unprotected skin, eyes or with any pets or animals. Serious injury will occur.

WARNING: WHEN OPERATING IN MANUAL MODE ONLY: Do not allow the unit to run for more than two minutes without the spray gun trigger being pulled. This could cause overheating and damage to the pump. When the temperature inside the pump rises too high, the thermal relief valve will open and release a spray of water from the pump to lower the internal temperature. The valve will then close.

1 Place the Engine ON/OFF switch in the OFF position

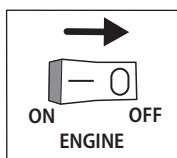

2 Connect Garden Hose to Pump

Remove air and flush debris from garden hose before connecting to pump.

Thread the garden hose to the pump inlet.

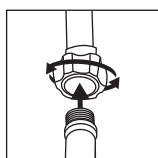

3 Connect High Pressure Hose to Pump

Connect the high pressure hose to the pump outlet.

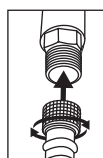

4 Connect High Pressure Hose to Spray Gun

Connect the other end of the high pressure hose to the spray gun.

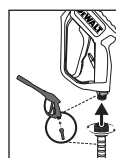

5 Connect Spray Wand to Spray Gun

Thread the spray wand into the end of the spray gun.

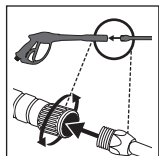

6 Connect QC Nozzles to Spray Wand

Pull quick connect coupler back and insert nozzle. Release quick connect coupler and twist nozzle to make sure it is secure in coupler.

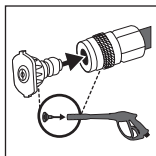

7 Turn Water Faucet Completely On

Do not run the unit without cold water supply connected and turned on. Use Cold Water Only.

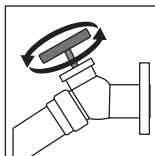

8 Release Air from System

Release all air from pump and high pressure hose by squeezing the spray gun trigger until a steady stream of water is present. Approximately 30 seconds.



9 Open Battery Housing Cover

Push the spring lock down to unlock the cover. Pull cover up to open.

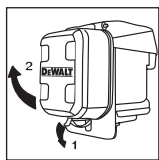

10 Insert the battery pack into the battery housing

Slide battery pack into housing until it clicks in place. Close and lock the battery housing cover.

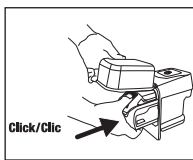

11 Place the Engine ON/OFF switch in the ON position

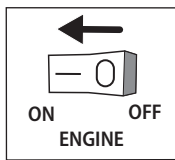

12 Place the fuel valve lever in the ON position.

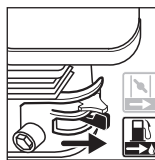

13 Press the PRESSUREADY® START/STOP button for 2 seconds

The green READY light will illuminate.

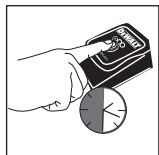

14 Start the Engine:

Depress the spray gun trigger to start the engine. Release the spray gun trigger to stop the engine. Squeeze the spray gun trigger to restart the engine.

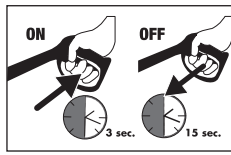

10 Place the fuel valve lever in the ON position.

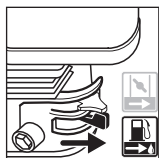

11 Move the Choke to the CLOSED Position

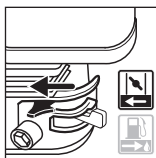

12 Pull the Recoil Starter Grip

Pull the recoil starter grip to start the engine.

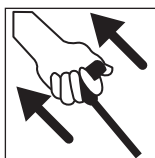

13 Move the Choke to the OPEN Position

Gradually move the choke to the OPEN position after engine starts.

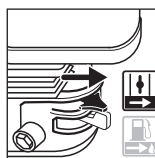

ALTERNATE MANUAL MODE STARTING INSTRUCTIONS

START WITH THIS STEP 9 AFTER FOLLOWING STEPS 1-8

9 Place the Engine ON/OFF switch in the ON position

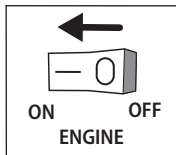

WARNING: This Guide is not a substitute for reading the operator's manual. User must read and understand operator's manual before using this product.

Compatible battery packs and chargers

20V Max* Li-Ion	Battery Packs	DCB200, DCB201, DCB203, DCB204, DCB204BT**, DCB205, DCB205BT**, DCB206, DCB208, DCB230, DCB240
	Chargers	DCB101, DCB103, DCB104, DCB107, DCB112, DCB113, DCB115, DCB118, DCB132
60V Max* Li-Ion	Battery Packs	DCB606, DCB609, DCB612
	Chargers	DCB101, DCB103, DCB104, DCB107, DCB112, DCB113, DCB115, DCB118, DCB132

* Maximum initial battery voltage (measured without a workload) is 20 or 60 volts. Nominal voltage is 18 or 54.

**BT - Bluetooth®

NOTE: The Bluetooth® word mark and logos are registered trademarks owned by the Bluetooth®, SIG, Inc. and any use of such marks by DeWALT is under license. Other trademarks and trade names are those of their respective owners.



WARNING: Use of any other battery packs may create a risk of injury and fire.

The FNA Group, Inc., 7152 99th Street Pleasant Prairie, WI 53158
(FEB20) Part No. 7111237 Copyright © 2020

The following are trademarks for one or more DeWALT power tools: the yellow and black color scheme, the "D" shaped air intake grill, the array of pyramids on the handgrip, the kit box configuration, and the array of lozenge-shaped humps on the surface of the tool. DeWALT®, GUARANTEED TOUGH® and the yellow and black color scheme are trademarks the DeWALT Industrial Tool Co., used under license. SIMPSON® and PRESSUREADY® are registered trademarks of the FNA Group, Inc.

The FNA Group, Inc., 7152 99th Street Pleasant Prairie, WI 53158, a licensee of DeWALT Industrial Tools