

Comfort Glow®

VENT-FREE NATURAL GAS HEATER OWNER'S OPERATION AND INSTALLATION MANUAL

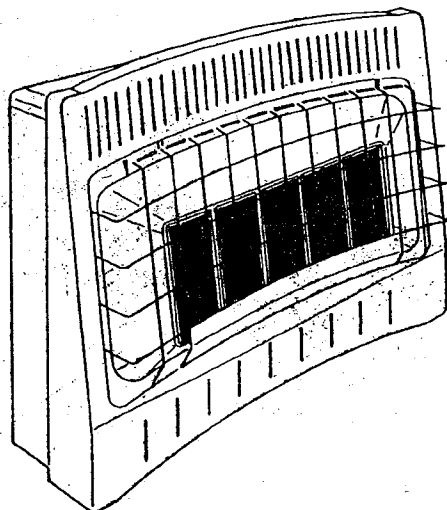

Models: CGR18N and CGR30N

WARNING: If the information in this manual is not followed exactly, a fire or explosion may result causing property damage, personal injury, or loss of life.

- Do not store or use gasoline or other flammable vapors and liquids in the vicinity of this or any other appliance.
- **WHAT TO DO IF YOU SMELL GAS**
 - Do not try to light any appliance.
 - Do not touch any electrical switch; do not use any phone in your building.
 - Immediately call your gas supplier from a neighbor's phone. Follow the gas supplier's instructions.
 - If you cannot reach your gas supplier, call the fire department.
- Installation and service must be performed by a qualified installer, service agency, or the gas supplier.

This appliance may be installed in an aftermarket* manufactured (mobile) home, where not prohibited by state or local codes.

*Aftermarket: Completion of sale, not for purpose of resale, from the manufacturer.

This appliance is only for use with the type of gas indicated on the rating plate. This appliance is not convertible for use with other gases.



Save this manual for future reference.

REPAIR PARTS LIST MODELS CGR18N and CGR30N

Installation accessories
package

DESA

INTERNATIONAL

2701 Industrial Drive
P.O. Box 90004
Bowling Green, KY 42102-9004

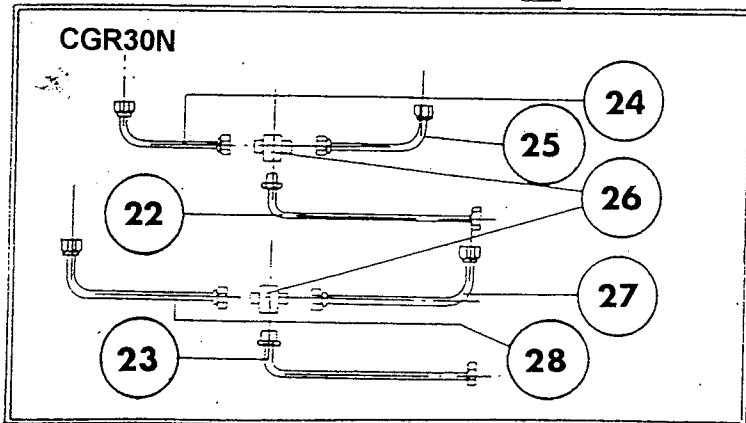
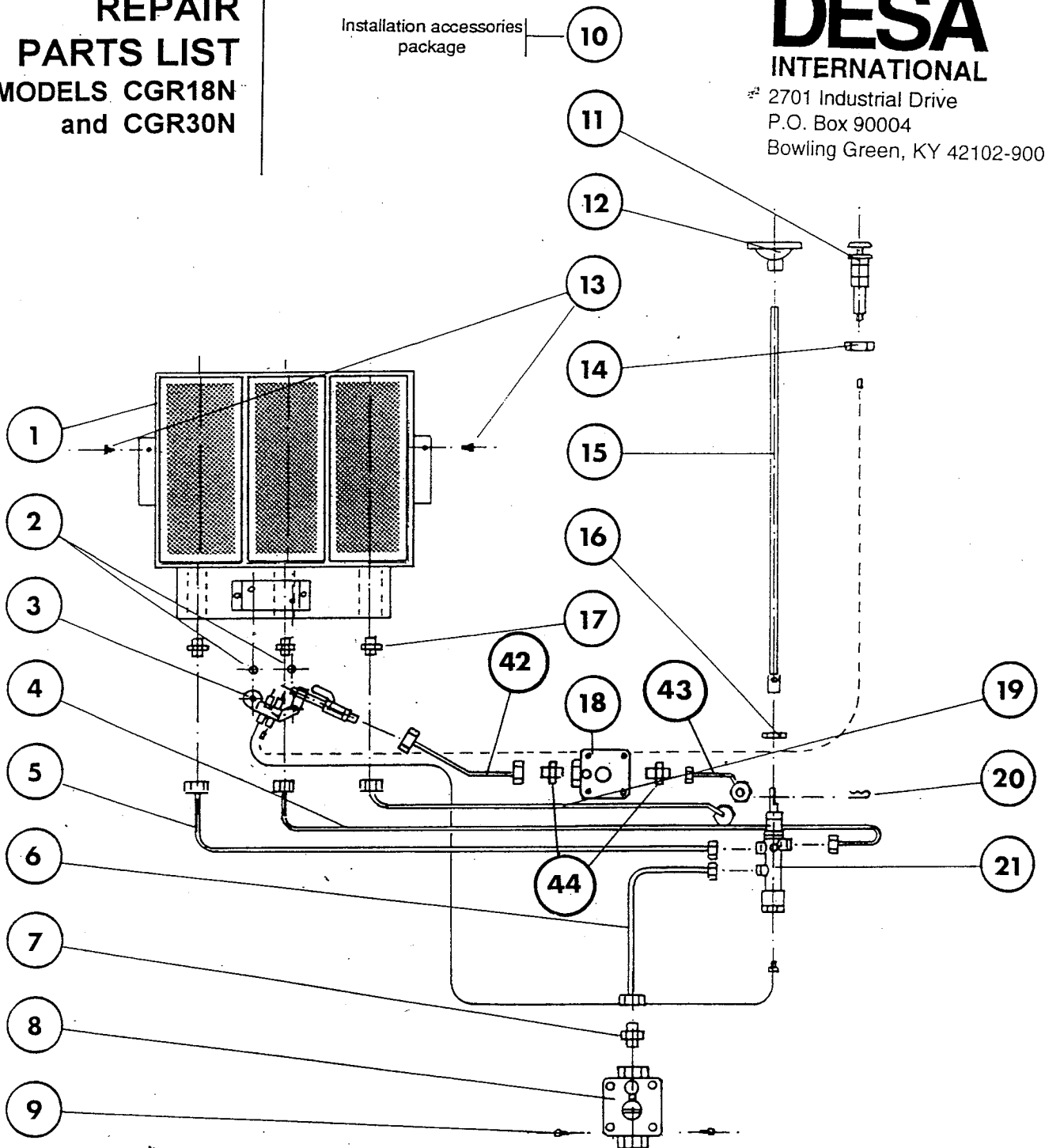

**REPAIR
PARTS LIST**
MODELS CGR18N
and CGR30N
Continued

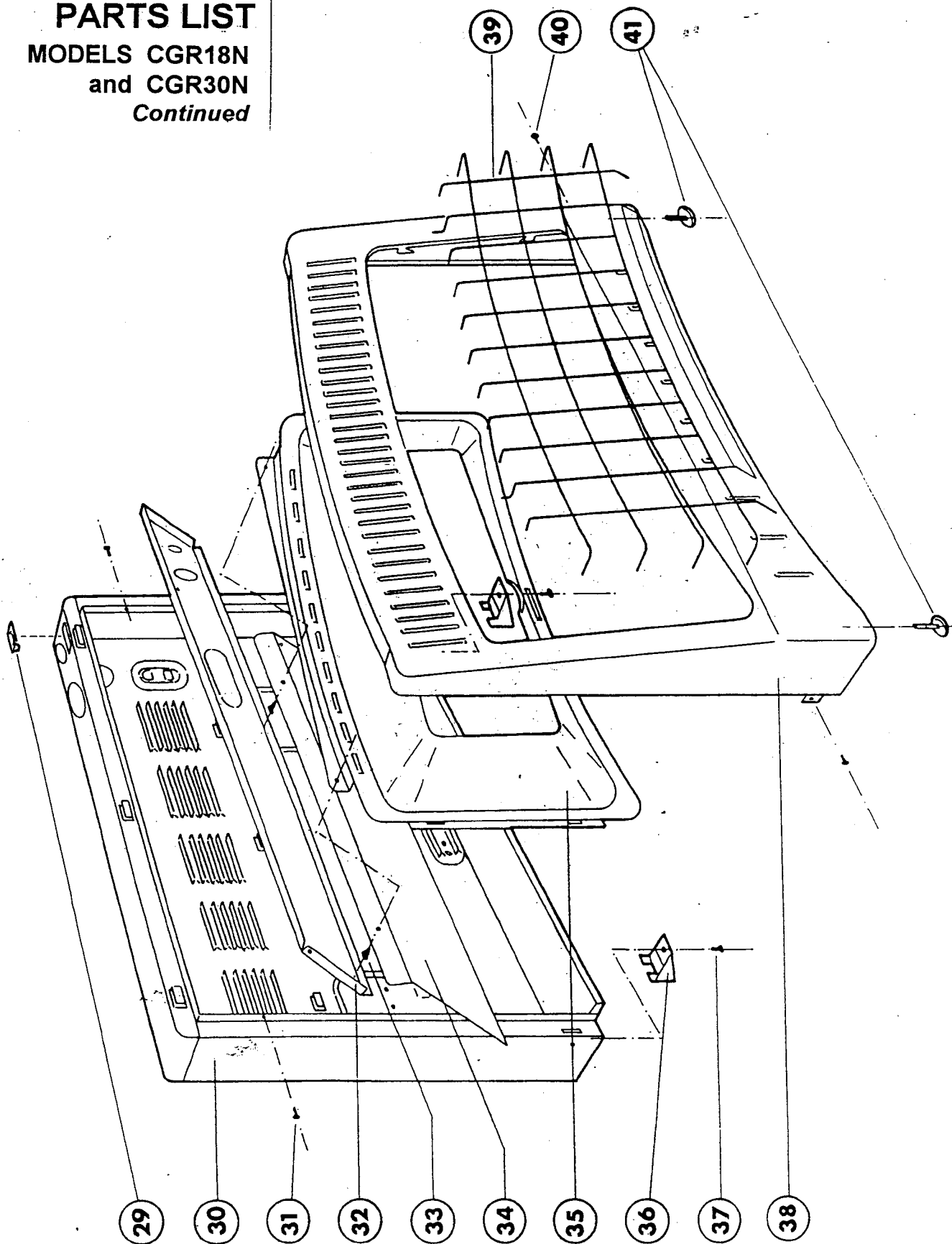

REPAIR PARTS LIST MODELS CGR18N and CGR30N

Continued

Note: Use only original replacement parts. This will protect your warranty coverage for parts replaced under warranty.

Parts Under Warranty

Contact authorized dealer from whom you purchased this product. If they are unable to supply original replacement part(s), call DESA International's Technical Service Department at 1-800-323-5190 for information.

When contacting your dealer or DESA International, have ready:

- your name
- your address
- model number of your heater
- how heater was malfunctioning
- type of gas used (propane or natural gas)
- purchase date

Usually, we will ask you to return the defective part to the factory.

Parts Not Under Warranty

Contact authorized dealers of this product. If they can't supply original replacement part(s), call DESA International's Parts Department at 1-800-972-7879 for referral information. When calling DESA International, have ready:

- model number of your heater
- the replacement part number

INDEX Nº	NATURAL GAS MOD.		DESCRIPTION
	CGR18N	CGR30N	
1	BY80.100.057	BY80.100.058	Burner
2	BY13.311.592	BY13.311.592	Screw
3	BY80.300.011	BY80.300.012	ODS assembly
4	BY83.000.425	BY83.000.426	Valve tubing #1 setting
5	BY83.000.428	BY-----	Valve tubing #2 setting
6	BY83.000.650	BY83.000.650	Tubing valve to regulator
7	BY83.500.365	BY83.500.365	Regulator inlet-adaptor
8	BY36.210.045	BY36.210.045	Regulator
9	BY13.490.075	BY13.490.075	Screw M 3,5
10	BY75.300.043	BY75.300.043	Installation accessories
11	BY50.000.048	BY50.000.048	Piezo igniter
12	BY73.010.509	BY73.010.509	Control knob
13	BY13.311.592	BY13.311.592	Screw
14	BY13.650.056	BY13.650.056	Nut M 18
15	BY72.400.069	BY72.400.069	Control rod
16	BY13.650.004	BY13.650.004	Nut M15
17	BY83.300.181	BY83.300.167	Orifice
18	BY36.210.014	BY36.210.014	Regulator P 3.5"
19	BY83.000.429	BY-----	Valve tubing #3 setting
20	BY18.300.017	BY18.300.017	Votter clip
21	BY93.610.083	BY83.610.083	Control valve
22	BY-----	BY83.000.437	Valve tubing #2 setting
23	BY-----	BY83.000.439	Valve tubing #3 setting
24	BY-----	BY83.000.711	Tubing #2 setting left
25	BY-----	BY83.000.708	Tubing #2 setting right
26	BY-----	BY83.500.287	T connector
27	BY-----	BY83.000.709	Tubing #3 setting right
28	BY-----	BY83.000.710	Tubing #3 setting left
29	BY70.001.456	BY70.001.456	Cover
30	BY62.400.047	BY62.400.046	Casing
31	BY13.310.652	BY13.310.652	Screw
32	BY62.200.472	BY62.200.473	Top heat shield
33	BY13.310.652	BY13.310.652	Screw
34	BY62.200.708	BY62.200.707	Bottom heat shield
35	BY62.100.526	BY62.100.525	Frontal reflector
36	BY71.200.160	BY71.200.160	Rear leg
37	BY13.311.272	BY13.311.272	Screw
38	BY64.160.017	BY64.160.018	Frontal frame
39	BY74.110.277	BY74.110.276	Safety Guard
40	BY13.310.652	BY13.310.652	Screw
41	BY71.200.163	BY71.200.163	Frontal leg
42	BY83.000.433	BY83.000.433	Pilot tubing regulator-pilot
43	BY83.000.435	BY83.000.435	Tubing valve-regulator (3.5")
44	BY83.500.166	BY83.500.166	Regulator (3.5") inlet adaptor
45	BY22.130.683	BY22.130.683	Operating and Installation Manual

WARRANTY INFORMATION

KEEP THIS WARRANTY

Model _____

Serial No. _____

Date Purchased _____

Always specify model and serial numbers when communicating with the factory.

We reserve the right to amend these specifications at any time without notice. The only warranty applicable is our standard written warranty. We make no other warranty, expressed or implied.

LIMITED WARRANTY CONFORT GLOW VENT-FREE NATURAL GAS HEATERS

DESA International warrants this product and any parts thereof, to be free from defects in material and workmanship for one year from the date of first purchase, provided that the product has been properly installed, operated, and maintained in accordance with all applicable instructions. To make a claim under this warranty, the bill of sales or proof of purchase must be presented.

This warranty is extended only to the original retail purchaser. This warranty covers only the cost of parts and an allowance for labor required to restore this heater to proper operating condition. Warranty parts must be obtained through authorized dealers of this product and/or DESA International who will provide original factory replacement parts. Failure to use original factory replacement parts voids this warranty. The heater must be installed by a qualified installer in accordance with all local codes and instructions furnished with the unit.

This warranty does not apply to parts that are not in original condition because of normal wear and tear, or parts that fail or become damaged as a result of misuse, accidents, lack of proper maintenance, alteration, tampering, contaminated fuels, or defects caused by improper installation. Travel, transportation, and incidental costs associated with warranty repairs are not reimbursable under this warranty and are the responsibility of the owner.

To the full extent allowed by the law of the jurisdiction that governs the sale of the product, this express warranty excludes any and all other expressed warranties and limits the duration of any and all implied warranties, including warranties of merchantability and fitness for a particular purpose to one year from the date of first purchase; and DESA International's liability is hereby limited to the purchase price of the product and DESA International shall not be liable for any other damages whatsoever including indirect, incidental, or consequential damages.

Some states do not allow a limitation of how long an implied warranty lasts or an exclusion or limitation of incidental or consequential damages, so the above limitation of implied warranties, or exclusion, or limitation of damages may not apply to you.

This warranty provides the original retail purchaser with specific legal rights. For specific information regarding those rights, please consult the applicable state laws.

For information about this warranty write:

DESA
INTERNATIONAL

2701 Industrial Drive
P.O. Box 90004
Bowling Green, KY 42102-9004