



INSTALLATION INSTRUCTIONS FOR PCBE-36C CONVERSION KIT From Natural Gas to Propane/LP Gas

For more information, visit desatech.com

For Use When Converting Models CB36NE and VCB36NE

This conversion kit must be installed by a qualified service agency.

Read these instructions completely before installing this conversion kit.

Before proceeding, make sure the gas control valve is in the OFF position, all electrical power to the appliance is off, and the fireplace is cool to the touch.

CAUTION: The gas supply shall be shut off prior to disconnecting the electrical power before proceeding with the conversion.

Parts included with this kit:

Part No.	Description	Qty.
117435-01	Instruction Sheet	1
108867-01	Pilot Orifice LP (0.014")	1
26482	Main Burner Orifice (#55)	1
108402-02	Gas Valve Regulator LP	1
116635-08	Conversion Label, English	1
116636-08	Conversion Label, French	1
106080-01	Conversion Information Label	1
106739-01	Registration Gas Conversion	1

Tools Required

- 7/8" Open End Wrench or Adjustable Wrench
- 3/4" Open End Wrench or Adjustable Wrench
- Torx T20 or Slotted Screwdriver
- 7/16" Open End Wrench
- #2 Short Phillips Screwdriver
- Thread Sealant (Resistant to Propane/LP)

ACCESSING FIREPLACE

The gas control valve is located under the fireplace and is accessed by removing the lower louver panel.

The pilot and main burner orifice are accessed by removing the glass door, logs and main burner.

Removing Lower Louver Access Panel

1. With your index fingers locate the left and right spring latches found just under the top louver and draw them inward to release the pins holding the panel on the side face (see **Figure 1**).
2. Swing the louver panel out until it clears the fireplace opening.
3. Pull the entire panel out until the bottom tabs are free of the slots in the lower face frame.

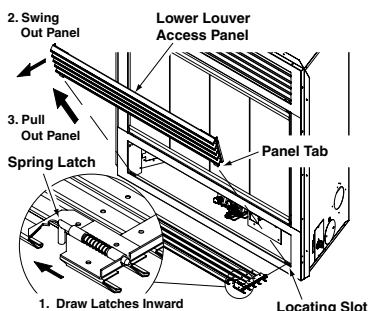

Figure 1 - Removing Lower Louver Access Panel

Removing/Replacing Glass Door

Remove the glass door to access the log and burner assembly as follows:

1. Place a screw driver or your finger tips into the gap between the lower glass panel rail and the bottom face frame and lift glass door assembly until the door pins clear the locating holes in the bottom face frame (see **Figure 2**, page 2).
2. Swing bottom glass panel assembly out until the door pins on the lower rail clear the bottom face frame (see **Figure 3**, page 2).
3. Lower the door down until the upper door pins are free of the locating holes in the spring clips. Place glass panel in a safe area.
4. Replace glass panel by inserting the top door pins into the spring clips, lifting up at the lower frame rail, and locating the bottom pins in the holes on the lower face frame.

Save this manual for future reference.



ACCESSING FIREPLACE Continued

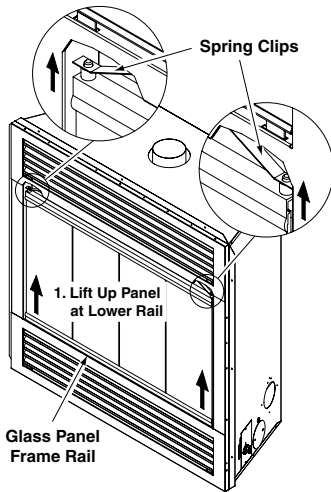

Figure 2 - Removing/Replacing Glass Door

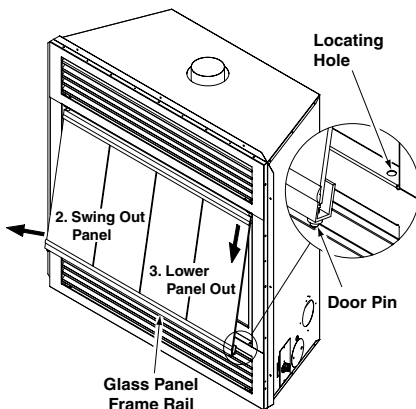

Figure 3 - Removing/Replacing Glass Door

CONVERSION INSTRUCTIONS

Burner Orifice Conversion

1. Remove top, rear and base logs. See **Figure 4**.
2. Remove two screws holding the pilot bracket to rear of the burner pan. (see **Figure 4**).
3. Remove two screws holding the rear log stand to the rear panel of the firebox (see **Figure 4**).
4. Expose the main burner orifice by lifting the burner pan assembly off the orifice mount.
5. Use a 1-1/8" back-up wrench on the bulkhead fitting and a 11/16" wrench to remove the main burner orifice (see **Figure 5**, page 3).
6. Apply thread sealant to the male end of the #55 main burner orifice included with the kit and remount the orifice into the bulkhead fitting.
7. Loosen the set screw on the main burner air shutter, rotate to 3/4" open, and retighten the set screw (see **Figure 6**, page 3).
8. Reposition burner with air shutter placed over the orifice mount and replace two screws on rear log stand and two screws at pilot assembly.

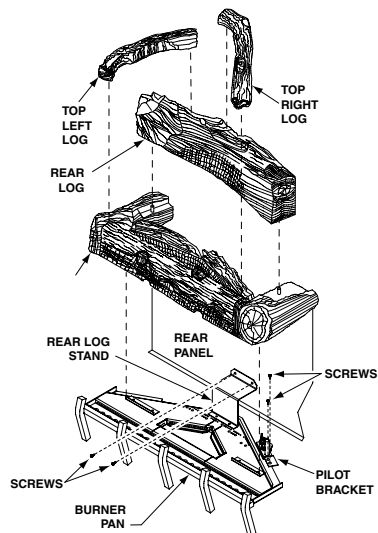

Figure 4 - Removing Logs and Burner Assembly

CONVERSION INSTRUCTIONS

Continued

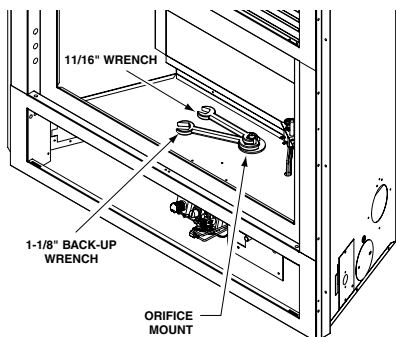

Figure 5 - Removing Main Burner Orifice

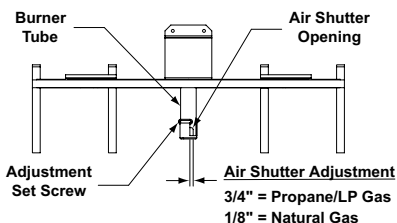

Figure 6 - Adjusting Air Shutter

Gas Control Conversion

Convert the gas control by swapping out the valve regulator portion of the gas valve.

1. Using a Torx T20 or slotted screwdriver, remove and discard the three mounting screws, pressure regulator tower, and diaphragm/spring components (see **Figure 7**).
2. Insure that the rubber gasket is properly positioned on the new pressure regulator assembly. Install LP pressure regulator assembly to valve using the new mounting screws supplied with the kit. Tighten screws securely (@ approximately 25 in-lbs.) (see **Figure 8**).
3. Install the identification label enclosed with the gas valve regulator to the valve body, where it can easily be seen (see **Figure 8**).

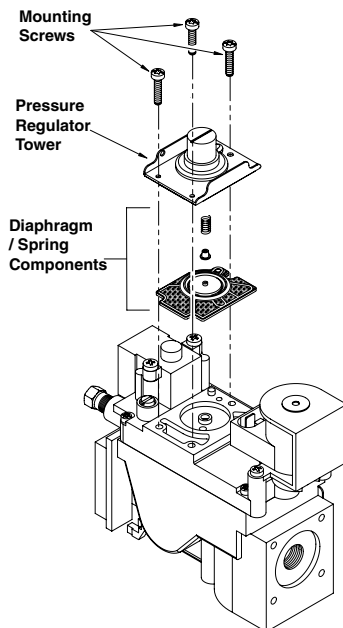

Figure 7 - Removing Mounting Screws, Regulator Tower, and Diaphragm/Spring Components

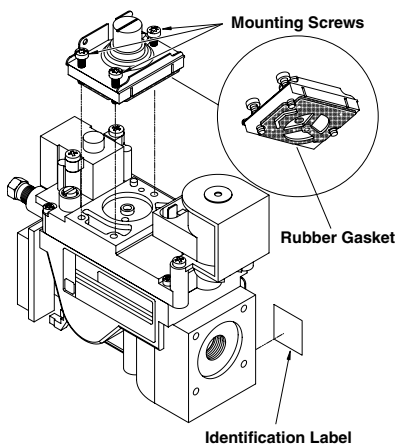

Figure 8 - Installing Pressure Regulator Assembly

CONVERSION INSTRUCTIONS Continued

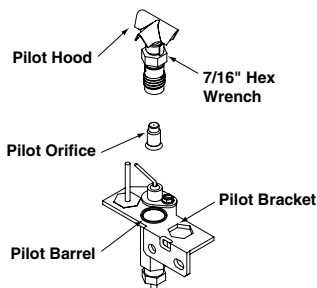

Figure 9 - Converting Pilot Orifice
Pilot Orifice Conversion

1. Remove the pilot hood assembly from barrel using a 7/16" open end wrench (see **Figure 9**).
2. Remove the pilot orifice from inside the barrel with tweezers or a pair of needle nose pliers.
3. Replace pilot orifice with the propane/LP orifice supplied with this kit. The number 14 is stamped on the sleeve for identification. Insert the open end of the new pilot orifice into the barrel and thread the pilot hood back onto the barrel.
4. Tighten the pilot hood using the 7/16" open end wrench until the hood is fully seated and in-line with the bracket.

IMPORTANT: Be careful not to bend or kink the aluminum tubing during conversion. Make sure the pilot hood and orifice are properly mated and aligned after finishing the conversion.

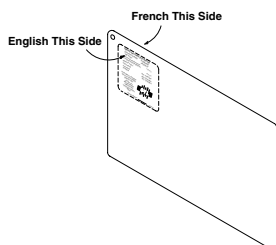

Figure 10 - Applying Conversion Labels

Conversion Labeling and Placement

1. Apply the English and French conversion labels over existing certification labels (see **Figure 10**). Existing certification labels are located on the lighting instruction plate inside the gas valve compartment area. With permanent ink, print the previous model number on the label in the space provided (see **Figure 11**).
2. After filling in the data required on the conversion information label (see **Figure 12**), affix it to the floor of the appliance where it is easily seen when the lower louver access panel is removed.

VENTED GAS FIREPLACES	
Conversion Kit Model	PCBE-36C
Type of Gas	Propane/LP
Minimum Inlet Supply Pressure	11.0" w.c.
For Purpose of Input Adjustment	
Manifold Pressure	10.0" w.c.
Input Rating (0-4500 Ft)	Max. 18,000 Btu/h
Orifice Size:	No. 55 DMS
Electrical Rating: 120 volts / 60HZ / 1 Phase / less than 12 amps	
This Appliance is Equipped with an S.I.T. Nova Model 0.822.072 Valve	
Complies with ANS Z21.50a-2003 CSA 2.22a-2003 Vented Gas Fireplaces	
	
Previous Model #	116635-08

Figure 11 - Print Previous Model Number on Conversion Labels

CONVERSION INFORMATION LABEL	
This appliance was converted on	
Day	Month Year to gas
with Kit No. _____	
by _____	
(name and address of organization making this conversion), which accepts the responsibility that this conversion has been properly made.	
56060	106080-01

Figure 12 - Conversion Information Label

CONVERSION INSTRUCTIONS

Continued

Final Preparation

1. Reinstall logs. Refer to *Installing Logs and Glowing Embers* in owner's manual.
2. Leak check the gas control and any connections you've made before operating appliance. Refer to *Checking Gas Connections* in owner's manual.
3. Replace and latch door. Refer to *Removing/Replacing Glass Door*, page 2.
4. Reinstall bottom then top louvers panels.

The conversion is now complete.

To operate your fireplace, refer to *Operating Fireplace* in our appliance owner's manual.

⚠ WARNING: Test all gas piping and connections for leaks after installation or servicing. Correct leaks at once.

⚠ WARNING: Never use an open flame to check for a leak. Apply noncorrosive leak detection fluid to all joints. Bubbles forming show a leak. Correct all leaks at once.

⚠ WARNING: This conversion kit shall be installed by a qualified service agency in accordance with the manufacturer's instructions and all applicable codes and requirements of the authority having jurisdiction. If the information in these instructions is not followed exactly, a fire, explosion, or production of carbon monoxide may result causing property damage, personal injury, or loss of life.

The qualified service agency is responsible for the proper installation of this kit. The installation is not proper and complete until the operation of the converted appliance is checked as specified in the manufacturer's instructions supplied with the kit.

WARRANTY AND REPAIR SERVICE

KEEP THIS WARRANTY

Model _____

Serial No. _____

Date Purchased _____

Always specify model and serial numbers when communicating with the factory.

We reserve the right to amend these specifications at any time without notice. The only warranty applicable is our standard written warranty. We make no other warranty, expressed or implied.

LIMITED WARRANTY PCBE-36C PROPANE/LP GAS CONVERSION KIT

DESA warrants this product to be free from defects for one (1) year from the date of first purchase, provided that the product has been properly installed, operated and maintained in accordance with all applicable instructions. To make a claim under this warranty the Bill of Sale or cancelled check must be presented.

This warranty is extended only to the original retail purchaser. This warranty covers the cost of part(s) required to restore this product to proper operating condition and an allowance for labor when provided by a DESA Authorized Service Center. Warranty part(s) MUST be obtained through authorized dealers of this product and/or DESA who will provide original factory replacement parts. Failure to use original factory replacement parts voids this warranty. The product MUST be installed by a qualified installer in accordance with all local codes and instructions furnished with the unit.

This warranty does not apply to parts that are not in original condition because of normal wear and tear or parts that fail or become damaged as a result of misuse, accidents, lack of proper maintenance or defects caused by improper installation. Travel, diagnostic cost, labor, transportation and any and all such other costs related to repairing a defective product will be the responsibility of the owner.

TO THE FULL EXTENT ALLOWED BY THE LAW OF THE JURISDICTION THAT GOVERNS THE SALE OF THE PRODUCT; THIS EXPRESS WARRANTY EXCLUDES ANY AND ALL OTHER EXPRESSED WARRANTIES AND LIMITS THE DURATION OF ANY AND ALL IMPLIED WARRANTIES, INCLUDING WARRANTIES OF MERCHANTABILITY AND FITNESS FOR A PARTICULAR PURPOSE TO ONE (1) YEAR FROM THE DATE OF FIRST PURCHASE; AND DESA'S LIABILITY IS HEREBY LIMITED TO THE PURCHASE PRICE OF THE PRODUCT AND DESA SHALL NOT BE LIABLE FOR ANY OTHER DAMAGES WHATSOEVER INCLUDING INDIRECT, INCIDENTAL OR CONSEQUENTIAL DAMAGES.

Some states do not allow a limitation on how long an implied warranty lasts or an exclusion or limitation of incidental or consequential damages, so the above limitation on implied warranties or exclusion or limitation on damages may not apply to you.

This warranty gives you specific legal rights and you may also have other rights that vary from state to state. For information about this warranty write:



2701 Industrial Drive
P.O. Box 90004
Bowling Green, KY 42102-9004
www.desatech.com



117435-01
NOT A UPC

117435-01
Rev. A
08/05

For more information, visit desatech.com