

GLO-WARM INFRARED UNVENTED NATURAL /PROPANE GAS HEATER

OWNER'S OPERATION AND INSTALLATION MANUAL

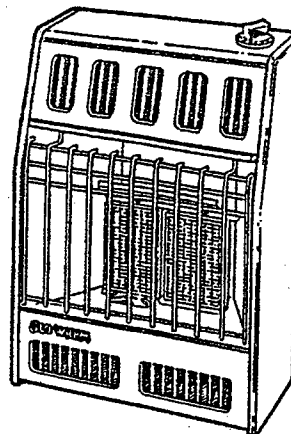
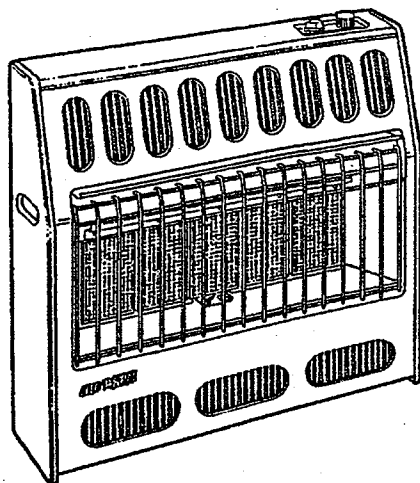

- CAREFULLY READ THIS MANUAL TO UNDERSTAND ALL INSTRUCTIONS ABOUT HOW TO INSTALL AND OPERATE THIS GAS HEATER.
- NEVER USE THIS HEATER IN BEDROOMS, AUTOMOBILES, TRAILERS, RECREATIONAL VEHICLES OR MOBILE HOMES (SEE EXCEPTIONS BELOW).
- ALWAYS KEEP THIS MANUAL FOR REFERENCE.

WARNING: If the information in this manual is not followed exactly, a fire or explosion may result causing property damage, personal injury or loss of life.

-Do not store or use gasoline or other flammable vapors and liquids in the vicinity of this or any other appliance.

-WHAT TO DO IF YOU SMELL GAS

- Do not try to light any appliance.
- Do not touch any electrical switch; do not use any phone in your building.
- Immediately call your gas supplier from a neighbor's phone. Follow the gas supplier's instructions.
- If you cannot reach your gas supplier, call the fire department.

-Installation and service must be performed by a qualified installer, service agency or the gas supplier.

IMPORTANT FOR YOUR SAFETY

- Improper installation, adjustment, alteration, service, or maintenance can cause injury or property damage. Refer to this manual for correct installation and operation procedures.
- For assistance or additional information, consult a qualified installer, service agency, or the gas supplier.

EXCEPTIONS

FA-2, FB-2 may be used in a bedroom or mobile home (check local codes prior to installation).

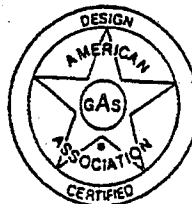

UNIVERSAL HEATING, INC.
3830 Prospect Ave.,
Yorba Linda, CA 92886
Tel:(800)444-5106

IMPORTANT SAFETY RULES *Continued*

IMPORTANT SAFETY RULES

11. Be sure to provide fresh air to the room with a heater for complete combustion. The opening should have at least one square inch of **FREE AIR** opening per 1000 BTU/hour output of heater.
12. Any safety screen or guard removed for servicing this heater must be replaced prior to operation of the heater.
13. **CHECK** all joints or connections. You may use soap suds. **NEVER** check gas leakage with an open flame to avoid the danger of fire, accident or explosion.
14. Turn off heater and let cool before servicing. Only a qualified service person should service and repair the heater.
15. **CLEAN** the area where the heater is placed and **KEEP AWAY FROM** flammable materials, gasoline and other combustible liquids and vapors.
16. **L.P. SUPPLY TANK** must be placed outside the house. It must be installed only in well ventilated area away from the house. The distances must be placed as prescribed by the law. Check local and state codes and laws in order to comply with proper safety requirements.
17. Since the unvented gas heaters may easily increase the amount of humidity in the room, the larger the burner size the more humidity present. This can cause excessive moisture accumulation on windows and other surfaces.

SPECIFICATIONS

Model No.	Max Output BTUH	Type Gas	Pressure Regulator setting (Inches of water)	Main Orifice Drill Size	Dimensions inches			No. of Radiants	Inlet Gas Pressure (Inches of water)	
					Width	Height	Depth		Max	Min
FA-3	18,000	N.G.	6	58	19 1/4	26	9 7/16	3	10.5	6
FAS-3	18,000	N.G.	6	58	19 1/4	26	9 7/16	3	10.5	6
FA-5	30,000	N.G.	6	58	26 9/16	26	9 7/16	5	10.5	6
FAS-5	30,000	N.G.	6	58	26 9/16	26	9 7/16	5	10.5	6
FB-3	15,000	L.P.	10	71	19 1/4	26	9 7/16	3	14	11
FBS-3	15,000	L.P.	10	71	19 1/4	26	9 7/16	3	14	11
FB-5	25,000	L.P.	10	71	26 9/16	26	9 7/16	5	14	11
FBS-5	25,000	L.P.	10	71	26 9/16	26	9 7/16	5	14	11
FA-2	10,000	N.G.	6	58	13 3/4	18	5 1/8	2	10.5	6
FB-2	10,000	L.P.	10	71	13 3/4	18	5 1/8	2	14	11

REMARK: Reduce rating 4% for each 1,000 feet exceeding sea level if elevation is above 2,000 feet. This model has a 100% safety pilot shutoff.
BTUH means Heater rating in "British thermal units per hour".
LP means Liquefied Petroleum.

Model No. : FA-2 FB-2

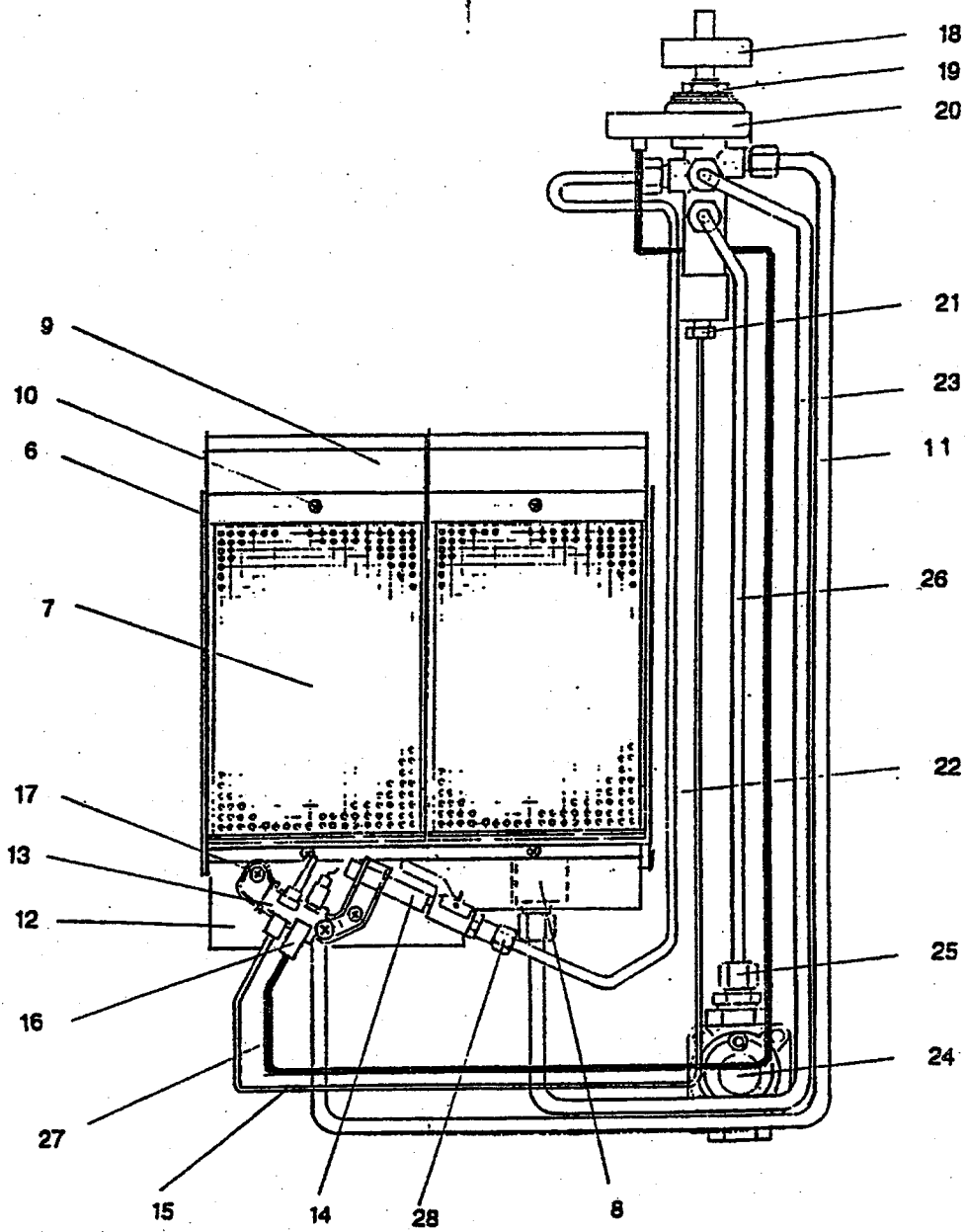

MODEL NO.: FA-3

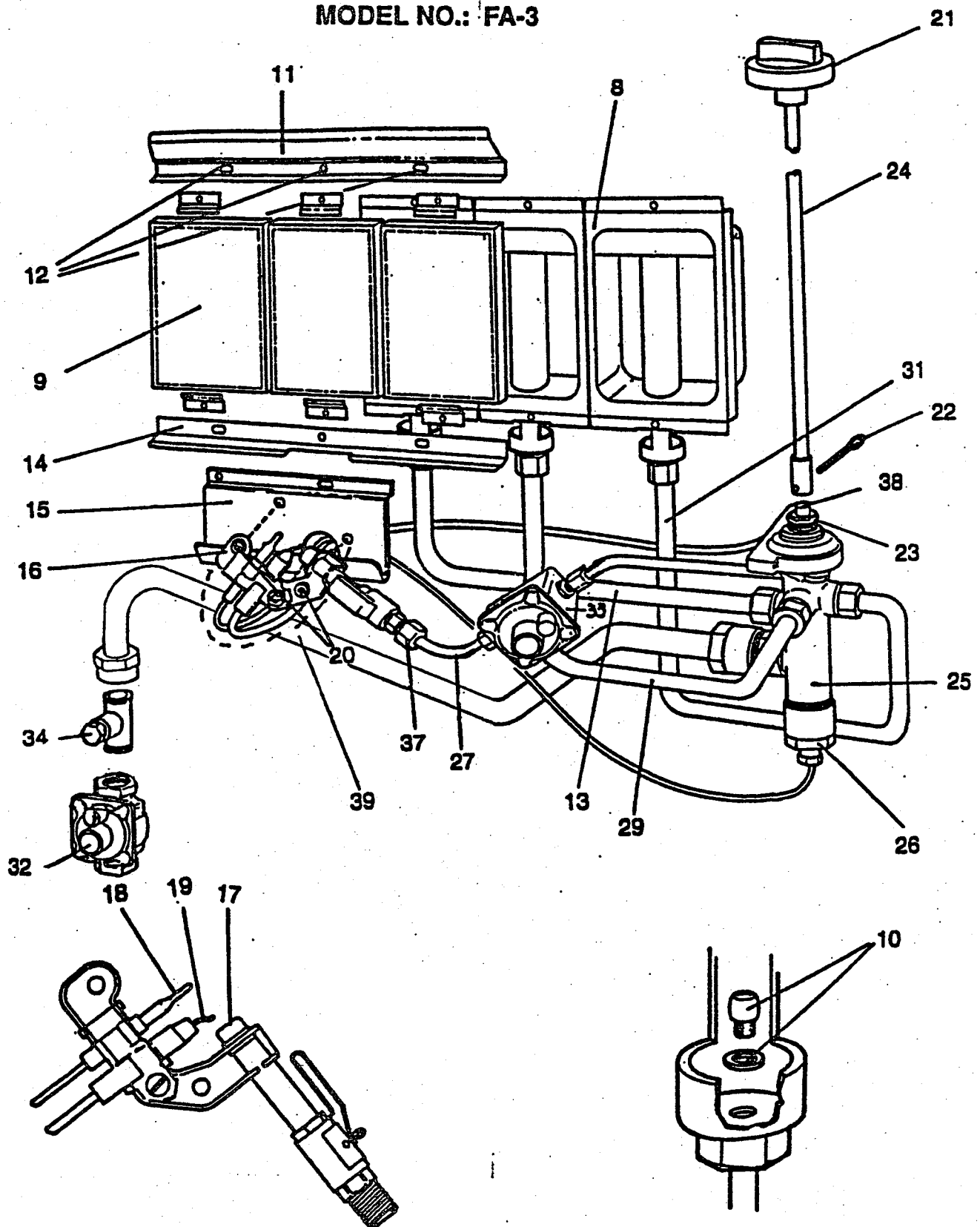

MODEL NO.: FB-3

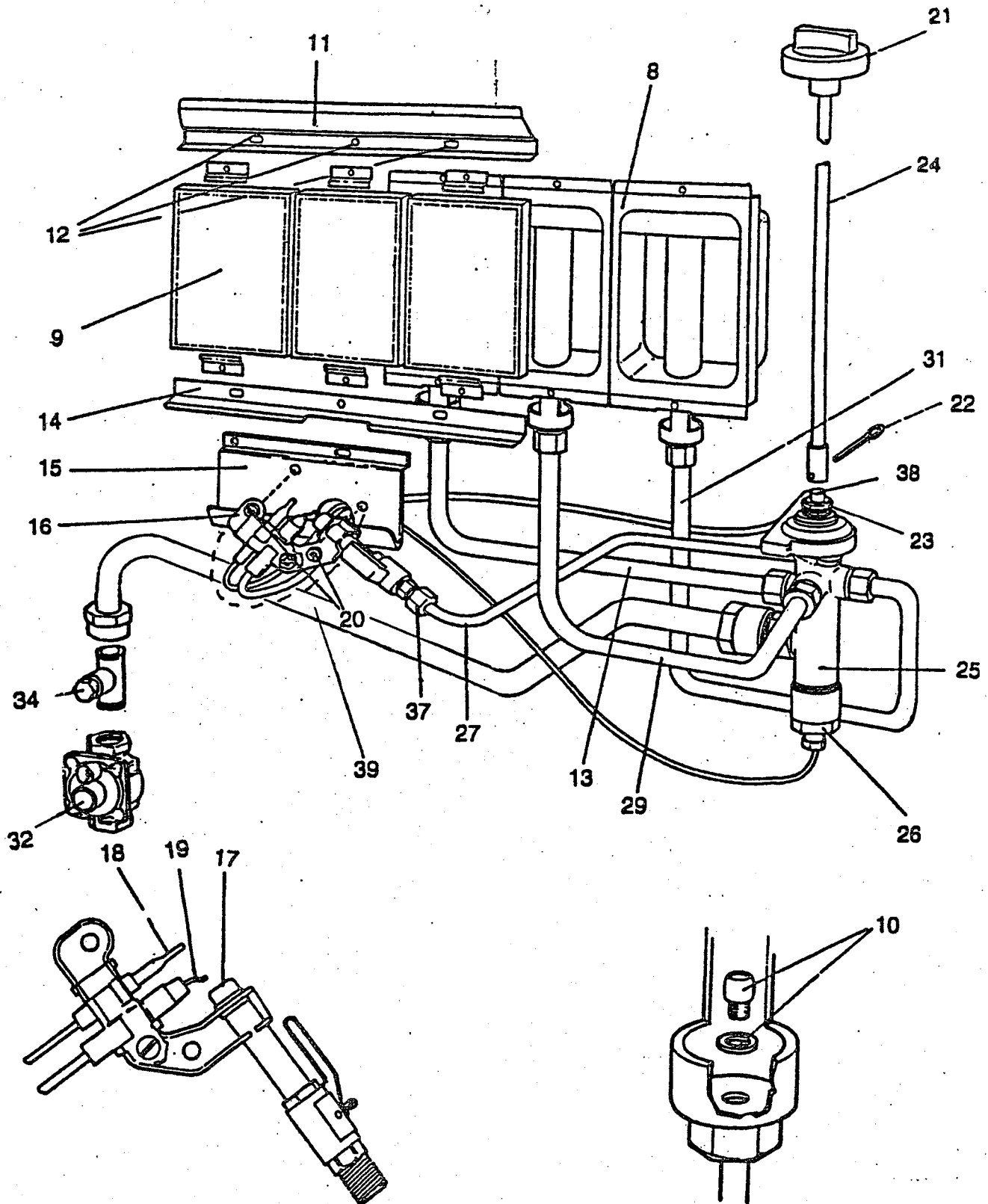

MODEL NO.: FA-5

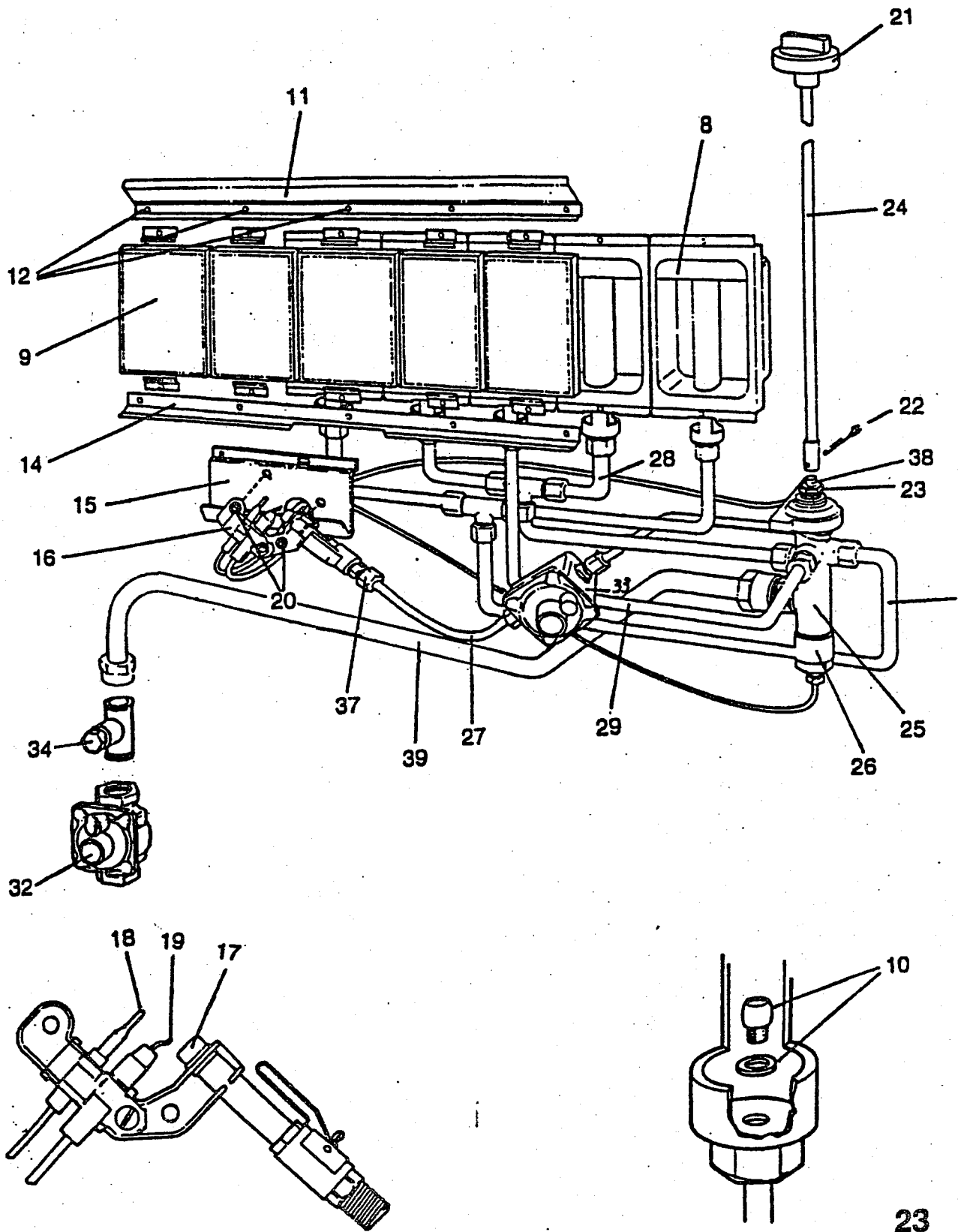

MODEL NO.: FB-5

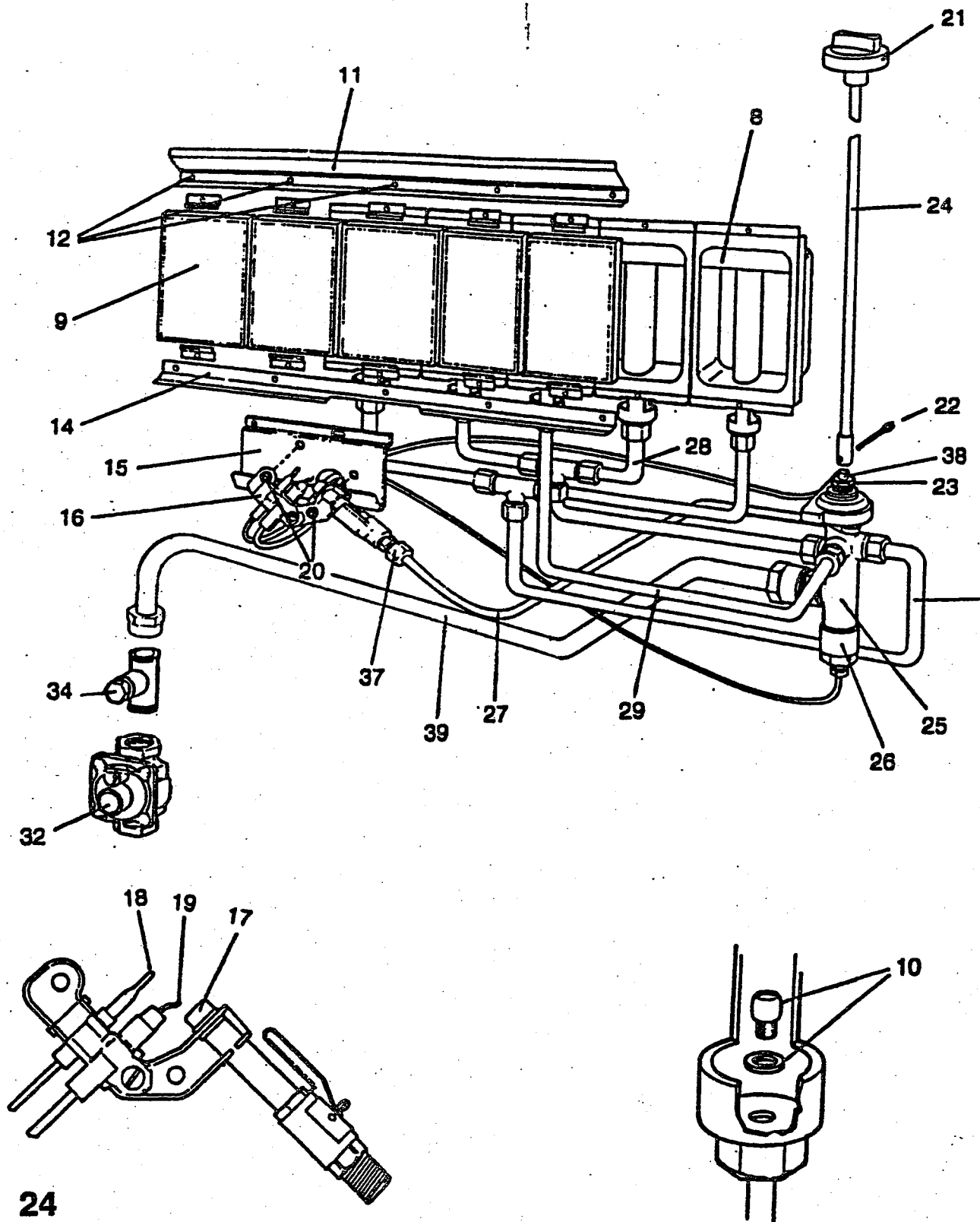

Model No. : FAS-3, FBS-3
FAS-5, FBS-5

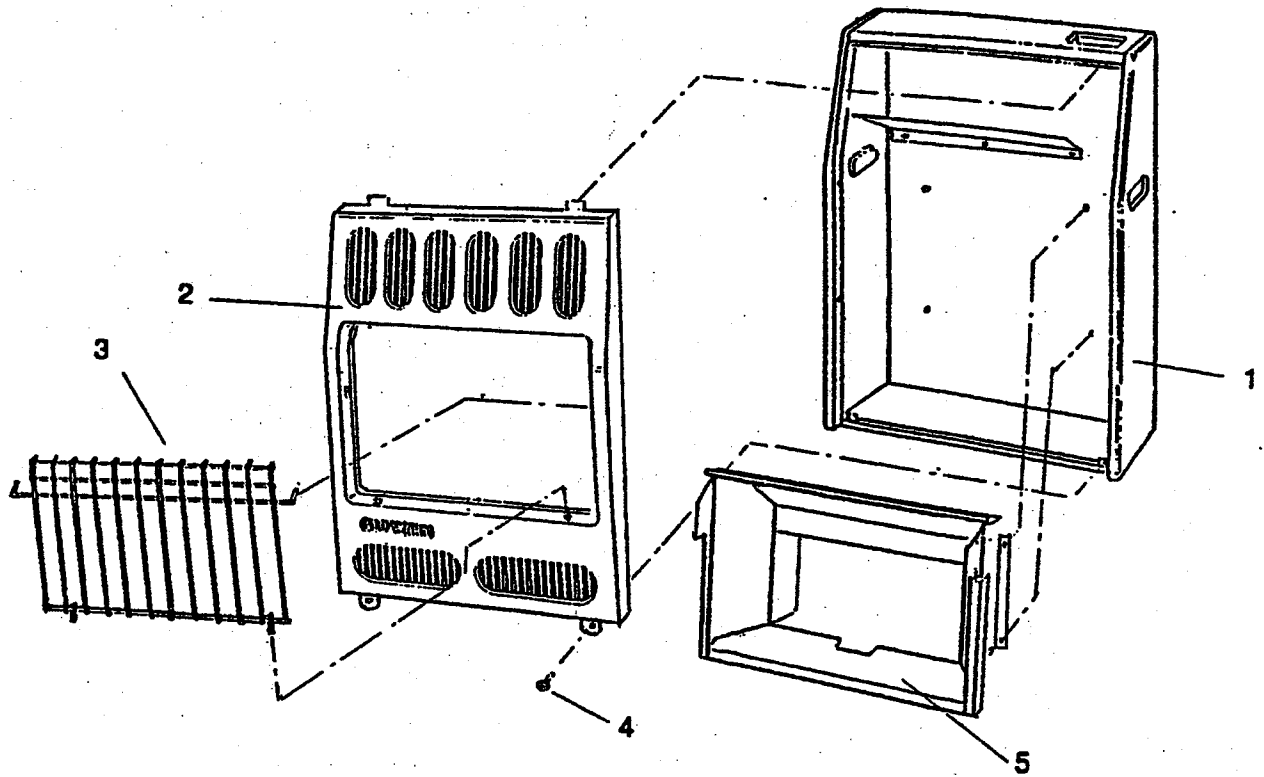

Model No. : FAS-3

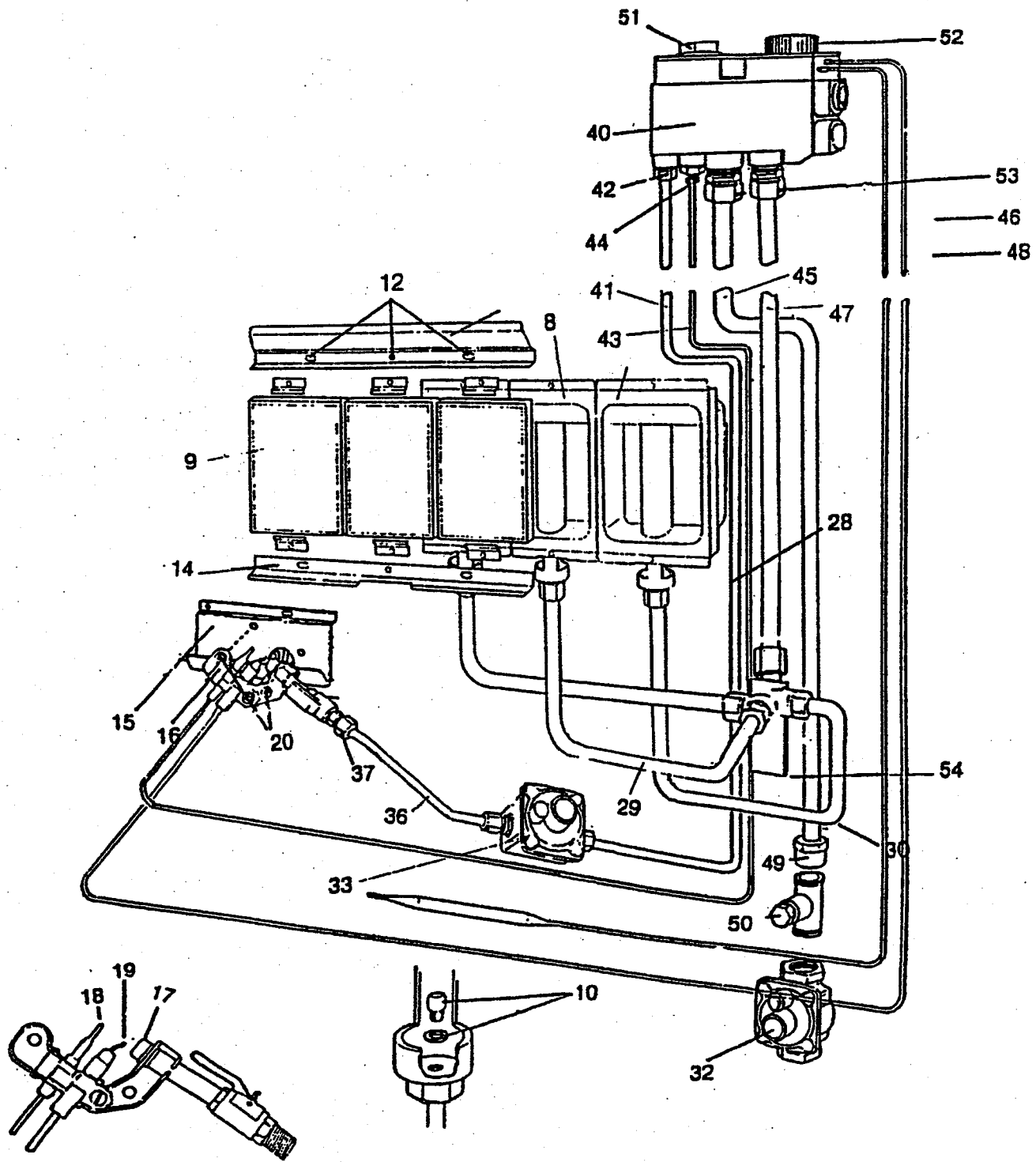

Model No. : FBS-3

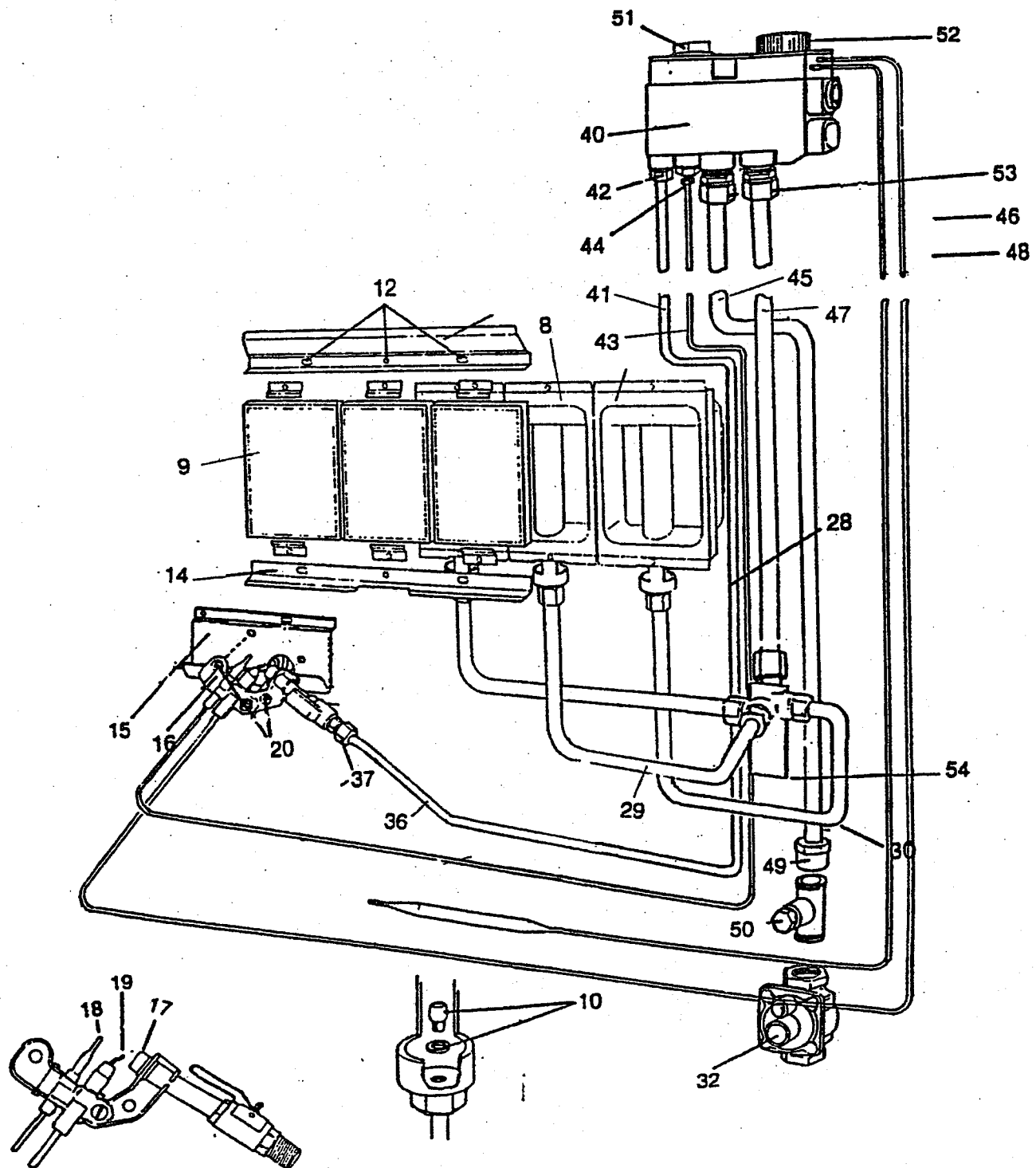

MODEL NO.: FBS-5

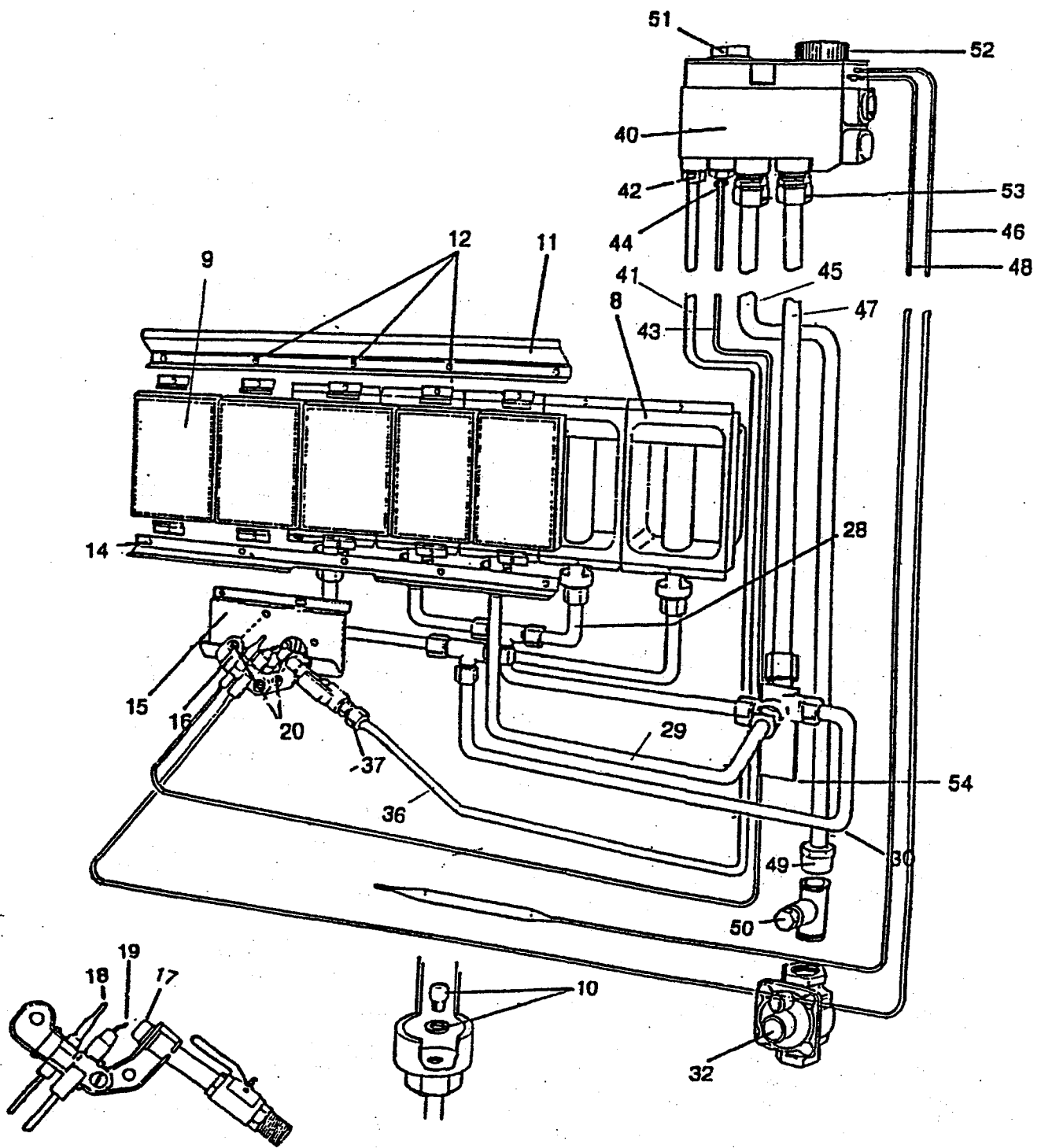

MODEL NO.: FAS-5

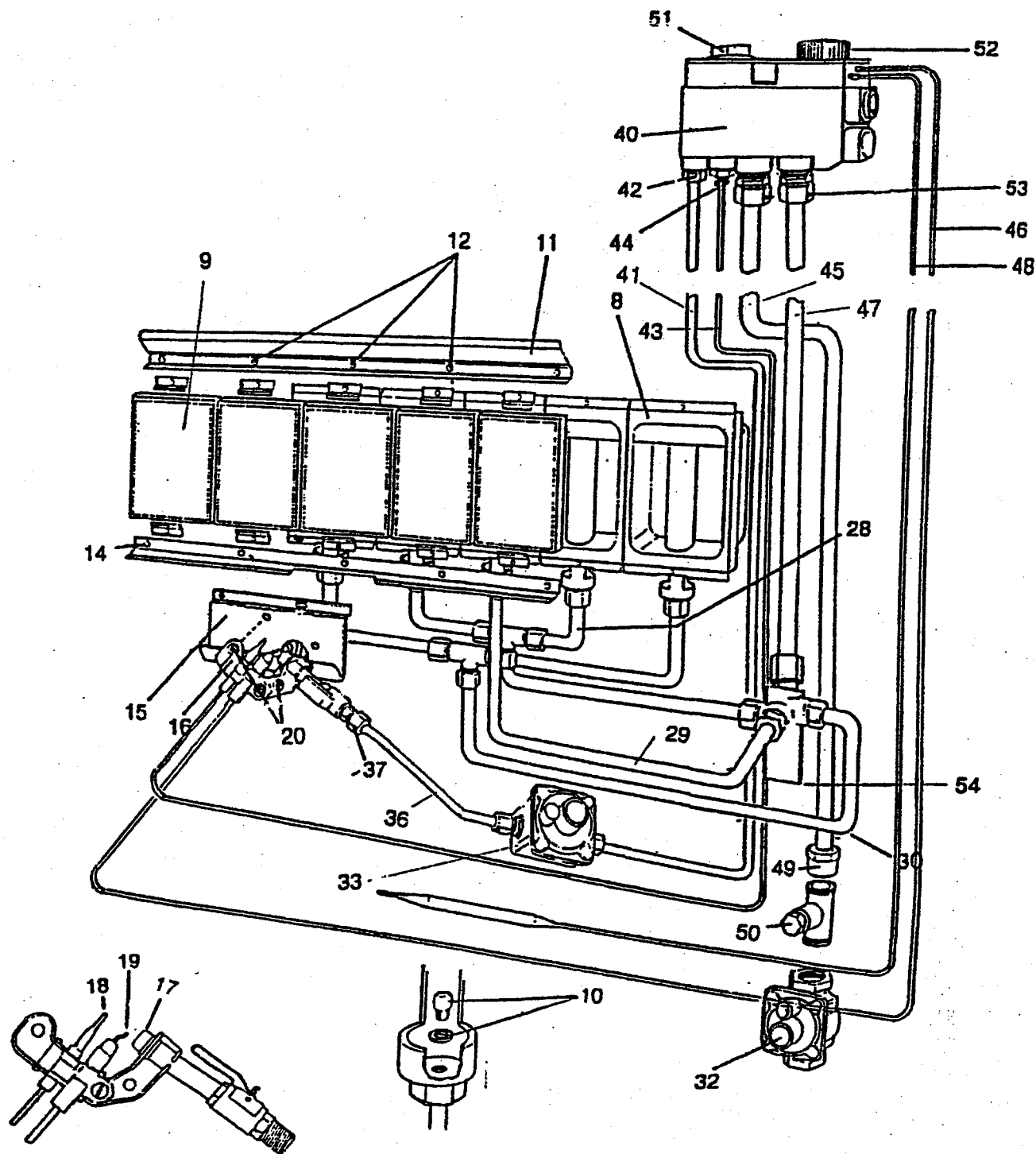

PARTS LIST

ITEM NO.	PARTS NO.	DESCRIPTION
1.	98003	Cabinet
	98004	Cabinet
2.	98004	Cabinet
3.	980075	Screw o4X10
4.		
5.	980075	Screw o4X10
6.	98012	Reflector unit
	98013	Reflector unit
	98014	Reflector unit
	98015	Reflector unit
7.	98010	Safety guard unit
8.	98017	Burner box
9.	98018	Ceramic, radiant plaque
10.	98023	Orifice
	98024	Washer
11.	98025	Upper burner deflector
12.	980075	Screw o4 X10
13.	98041	Pipe assembly-valve to left hand radiant
14.	98026	Lower burner trim plate
15.	98072	Pilot unit mounting bracket
16.	98071	Pilot and ignition unit
17.	98071	O.D.S. unit
18.	98071	Thermocouple
19.	98071	Ignition
20.	98075	Screw o4 X 10
21.	98061	Control Knob
22.	98064	Split fixing pine
23.	98024	Washer
24.	98062	Control shift unit
25.	98034	Gas control valve
26.	98034	Safety switch
27.	98052	Pipe assembly pilot to valve
28.	98043	Valve to radiant 2 to 4
29.	98044	Valve to central radiant
30.	98040	Valve to radiant 1 to 5
31.	98046	Valve to right hand radiant
32.	98029	Pressure regulator
33.	98029	Low pressure regulator valve to pilot
34.	98030	Pressure tap fitting
35.	98052	Gas inlet connection elbow
36.	98053	Pipe assembly-pilot regulator

37.	98039	Coupling
38.	98033	Locknut
39.	98060	Pipe assembly, regulator to valve
40.	98065	Thermostat gas valve
41.	98051	Pilot tubing
42.	98069	Connector
43.	98071	Thermocouple wire
44.	98071	Safety switch and fitting
45.	98060	Gas main inlet tube
46.	98065	Ignite pizeo wire
47.	98070	Tube connect gas valve
48.	98065	Thermostat sensor wire
49.	98033	Inlet fitting
50.	98030	Pressure tap fitting
51.	98065	Ignite knob
52.	98065	Temperature setting knob
53.	98033	Locknut
54.	98034	Elbow connector and locknut